

F.A.P. RTE.	SECTION	COUNTY	TOTAL SHEETS	SHEET NO.
575	(B&14) R-3	WILL	390	66
STA. 768+00		TO STA. 773+99.76		
FED. ROAD DIST. NO.		ILLINOIS FED. AID PROJECT		
CONTRACT NO. 60961				

LEGEND	
	BITUMINOUS SURFACE REMOVAL
	AGG. SHOULDER AND AGG. DRIVEWAY REMOVAL
	PAVEMENT REMOVAL
	PAVED SHOULDER REMOVAL
	DRIVEWAY PAVEMENT AND SIDEWALK REMOVAL
	RAISED REFLECTIVE PAVEMENT MARKER REMOVAL
	STRUCTURE TO BE REMOVED
	ITEM TO BE REMOVED
	ITEM TO BE RELOCATED
	STORM SEWER REMOVAL

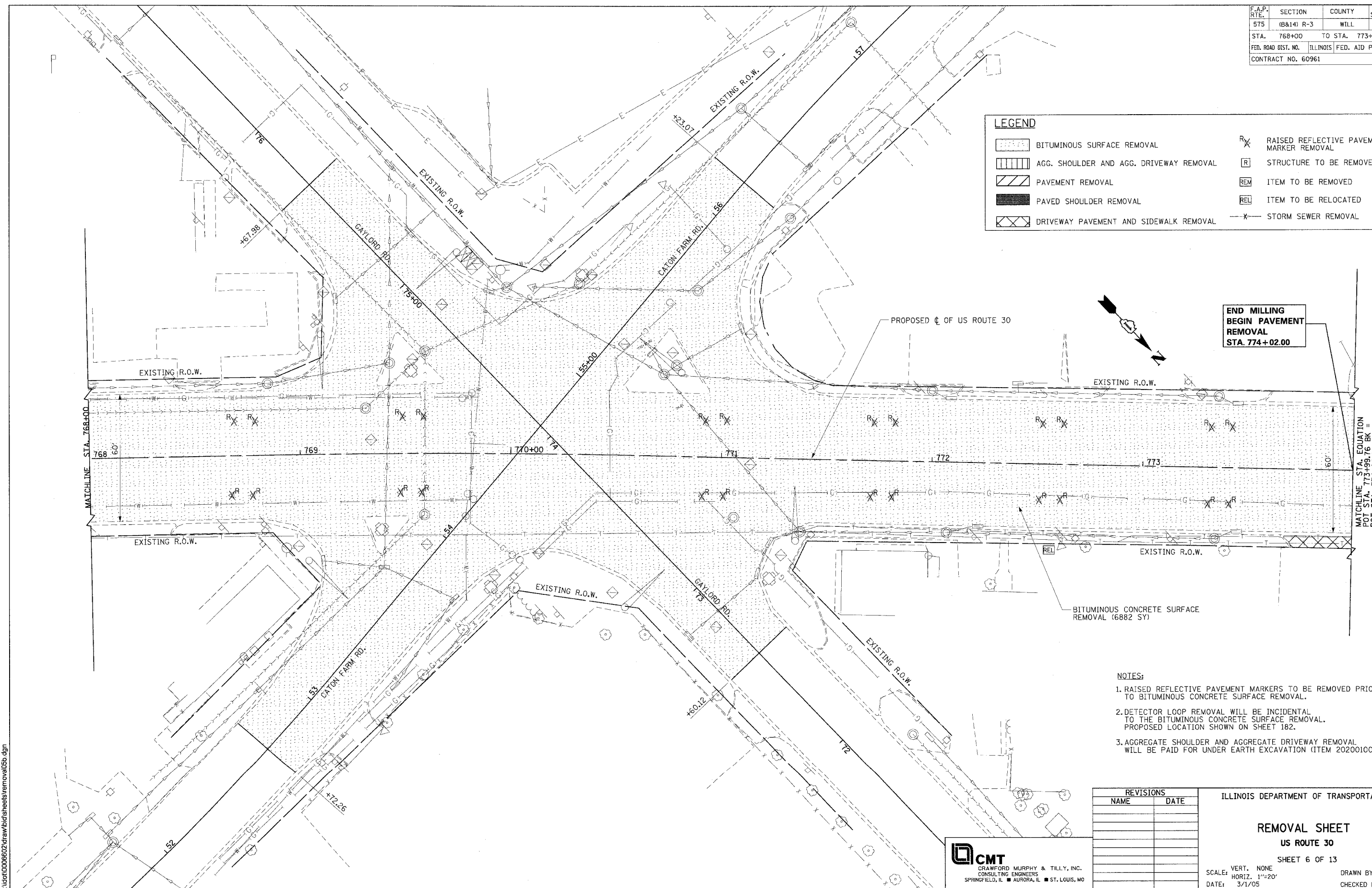

**END MILLING
BEGIN PAVEMENT
REMOVAL
STA. 774+02.00**

- NOTES:**
1. RAISED REFLECTIVE PAVEMENT MARKERS TO BE REMOVED PRIOR TO BITUMINOUS CONCRETE SURFACE REMOVAL.
 2. DETECTOR LOOP REMOVAL WILL BE INCIDENTAL TO THE BITUMINOUS CONCRETE SURFACE REMOVAL. PROPOSED LOCATION SHOWN ON SHEET 182.
 3. AGGREGATE SHOULDER AND AGGREGATE DRIVEWAY REMOVAL WILL BE PAID FOR UNDER EARTH EXCAVATION (ITEM 20200100).

REVISIONS	
NAME	DATE

ILLINOIS DEPARTMENT OF TRANSPORTATION

**REMOVAL SHEET
US ROUTE 30
SHEET 6 OF 13**

CMT
CRAWFORD MURPHY & TILLY, INC.
CONSULTING ENGINEERS
SPRINGFIELD, IL ■ AURORA, IL ■ ST. LOUIS, MO

SCALE: VERT. NONE
HORIZ. 1"=20'
DATE: 3/1/05
DRAWN BY: SNH
CHECKED BY: KDF

I:\dot\0006602\draw\bid\sheet\removal\5b.dgn