

F.A.P. RTE.	SECTION	COUNTY	TOTAL SHEETS	SHEET NO.
575	(B&I4) R-3	WILL	390	67
STA.	774+00	TO STA.	786+00	
FED. ROAD DIST. NO.	ILLINOIS FED. AID PROJECT			
CONTRACT NO. 60961				

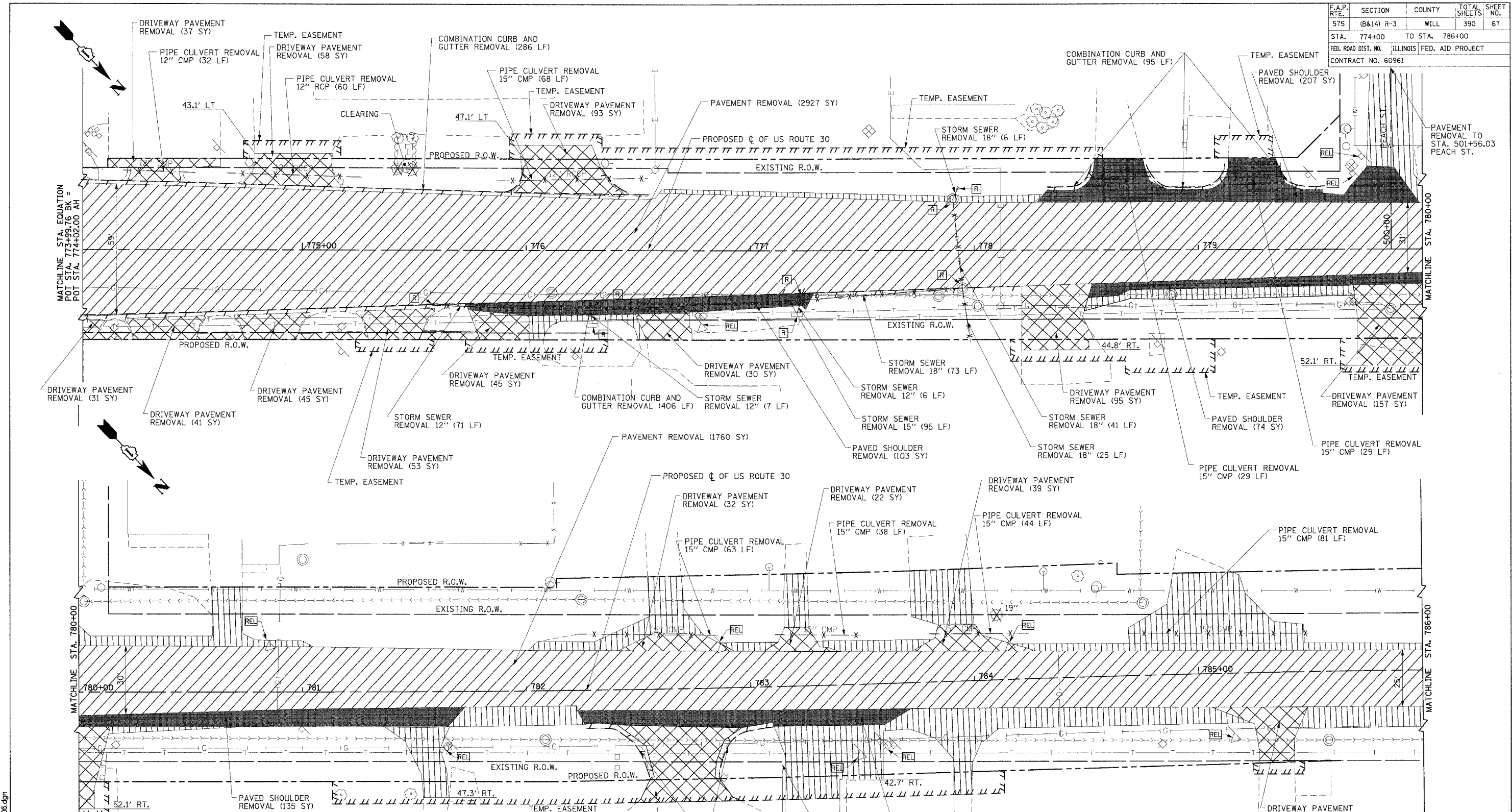

LEGEND	
	BITUMINOUS SURFACE REMOVAL
	AGG. SHOULDER AND AGG. DRIVEWAY REMOVAL
	PAVEMENT REMOVAL
	PAVED SHOULDER REMOVAL
	DRIVEWAY PAVEMENT AND SIDEWALK REMOVAL
	RAISED REFLECTIVE PAVEMENT MARKER REMOVAL
	STRUCTURE TO BE REMOVED
	ITEM TO BE REMOVED
	ITEM TO BE RELOCATED
	STORM SEWER REMOVAL

**NOTES:**

- REFER TO CORRESPONDING PLAN & PROFILE SHEETS FOR SIDE STREET LIMITS OF CONSTRUCTION.
- AGGREGATE SHOULDER AND AGGREGATE DRIVEWAY REMOVAL WILL BE PAID FOR UNDER EARTH EXCAVATION (ITEM 20200100).
- TREE REMOVALS SHOWN WITHOUT DIMENSIONS SHALL BE CONSIDERED CLEARING.

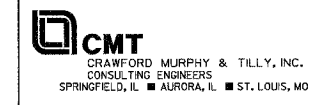

REVISIONS	
NAME	DATE

ILLINOIS DEPARTMENT OF TRANSPORTATION  
**REMOVAL SHEET**  
**US ROUTE 30**  
 SHEET 7 OF 13

SCALE: VERT. NONE  
 HORIZ. 1"=20'  
 DATE: 3/1/05

DRAWN BY: SMH  
 CHECKED BY: KDF

I:\work\006602\draw\bid\sheet\removal06.dgn