

F.A.P. RTE.	SECTION	COUNTY	TOTAL SHEET SHEETS	NO.
575	(B&I4) R-3	WILL	390	73
STA. 834+00	TO STA. 847+00			
FED. ROAD DIST. NO.	ILLINOIS	FED. AID PROJECT		
CONTRACT NO. 60961				

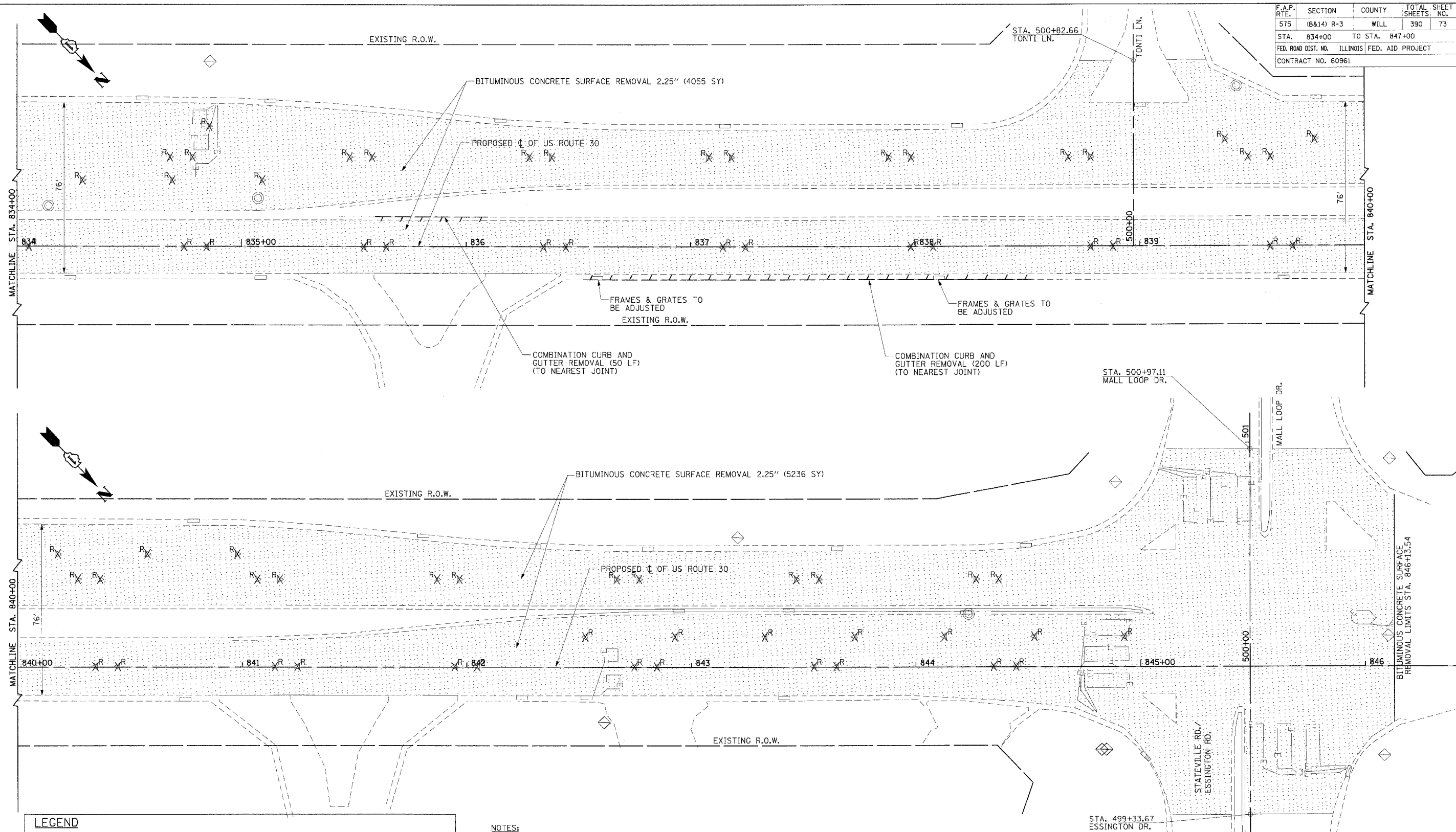

LEGEND	
	BITUMINOUS SURFACE REMOVAL
	AGG. SHOULDER AND AGG. DRIVEWAY REMOVAL
	PAVEMENT REMOVAL
	PAVED SHOULDER REMOVAL
	DRIVEWAY PAVEMENT AND SIDEWALK REMOVAL
	RAISED REFLECTIVE PAVEMENT MARKER REMOVAL
	STRUCTURE TO BE REMOVED
	ITEM TO BE REMOVED
	ITEM TO BE RELOCATED
	STORM SEWER REMOVAL

**NOTES:**

1. RAISED REFLECTIVE PAVEMENT MARKERS TO BE REMOVED PRIOR TO BITUMINOUS CONCRETE SURFACE REMOVAL.
2. DETECTOR LOOP REMOVAL WILL BE INCIDENTAL TO THE BITUMINOUS CONCRETE SURFACE REMOVAL. PROPOSED LOCATIONS SHOWN ON SHEET 185.

REVISIONS	
NAME	DATE

**CMT**  
 CRAWFORD MURPHY & TILLY, INC.  
 CONSULTING ENGINEERS  
 SPRINGFIELD, IL ■ AURORA, IL ■ ST. LOUIS, MO

ILLINOIS DEPARTMENT OF TRANSPORTATION  
**REMOVAL SHEET**  
 US ROUTE 30  
 SHEET 13 OF 13

SCALE: VERT. NONE  
 HORIZ. 1"=20'  
 DATE: 3/1/05

DRAWN BY: SNH  
 CHECKED BY: KDF

I:\dot00602\draw\dot00602\sheet\removal11.dgn