

F.A.P. RTE.	SECTION	COUNTY	TOTAL SHEETS	SHEET NO.
575	(B&I4) R-3	WILL	390	76
STA. 728+00 TO STA. 734+00				
FED. ROAD DIST. NO.		ILLINOIS FED. AID PROJECT		
CONTRACT NO. 60961				

PLAN	REVISIONS	DATE
NOTED		
ALIGNED		
CHECKED		
DATE PLOTTED		
BY		
NO.		

PROFILE	REVISIONS	DATE
NOTED		
GRADES		
CHECKED		
DATE PLOTTED		
BY		
NO.		

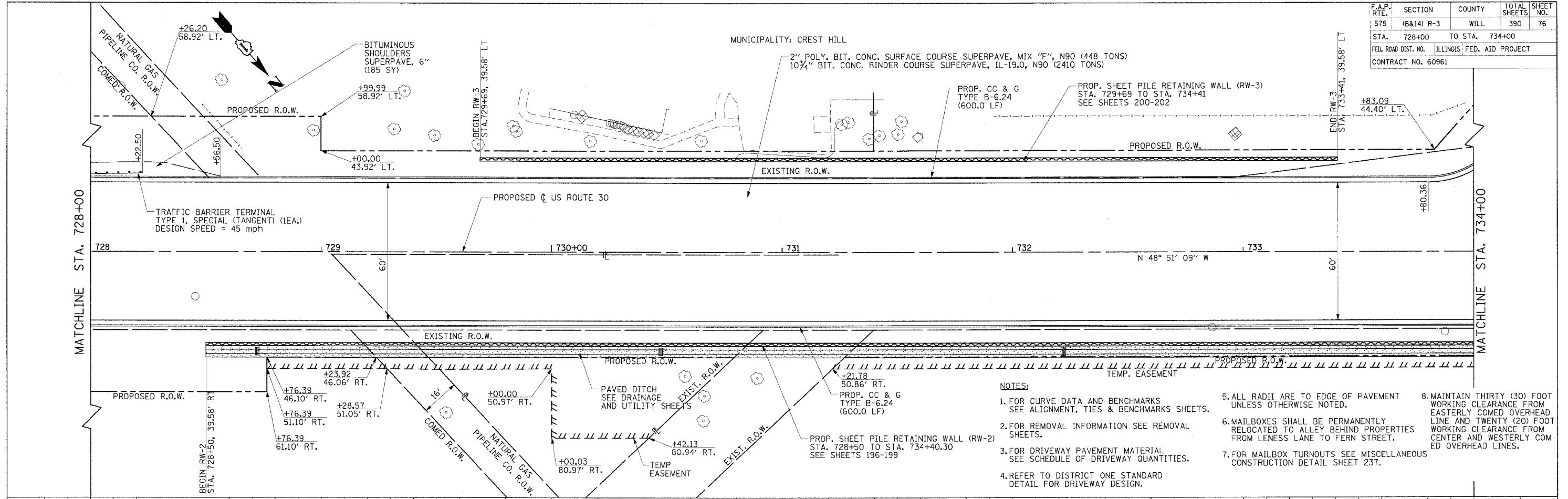

- NOTES:**
- FOR CURVE DATA AND BENCHMARKS SEE ALIGNMENT, TIES & BENCHMARKS SHEETS.
 - FOR REMOVAL INFORMATION SEE REMOVAL SHEETS.
 - FOR DRIVEWAY PAVEMENT MATERIAL SEE SCHEDULE OF DRIVEWAY QUANTITIES.
 - REFER TO DISTRICT ONE STANDARD DETAIL FOR DRIVEWAY DESIGN.
 - ALL RADII ARE TO EDGE OF PAVEMENT UNLESS OTHERWISE NOTED.
 - MAILBOXES SHALL BE PERMANENTLY RELOCATED TO ALLEY BEHIND PROPERTIES FROM LENESS LANE TO FERN STREET.
 - FOR MAILBOX TURNOUTS SEE MISCELLANEOUS CONSTRUCTION DETAIL SHEET 237.
 - MAINTAIN THIRTY (30) FOOT WORKING CLEARANCE FROM EASTERLY COMED OVERHEAD LINE AND TWENTY (20) FOOT WORKING CLEARANCE FROM CENTER AND WESTERLY COMED OVERHEAD LINES.

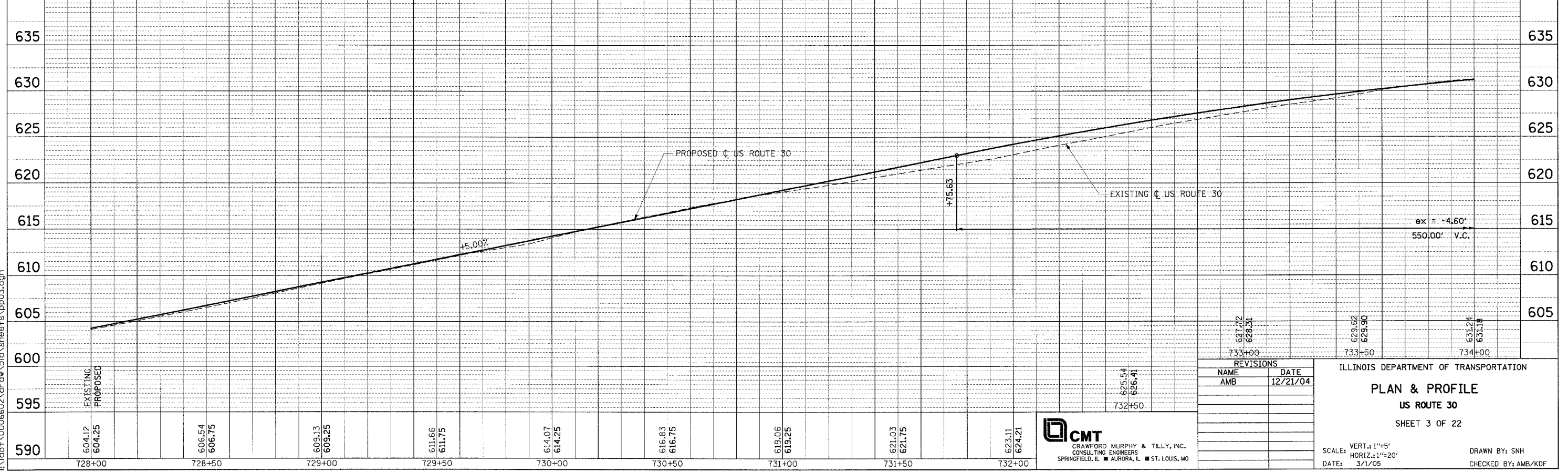

REVISIONS	
NAME	DATE
AMB	12/21/04

ILLINOIS DEPARTMENT OF TRANSPORTATION
PLAN & PROFILE
 US ROUTE 30
 SHEET 3 OF 22

SCALE: VERT. 1"=5'
 HORIZ. 1"=20'
 DATE: 3/1/05

DRAWN BY: SNH
 CHECKED BY: AMB/KDF



I:\dot\0006602.dwg\bid\sheet3\pp03.dgn