

PLAN	DATE
DESIGNED	
REVIEWED	
ALIGNED	
PLOTTED	
NOTE BOOK	
NO.	
FILE NAME	

PROFILE	DATE
DESIGNED	
REVIEWED	
GRADED	
STRUCTURE	
NOTATION	
NO.	

I:\dot\0006602\_drawing\sheet\pp06.dgn

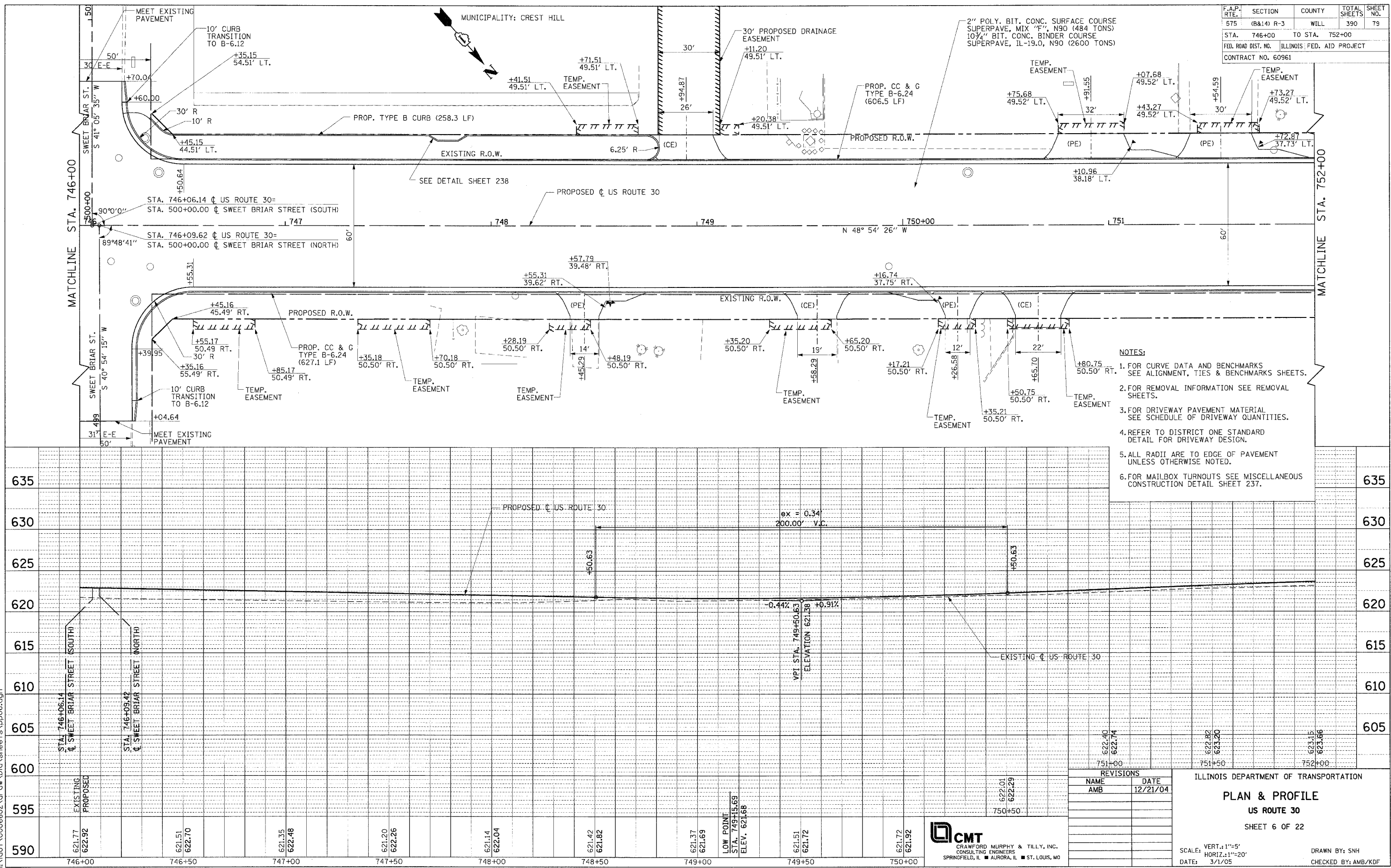

F.A.P. RTE.	SECTION	COUNTY	TOTAL SHEETS	SHEET NO.
575	(B&I) R-3	WILL	390	79
STA.	746+00	TO STA.	752+00	
FED. ROAD DIST. NO.	ILLINOIS FED. AID PROJECT			
CONTRACT NO. 60961				

- NOTES:**
- FOR CURVE DATA AND BENCHMARKS SEE ALIGNMENT, TIES & BENCHMARKS SHEETS.
  - FOR REMOVAL INFORMATION SEE REMOVAL SHEETS.
  - FOR DRIVEWAY PAVEMENT MATERIAL SEE SCHEDULE OF DRIVEWAY QUANTITIES.
  - REFER TO DISTRICT ONE STANDARD DETAIL FOR DRIVEWAY DESIGN.
  - ALL RADII ARE TO EDGE OF PAVEMENT UNLESS OTHERWISE NOTED.
  - FOR MAILBOX TURNOUTS SEE MISCELLANEOUS CONSTRUCTION DETAIL SHEET 237.

REVISIONS	
NAME	DATE
AMB	12/21/04

ILLINOIS DEPARTMENT OF TRANSPORTATION  
**PLAN & PROFILE**  
**US ROUTE 30**  
 SHEET 6 OF 22

SCALE: VERT.: 1"=5'  
 HORIZ.: 1"=20'  
 DATE: 3/1/05

DRAWN BY: SNH  
 CHECKED BY: AMB/KDF

**CMT**  
 CRAWFORD MURPHY & TILLY, INC.  
 CONSULTING ENGINEERS  
 SPRINGFIELD, IL ■ AURORA, IL ■ ST. LOUIS, MO