

PLAN	DESIGNED	BY	DATE
NO. 1	PLOTTED		
NO. 2	CHECKED		
NO. 3	REVISION		
NO. 4	DATE		

PROF. FILE	REVISED	BY	DATE
NO. 1	CHECKED		
NO. 2	REVISION		
NO. 3	DATE		

H:\dot\0006602\draw\bid\sheet\sp22.dgn

- NOTES:**
- FOR CURVE DATA AND BENCHMARKS SEE ALIGNMENT, TIES & BENCHMARKS SHEETS.
 - RIGHT OF WAY FROM STA. 816+66.78 TO 846+13.54 WAS RECREATED GRAPHICALLY & SHOULD BE VERIFIED.

MUNICIPALITY: JOLIET

F.A.P. RTE.	SECTION	COUNTY	TOTAL SHEET NO.
575	(B&I4) R-3	WILL	390 95
STA. 840+00	TO STA. 846+13.54		
FED. ROAD DIST. NO.	ILLINOIS	FED. AID PROJECT	
CONTRACT NO. 60961			

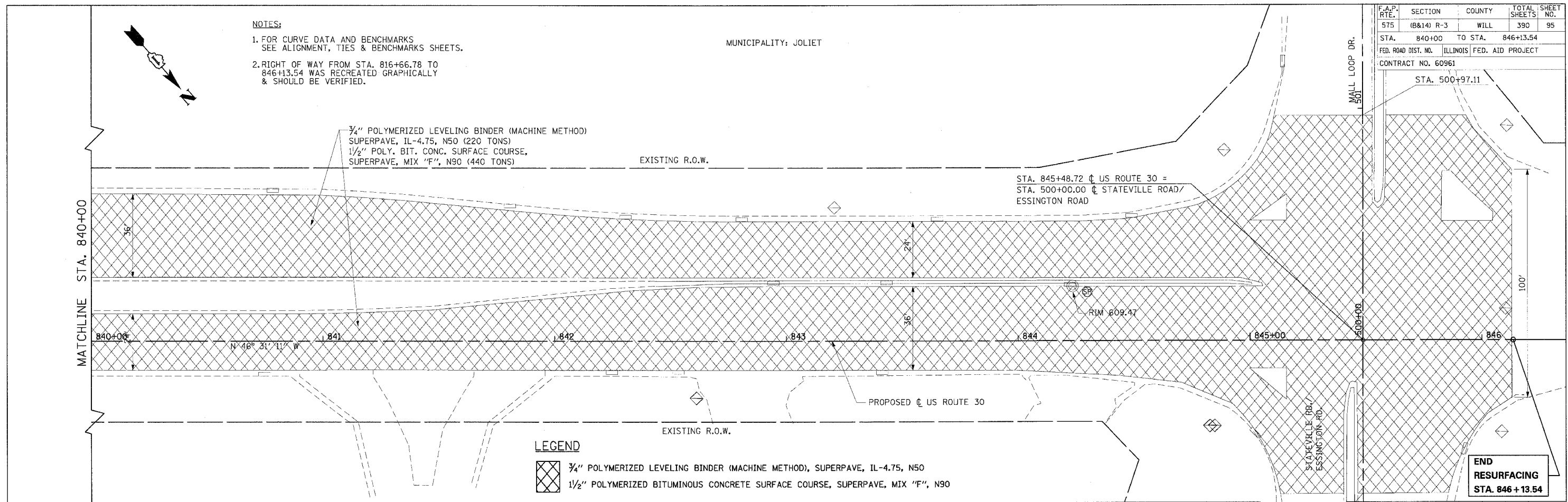

LEGEND

- 3/4" POLYMERIZED LEVELING BINDER (MACHINE METHOD), SUPERPAVE, IL-4.75, N50
- 1/2" POLYMERIZED BITUMINOUS CONCRETE SURFACE COURSE, SUPERPAVE, MIX "F", N90

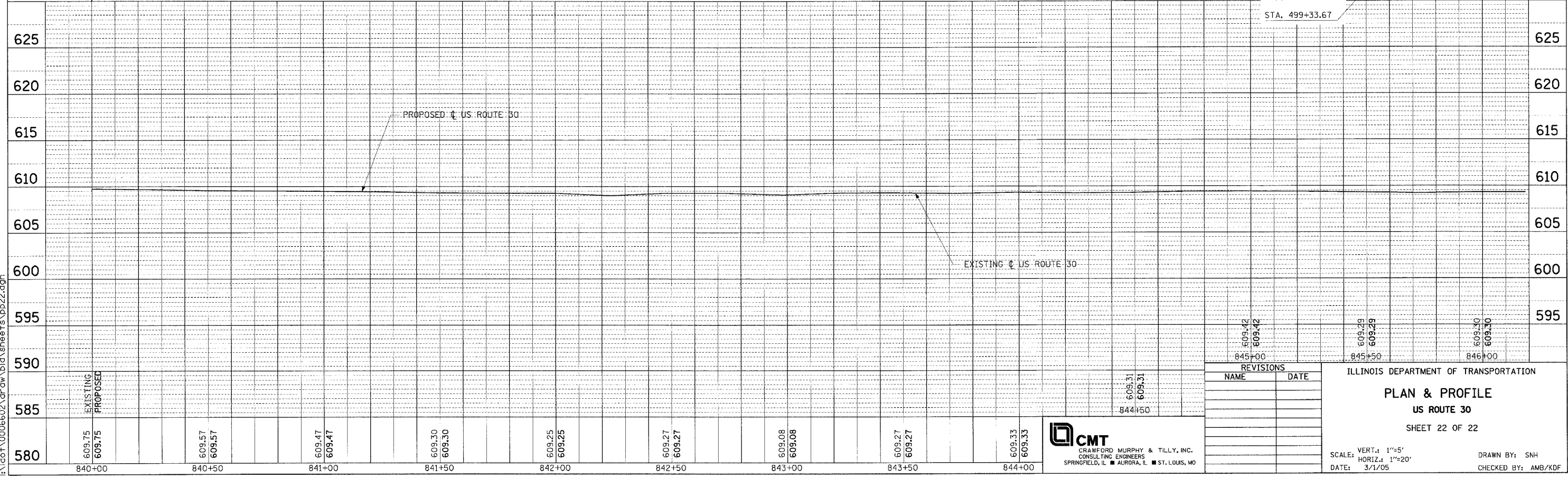

REVISIONS	
NAME	DATE

ILLINOIS DEPARTMENT OF TRANSPORTATION

PLAN & PROFILE

US ROUTE 30

SHEET 22 OF 22

SCALE: VERT.: 1"=5'
HORIZ.: 1"=20'

DATE: 3/1/05

DRAWN BY: SNH
CHECKED BY: AMB/KDF

CMT
CRAWFORD MURPHY & TILLY, INC.
CONSULTING ENGINEERS
SPRINGFIELD, IL ■ AURORA, IL ■ ST. LOUIS, MO