

F.A. RTE.	SECTION	COUNTY	TOTAL SHEETS	SHEET NO.
575	(B&14) R-3	WILL	390	180
STA. 760+00		TO STA. 805+00		
FED. ROAD DIST. NO.		ILLINOIS FED. AID PROJECT		
CONTRACT NO. 60961				

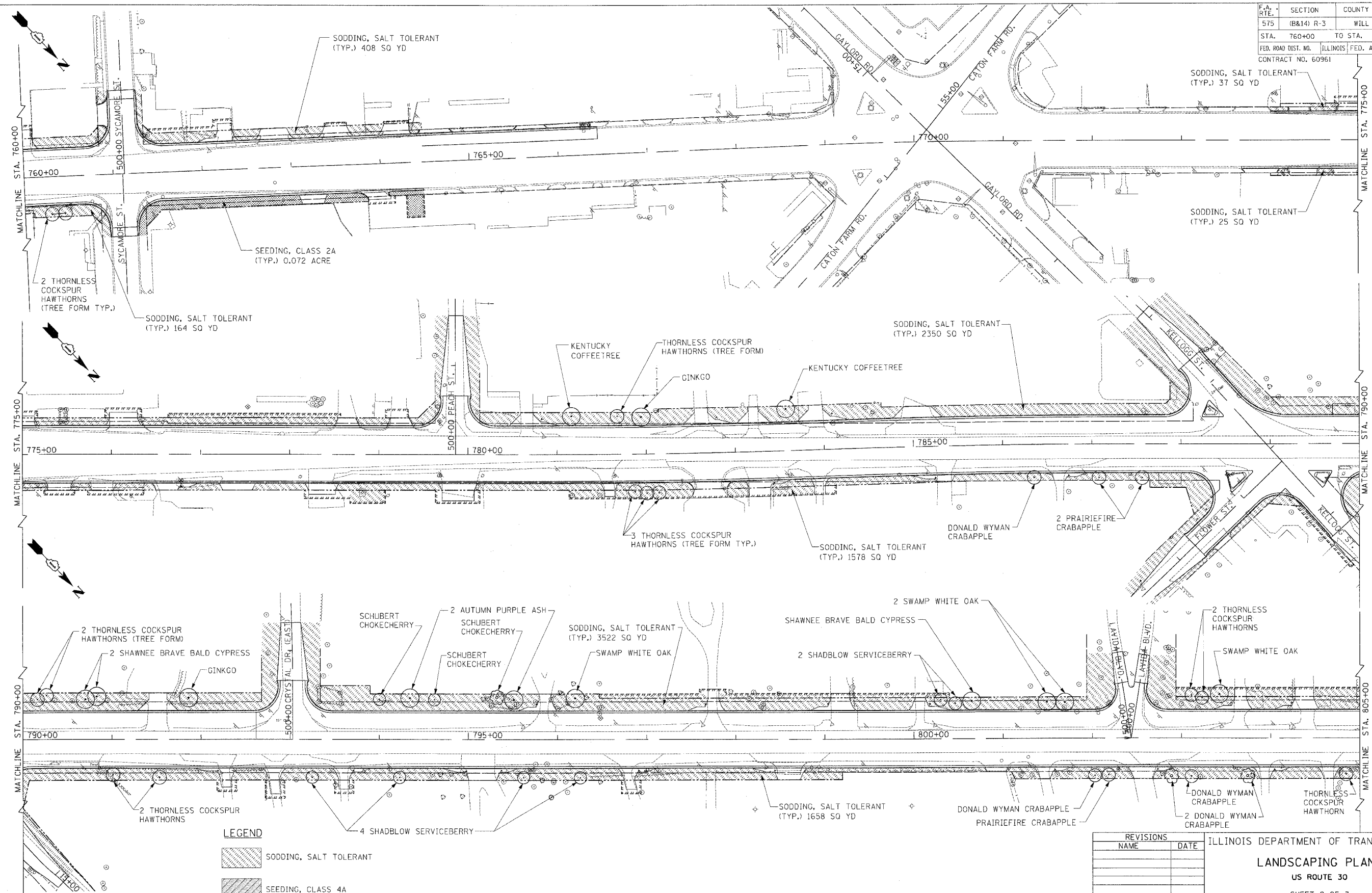

LEGEND

	SODDING, SALT TOLERANT
	SEEDING, CLASS 4A
	SEEDING, CLASS 2A

NOTE:
ALL PLANTS MULCHED TOGETHER IN ONE CONTINUOUS BED

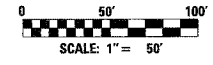

K&E KAM ENGINEERING, INC.
CONSULTING ENGINEERS
707A Davis Road, Suite 205
Elgin, Illinois 60123-1569

REVISIONS	
NAME	DATE

ILLINOIS DEPARTMENT OF TRANSPORTATION
LANDSCAPING PLAN
US ROUTE 30
SHEET 2 OF 3
SCALE: 1"=50'
DATE: MARCH 2005
DRAWN BY: MD
CHECKED BY: MSA

FILES \$
DATES \$