

F.A.P. RTE. 575	SECTION (B&14) R-3	COUNTY WILL	TOTAL SHEETS 390	SHEET NO. 197
STA. TO STA.		ILLINOIS FED. AID PROJECT		
FED. ROAD DIST. NO.		CONTRACT NO. 60961		

Sheet 12 of 25

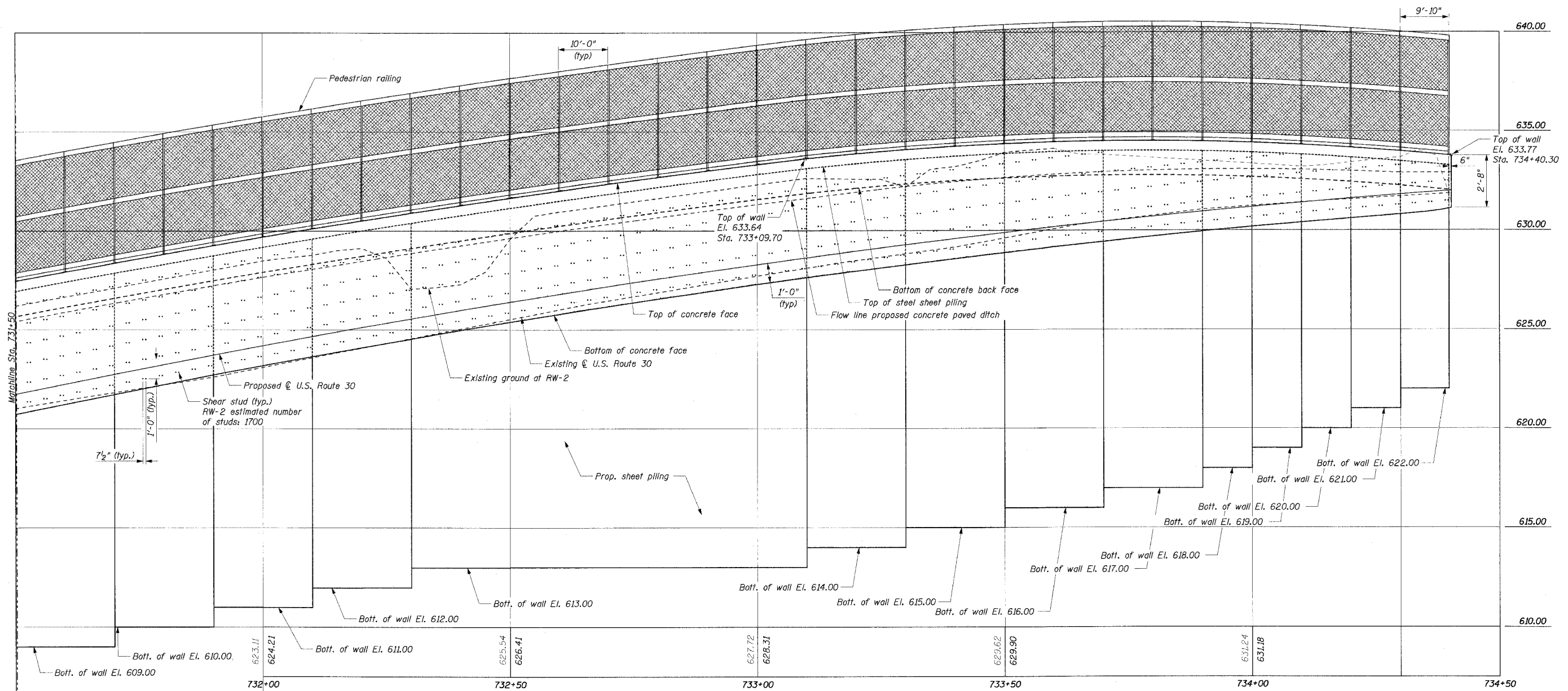
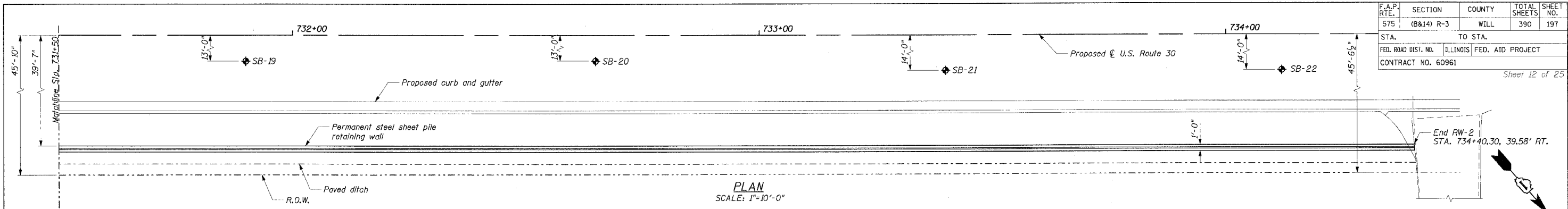

ELEVATION
SCALE: 1"=10'-0" HORZ.
1"=2'-6" VERT.

NOTES:
1. Control joints shall be formed at thin wall sections and spaced at 25'-0". See sheet 18 of 25 for typical detail.

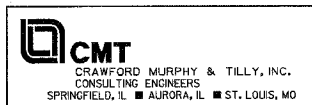

REVISIONS	
NAME	DATE

ILLINOIS DEPARTMENT OF TRANSPORTATION
RW-2 GENERAL PLAN & ELEVATION II

FAP RTE. 575 (U.S.30)
SECTION (B & 14) R-3
WILL COUNTY

SCALE: VERT. AS SHOWN
HORIZ. DATE: 3/1/05
DRAWN BY: GRS
CHECKED BY: ATI

I:\data\0006602\draw\other\retaining walls\profile_rw-2b.dgn