

F.A. RTE.	SECTION	COUNTY	TOTAL SHEETS	SHEET NO.
575	(B+14) R-3	WILL	390	265
STA.		TO STA.		
FED. ROAD DIST. NO.		ILLINOIS FED. AID PROJECT		
CONTRACT NO. 60961				

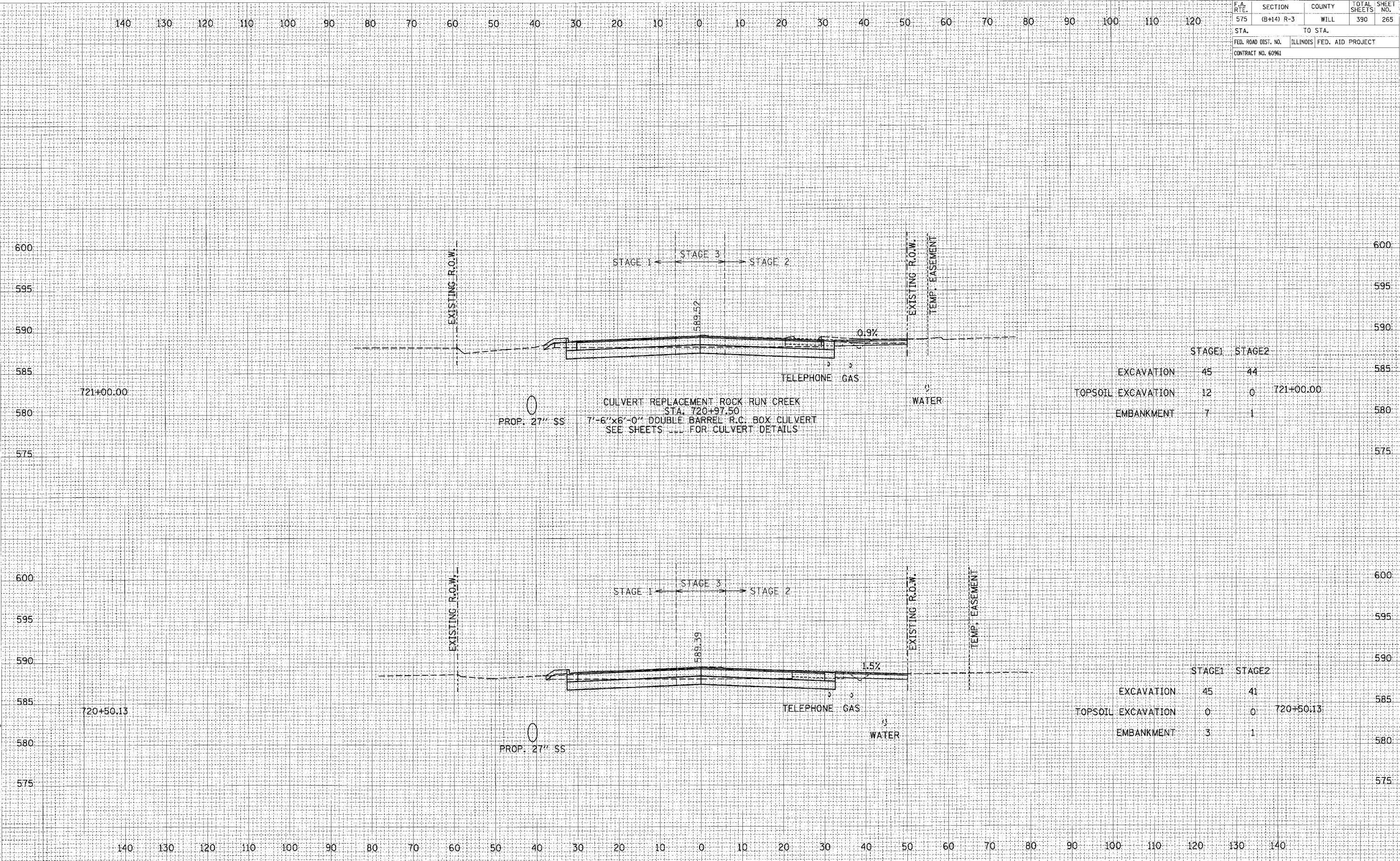

	STAGE1	STAGE2	
EXCAVATION	45	44	585
TOPSOIL EXCAVATION	12	0	721+00.00
EMBANKMENT	7	1	580

	STAGE1	STAGE2	
EXCAVATION	45	41	585
TOPSOIL EXCAVATION	0	0	720+50.13
EMBANKMENT	3	1	580

CROSS SECTIONS: U.S. ROUTE 30 - STA. 720+50.13 TO STA. 721+00.00
 SCALE: 1" = 10' HORIZ.
 1" = 5' VERT.

DATE
 BY
 CHECKED
 SURVEY
 PLOTTED
 NOTE BOOK
 AREAS CHECKED

DATE
 BY
 CHECKED
 SURVEY
 PLOTTED
 NOTE BOOK
 AREAS CHECKED

F:\dot\0006607\dr\aw\bid\sheet1a vs30.dgn