

F.A. RTE.	SECTION	COUNTY	TOTAL SHEETS	SHEET NO.
575	(B+14) R-3	WILL	390	270
STA.		TO STA.		
FED. ROAD DIST. NO.		ILLINOIS FED. AID PROJECT		
CONTRACT NO. 60961				

DATE	BY

DATE	BY

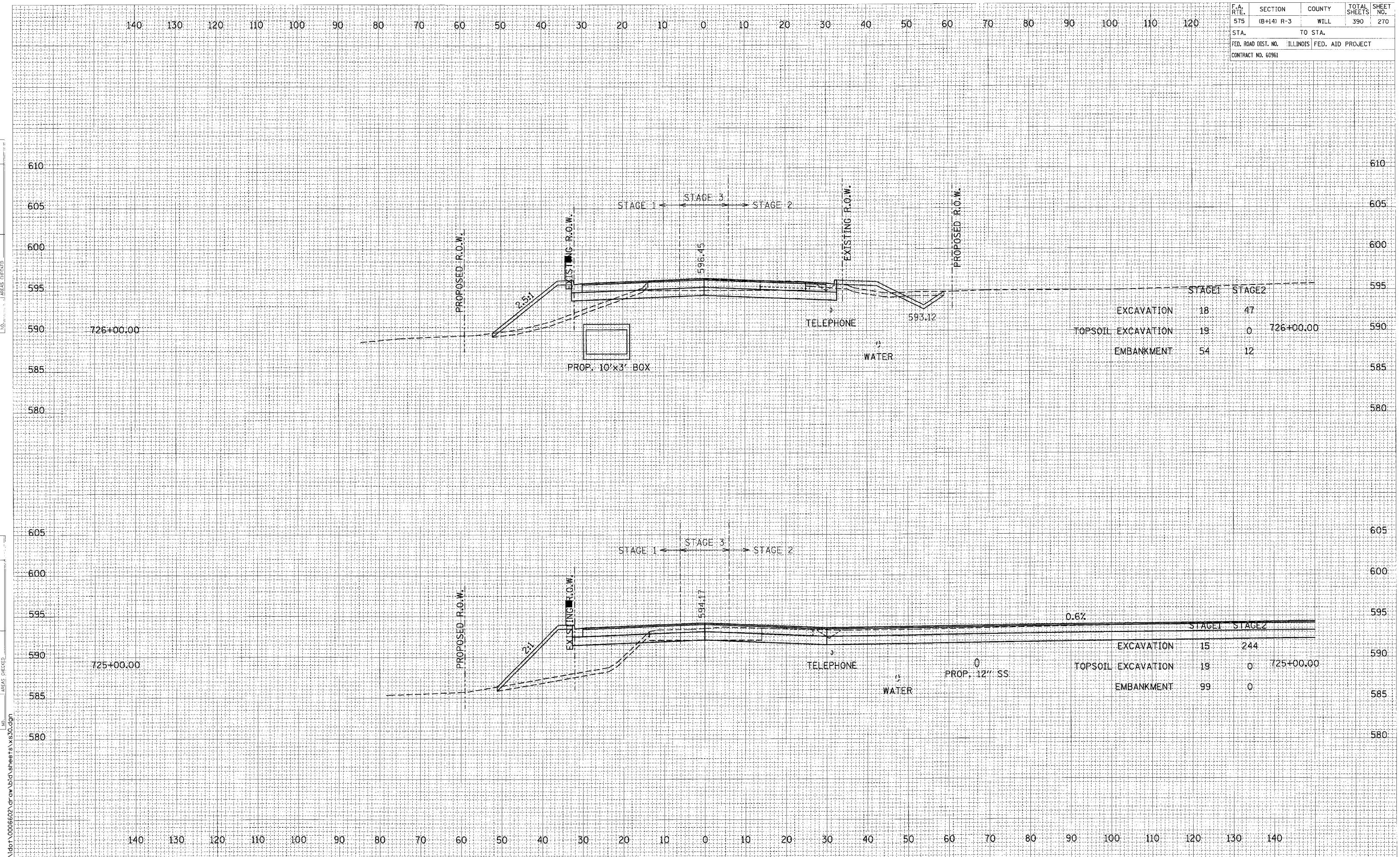

	STAGE 1	STAGE 2	
EXCAVATION	18	47	
TOPSOIL EXCAVATION	19	0	726+00.00
EMBANKMENT	54	12	

	STAGE 1	STAGE 2	
EXCAVATION	15	244	
TOPSOIL EXCAVATION	19	0	725+00.00
EMBANKMENT	99	0	

CROSS SECTIONS: U.S. ROUTE 30 - STA. 725+00.00 TO STA. 726+00.00

SCALE: 1" = 10' HORIZ.
1" = 5' VERT.

I:\dot\0006602\draw\bid\sheet\X1830.dgn