

F.A. RTE.	SECTION	COUNTY	TOTAL SHEETS	SHEET NO.
575	(B+14) R-3	WILL	390	274
STA.	TO STA.			
FED. ROAD DIST. NO.	ILLINOIS	FED. AID PROJECT		
CONTRACT NO. 60961				

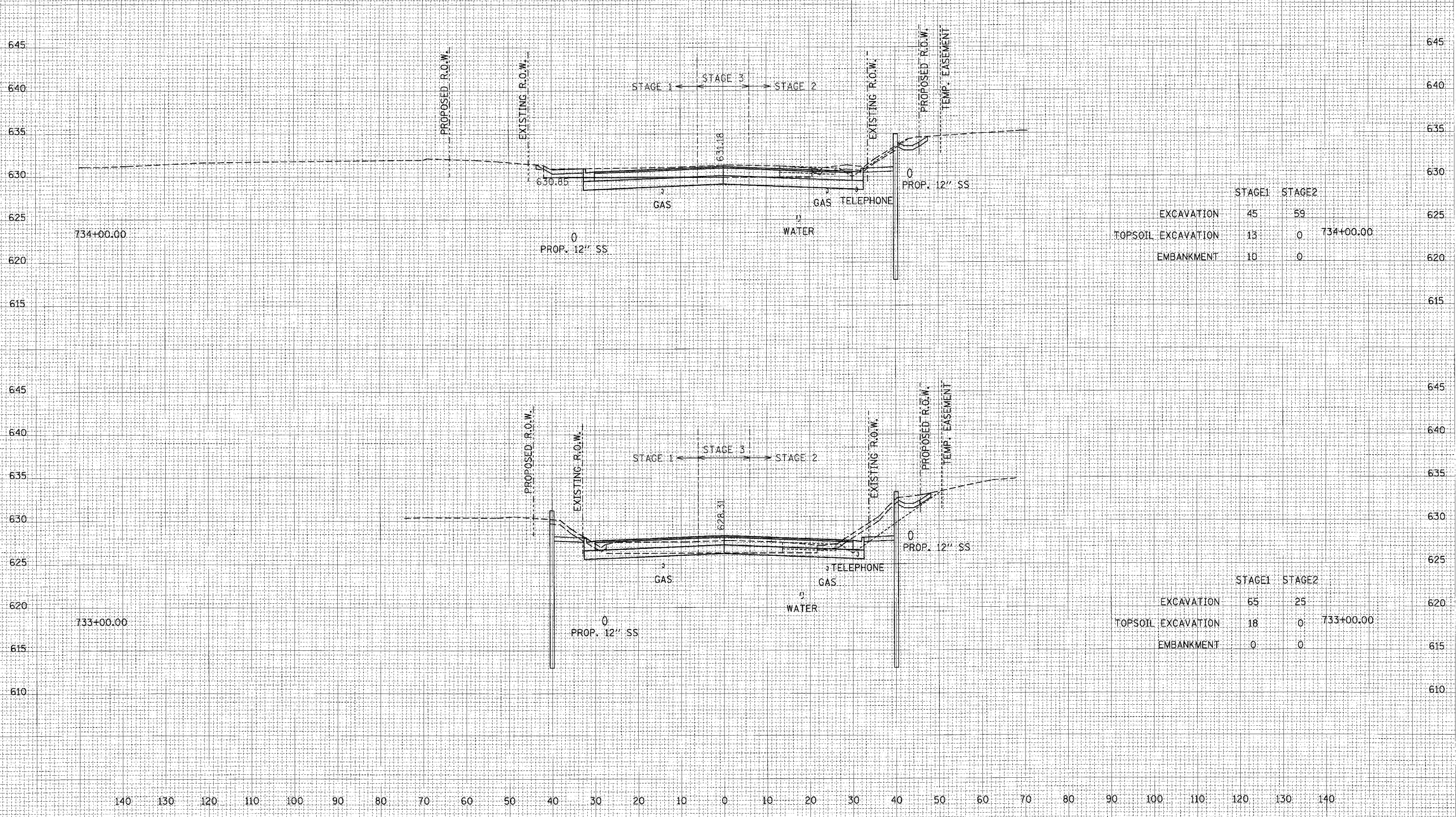

	STAGE1	STAGE2	
EXCAVATION	45	59	
TOPSOIL EXCAVATION	13	0	734+00.00
EMBANKMENT	10	0	

	STAGE1	STAGE2	
EXCAVATION	65	25	
TOPSOIL EXCAVATION	18	0	733+00.00
EMBANKMENT	0	0	

CROSS SECTIONS: U.S. ROUTE 30 - STA. 733+00.00 TO STA. 734+00.00

SCALE: 1" = 10' HORIZ.  
1" = 5' VERT.

DATE: \_\_\_\_\_  
BY: \_\_\_\_\_  
REVISIONS:  
NO. DATE DESCRIPTION  
1. \_\_\_\_\_

DATE: \_\_\_\_\_  
BY: \_\_\_\_\_  
REVISIONS:  
NO. DATE DESCRIPTION  
1. \_\_\_\_\_

I:\dot\0006602\draw\bid\sheets\X330.dgn