

F.A. RTE.	SECTION	COUNTY	TOTAL SHEETS	SHEET NO.
575	(B+14) R-3	WILL	390	281
STA.		TO STA.		
FED. ROAD DIST. NO.	ILLINOIS	FED. AID PROJECT		
CONTRACT NO. 60961				

FINAL	DATE
SURVEY	BY
NOTE BOOK	
AREAS CHECKED	

ORIGINAL	DATE
SURVEY	BY
NOTE BOOK	
AREAS CHECKED	

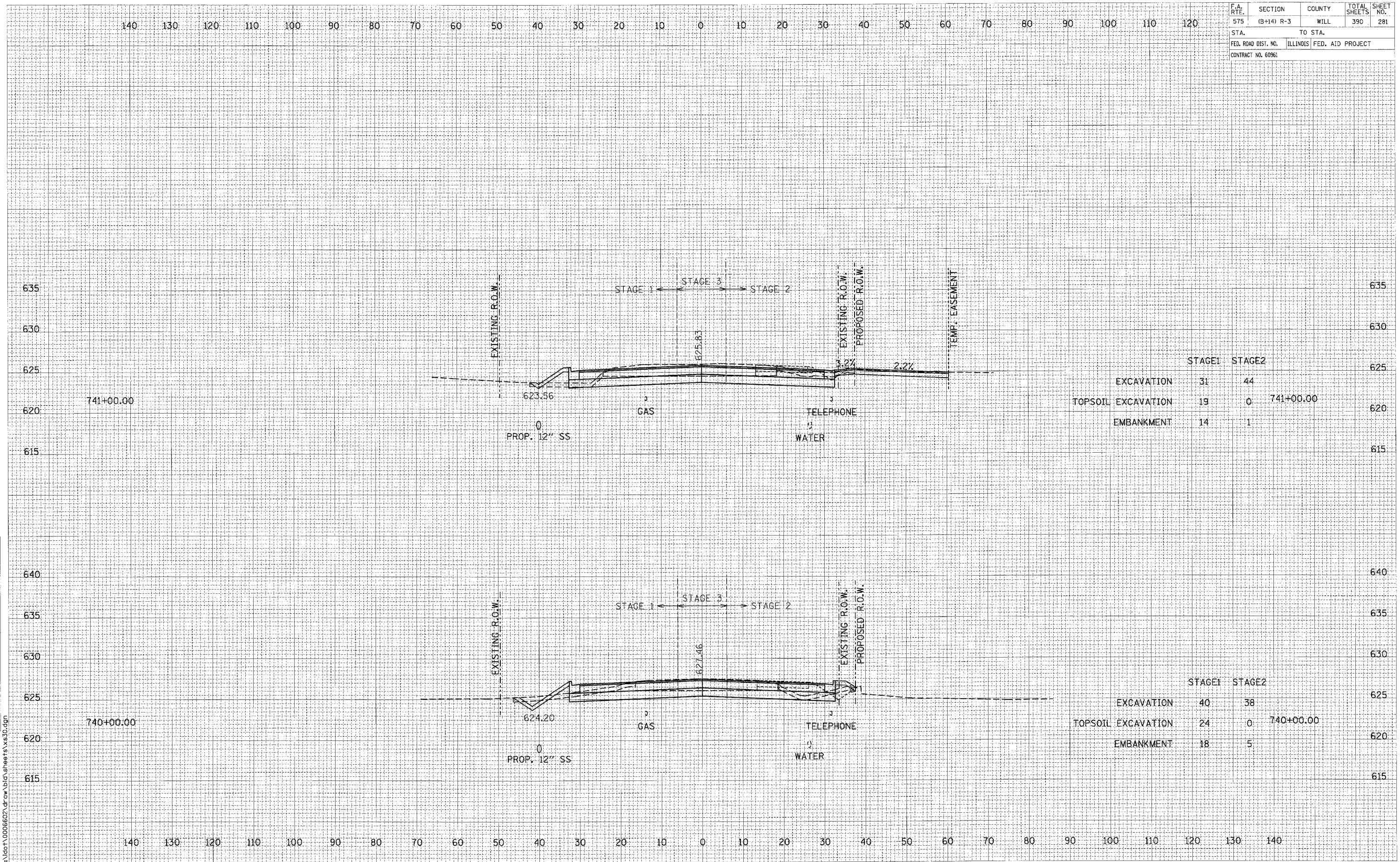

	STAGE1	STAGE2	
EXCAVATION	31	44	741+00.00
TOPSOIL EXCAVATION	19	0	
EMBANKMENT	14	1	

	STAGE1	STAGE2	
EXCAVATION	40	38	740+00.00
TOPSOIL EXCAVATION	24	0	
EMBANKMENT	18	5	

CROSS SECTIONS: U.S. ROUTE 30 - STA. 740+00.00 TO STA. 741+00.00

SCALE: 1" = 10' HORIZ.  
1" = 5' VERT.

I:\dot\0006602\draw\bid\sheet\ss\30.dgn