

F.A. RTE.	SECTION	COUNTY	TOTAL SHEETS	SHEET NO.
575	(B+14) R-3	WILL	390	289
STA.		TO STA.		
FED. ROAD DIST. NO.		ILLINOIS FED. AID PROJECT		
CONTRACT NO. 60961				

DATE	BY

DATE	BY

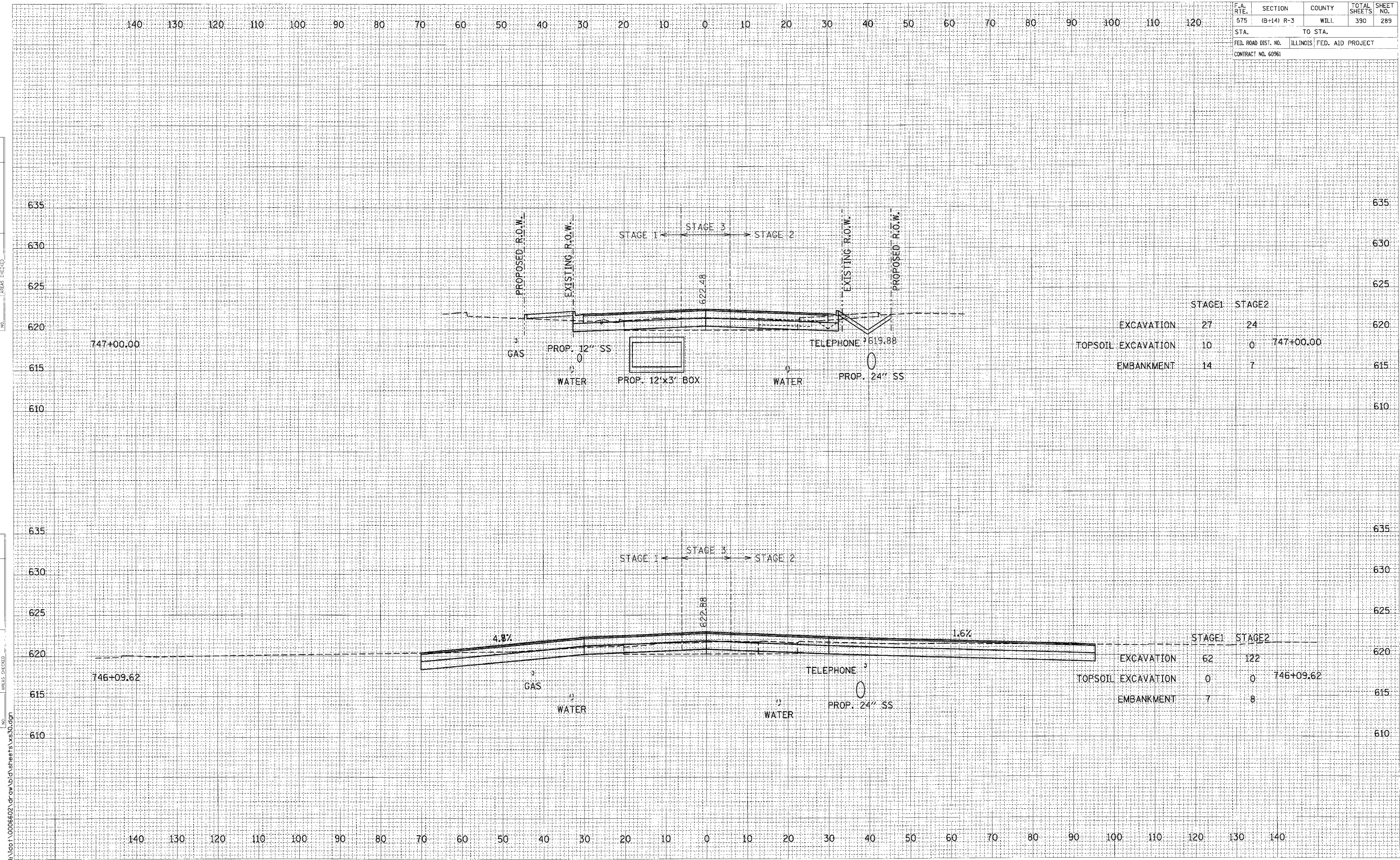

	STAGE1	STAGE2	
EXCAVATION	27	24	
TOPSOIL EXCAVATION	10	0	747+00.00
EMBANKMENT	14	7	

	STAGE1	STAGE2	
EXCAVATION	62	122	
TOPSOIL EXCAVATION	0	0	746+09.62
EMBANKMENT	7	8	

CROSS SECTIONS: U.S. ROUTE 30 - STA. 746+09.62 TO STA. 747+00.00  
 SCALE: 1" = 10' HORIZ.  
 1" = 5' VERT.

I:\dof\0006602\draw\bid\sheets\Xs30.dgn