

F.A. RTE.	SECTION	COUNTY	TOTAL SHEETS	SHEET NO.
575	(B+14) R-3	WILL	390	296
STA.		TO STA.		
FED. ROAD DIST. NO.		ILLINOIS FED. AID PROJECT		
CONTRACT NO. 60961				

FINAL	DATE
SURVEY	BY
NOTE BOOK	NO.
REVISIONS	
1	
2	
3	
4	
5	

ORIGINAL	DATE
SURVEY	BY
NOTE BOOK	NO.
REVISIONS	
1	
2	
3	
4	
5	

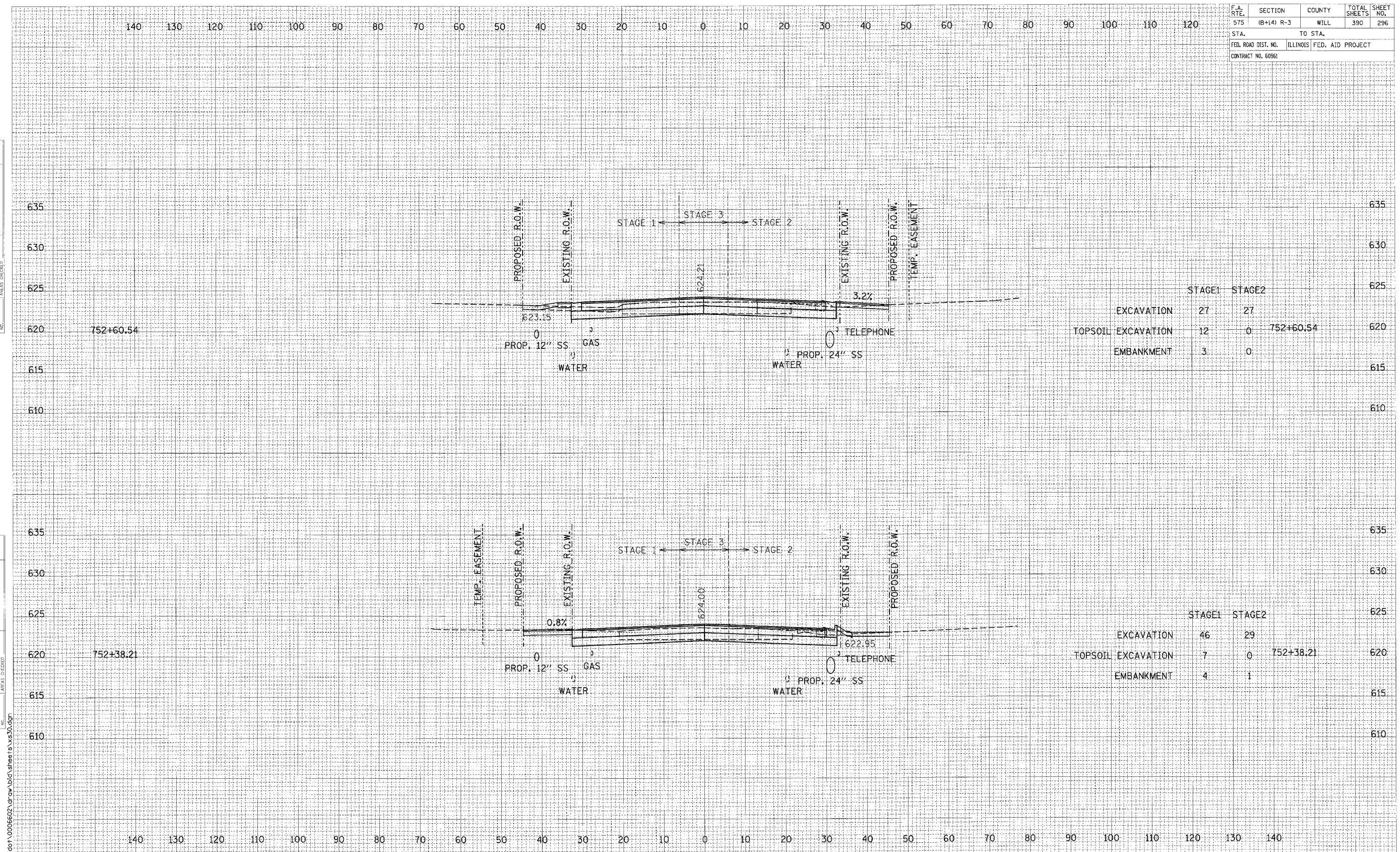

	STAGE1	STAGE2	
EXCAVATION	27	27	
TOPSOIL EXCAVATION	12	0	752+60.54
EMBANKMENT	3	0	

	STAGE1	STAGE2	
EXCAVATION	46	29	
TOPSOIL EXCAVATION	7	0	752+38.21
EMBANKMENT	4	1	

CROSS SECTIONS: U.S. ROUTE 30 - STA. 752+38.21 TO STA. 752+60.54
 SCALE: 1" = 10' HORIZ.
 1" = 5' VERT.