

F.A. RTE.	SECTION	COUNTY	TOTAL SHEETS	SHEET NO.
575	(B+14) R-3	WILL	390	298
STA.		TO STA.		
FED. ROAD DIST. NO.	ILLINOIS	FED. AID PROJECT		
CONTRACT NO. 60961				

FINAL SURVEY	DATE
SHEET NO.	
NO. L. BOOK	
AREAS CHECKED	

ORIGINAL SURVEY	DATE
NOTE BOOK	
AREAS CHECKED	

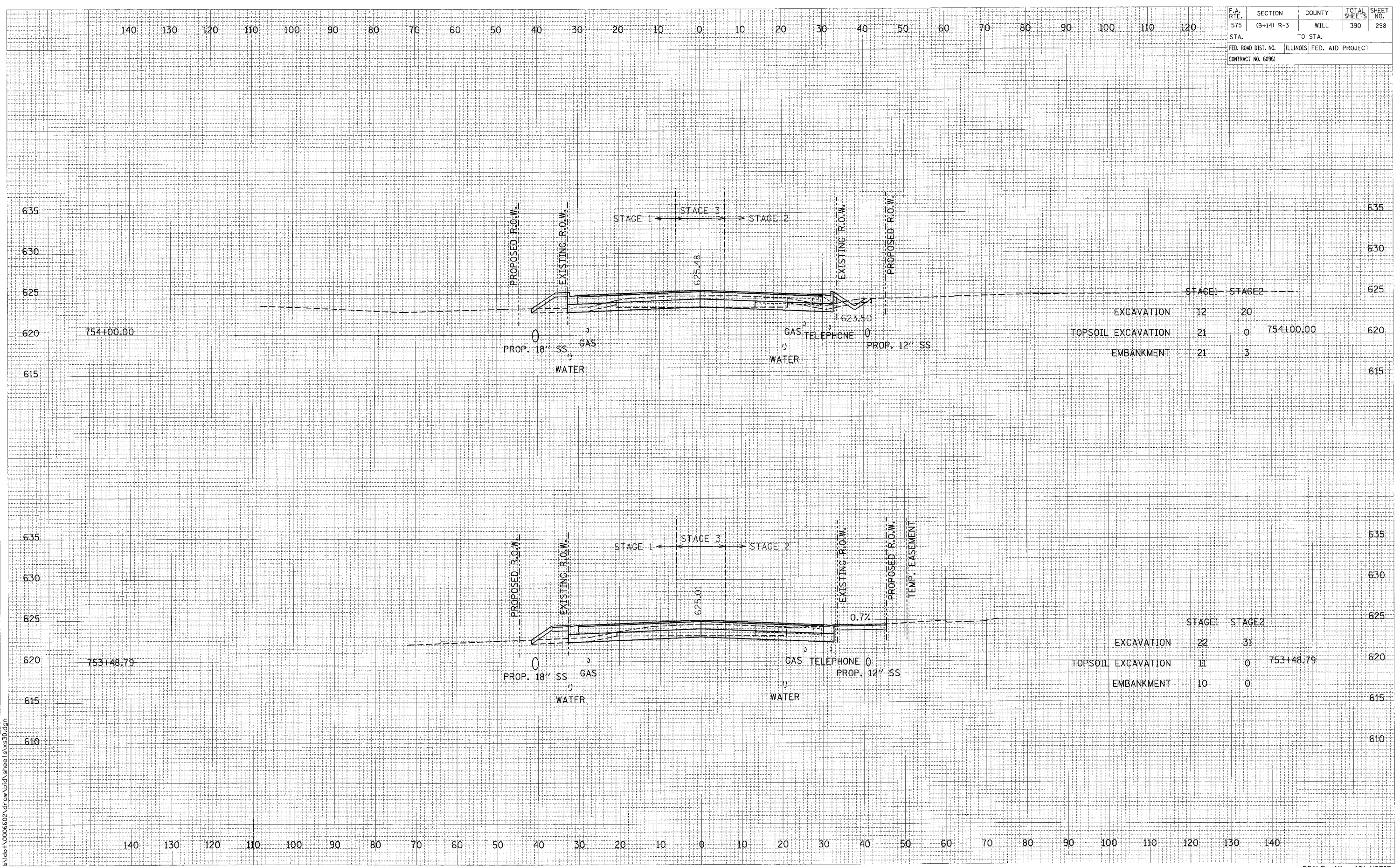

	STAGE 1	STAGE 2		
EXCAVATION	12	20		
TOPSOIL EXCAVATION	21	0	754+00.00	
EMBANKMENT	21	3		

	STAGE 1	STAGE 2		
EXCAVATION	22	31		
TOPSOIL EXCAVATION	11	0	753+48.79	
EMBANKMENT	10	0		

CROSS SECTIONS: U.S. ROUTE 30 - STA. 753+48.79 TO STA. 754+00.00

SCALE: 1" = 10' HORIZ.
1" = 5' VERT.