

F.A. RILEY	SECTION (B+14) R-3	COUNTY WILL	TOTAL SHEETS 390	SHEET NO. 301
STA. 756+70.29		TO STA. 756+11.67		
FED. ROAD DIST. NO. ILLINOIS		FED. AID PROJECT		
CONTRACT NO. 60961				

DATE	BY
DESIGNED	BY
PLOTTED	BY
NOTE BOOK	NO.
AREAS CHECKED	

DATE	BY
DESIGNED	BY
PLOTTED	BY
NOTE BOOK	NO.
AREAS CHECKED	

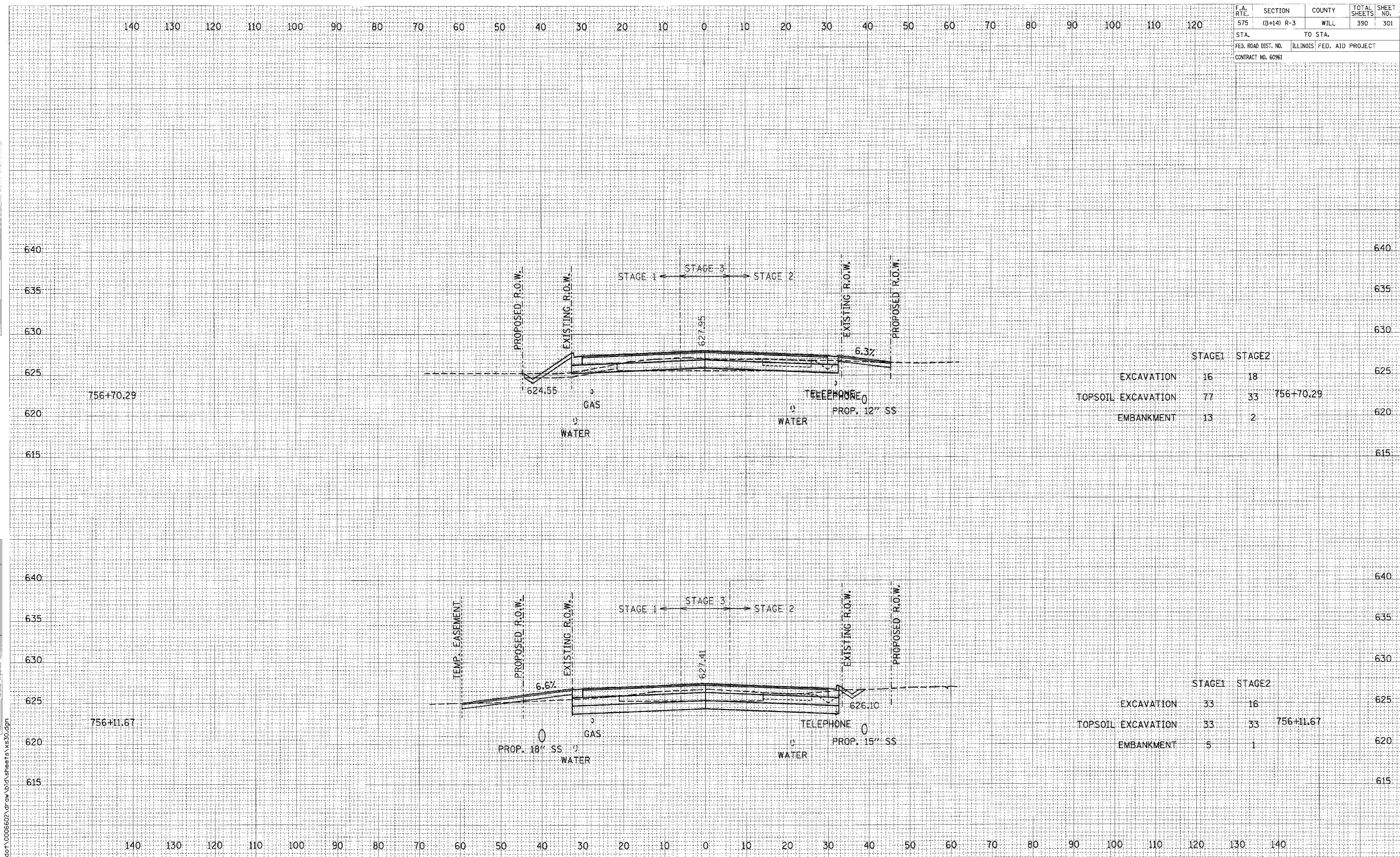

	STAGE 1	STAGE 2	
EXCAVATION	16	18	
TOPSOIL EXCAVATION	77	33	756+70.29
EMBANKMENT	13	2	

	STAGE 1	STAGE 2	
EXCAVATION	33	16	
TOPSOIL EXCAVATION	33	33	756+11.67
EMBANKMENT	5	1	