

F.A. RTE.	SECTION	COUNTY	TOTAL SHEETS	SHEET NO.
575	(B+14) R-3	WILL	390	302
STA.		TO STA.		
FED. ROAD DIST. NO.		ILLINOIS FED. AID PROJECT		
CONTRACT NO. 60961				

DATE	BY
NO.	NO.
NO.	NO.
NO.	NO.
NO.	NO.

DATE	BY
NO.	NO.
NO.	NO.
NO.	NO.
NO.	NO.

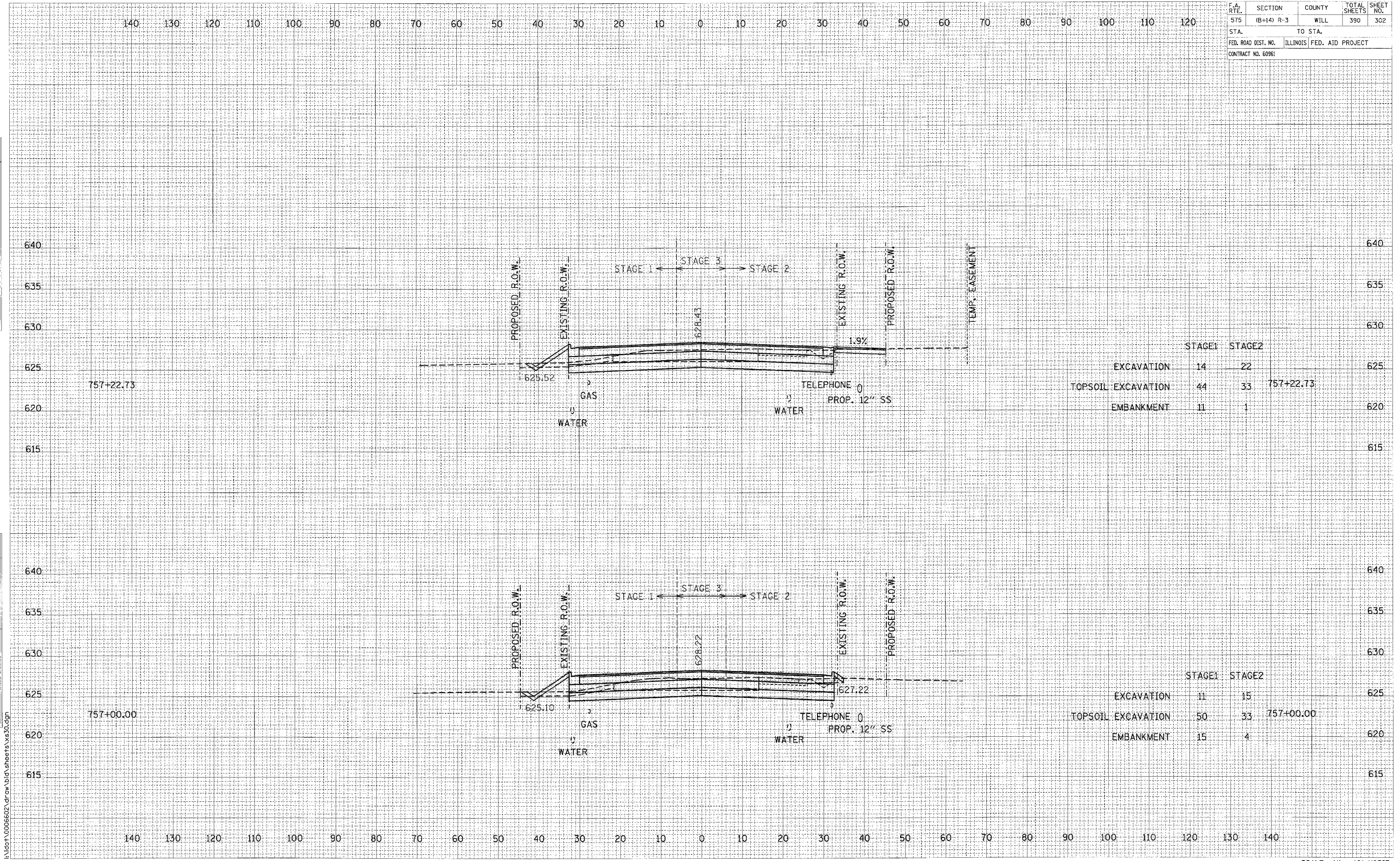

CROSS SECTIONS: U.S. ROUTE 30 - STA. 757+00.00 TO STA. 757+22.73

SCALE: 1" = 10' HORIZ.
1" = 5' VERT.