

F.A. RTE.	SECTION	COUNTY	TOTAL SHEETS	SHEET NO.
575	(B+14) R-3	WILL	390	307
STA.		TO STA.		
FED. ROAD DIST. NO.		ILLINOIS FED. AID PROJECT		
CONTRACT NO. 60961				

DATE	BY
APPROVED	DATE
PLotted	
NOTE BOOK	
AREAS CHECKED	

DATE	BY
APPROVED	DATE
PLotted	
NOTE BOOK	
AREAS CHECKED	

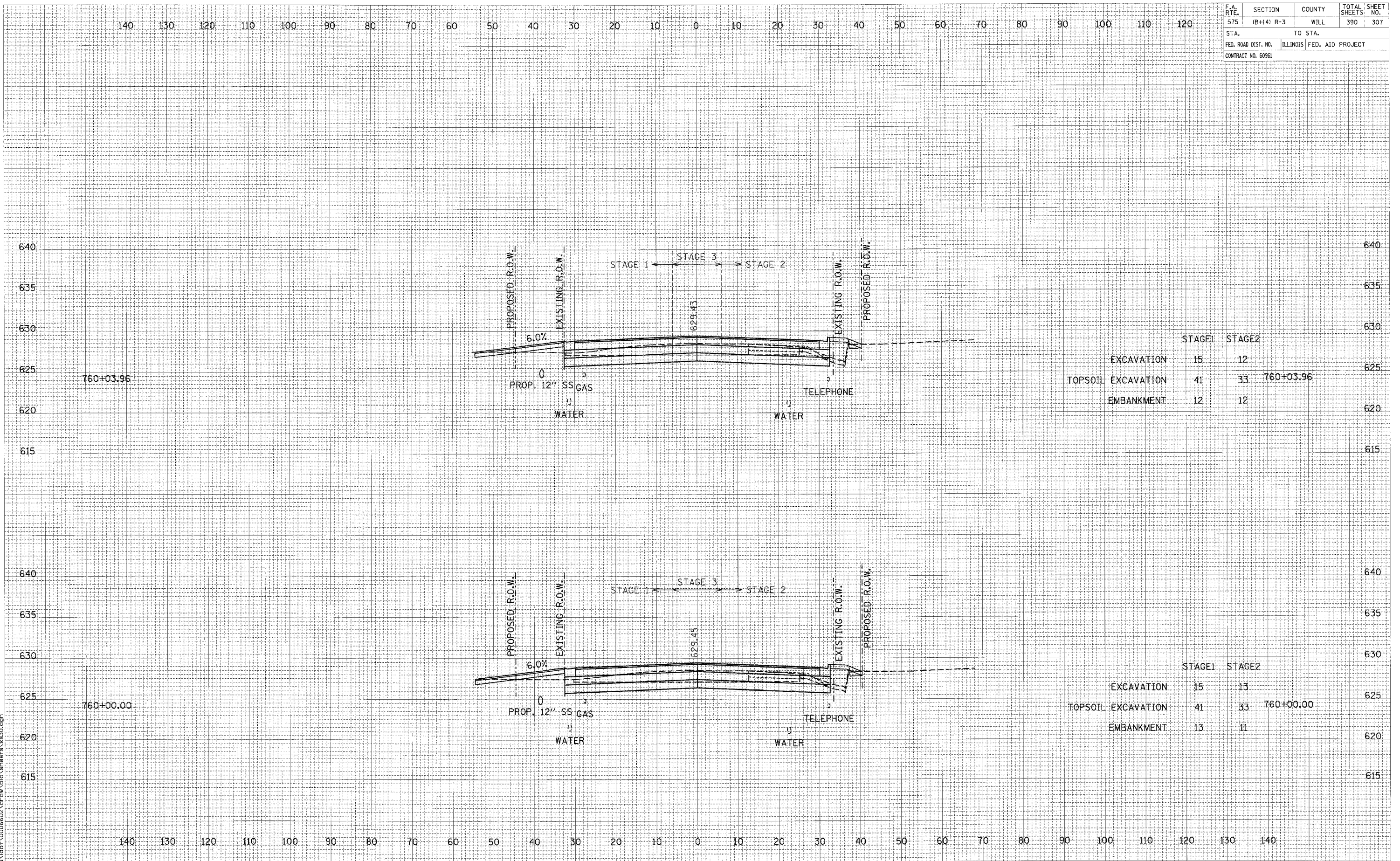

	STAGE1	STAGE2	
EXCAVATION	15	12	
TOPSOIL EXCAVATION	41	33	760+03.96
EMBANKMENT	12	12	

	STAGE1	STAGE2	
EXCAVATION	15	13	
TOPSOIL EXCAVATION	41	33	760+00.00
EMBANKMENT	13	11	

CROSS SECTIONS: U.S. ROUTE 30 - STA. 760+00.00 TO STA. 760+03.96

SCALE: 1" = 10' HORIZ.
1" = 5' VERT.

I:\ido\10006602\draw\bid\sheeta\vs30.dgn