

F.A. R.T.E.	SECTION	COUNTY	TOTAL SHEETS	SHEET NO.
575	(B+14) R-3	WILL	390	309
STA.		TO STA.		
FED. ROAD DIST. NO.		ILLINOIS FED. AID PROJECT		
CONTRACT NO. 60961				

DATE	BY	REVISED
		PLOTTED
		TRAP AT
		NOTE BOOK
		AREAS CHECKED
		NO.

DATE	BY	REVISED
		PLOTTED
		TRAP AT
		NOTE BOOK
		AREAS CHECKED
		NO.

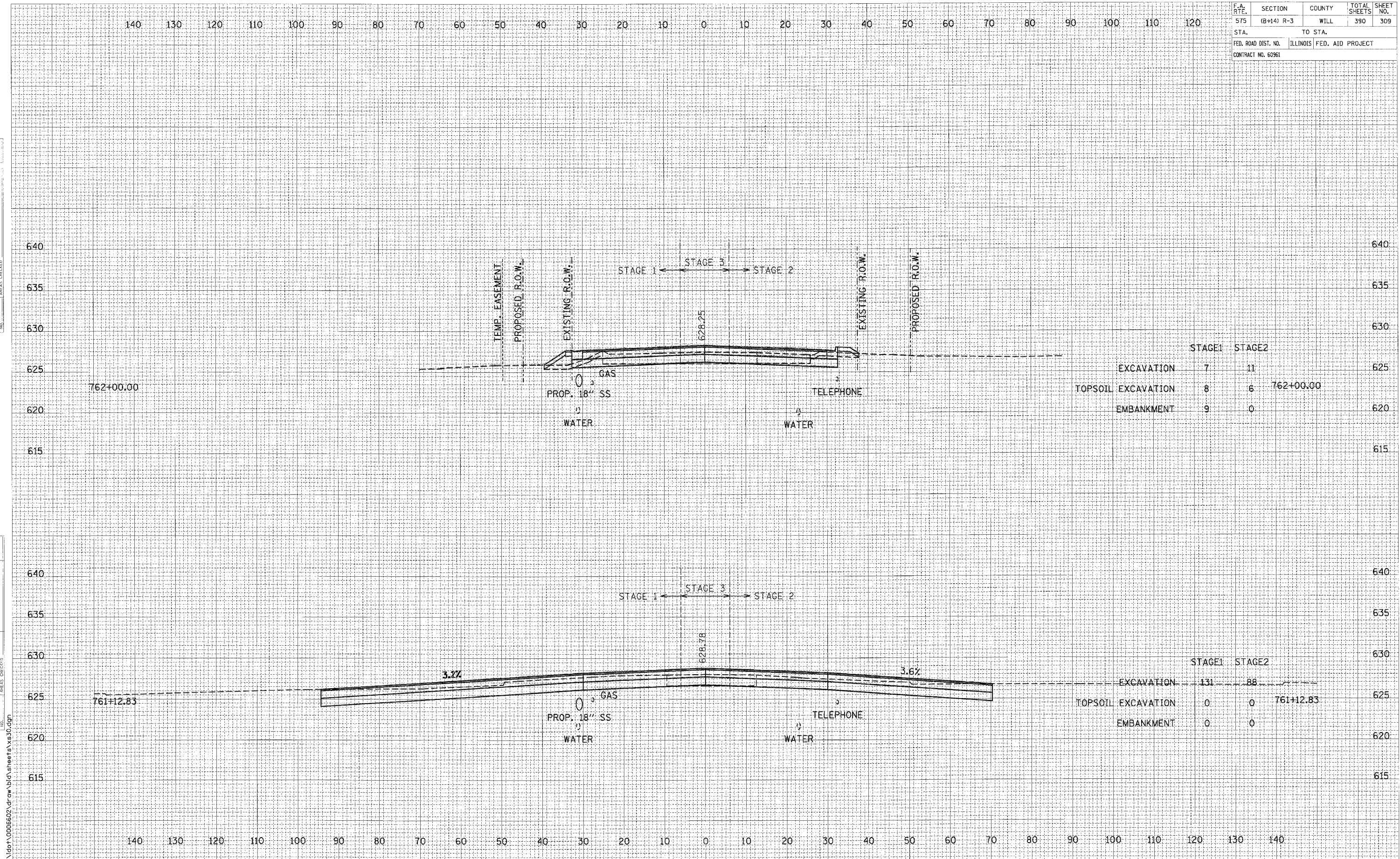

	STAGE 1	STAGE 2	
EXCAVATION	7	11	
TOPSOIL EXCAVATION	8	6	762+00.00
EMBANKMENT	9	0	

	STAGE 1	STAGE 2	
EXCAVATION	131	88	
TOPSOIL EXCAVATION	0	0	761+12.83
EMBANKMENT	0	0	

CROSS SECTIONS: U.S. ROUTE 30 - STA. 761+12.83 TO STA. 762+00.00

SCALE: 1" = 10' HORIZ.
1" = 5' VERT.

I:\dot\006602\dr aw b\cd\sheets\xs30.cdp