

F.A. RTE.	SECTION	COUNTY	TOTAL SHEETS	SHEET NO.
575	(B-14) R-3	WILL	390	346
STA.		TO STA.		
FED. ROAD DIST. NO.		ILLINOIS FED. AID PROJECT		
CONTRACT NO. 60961				

DATE	BY

DATE	BY

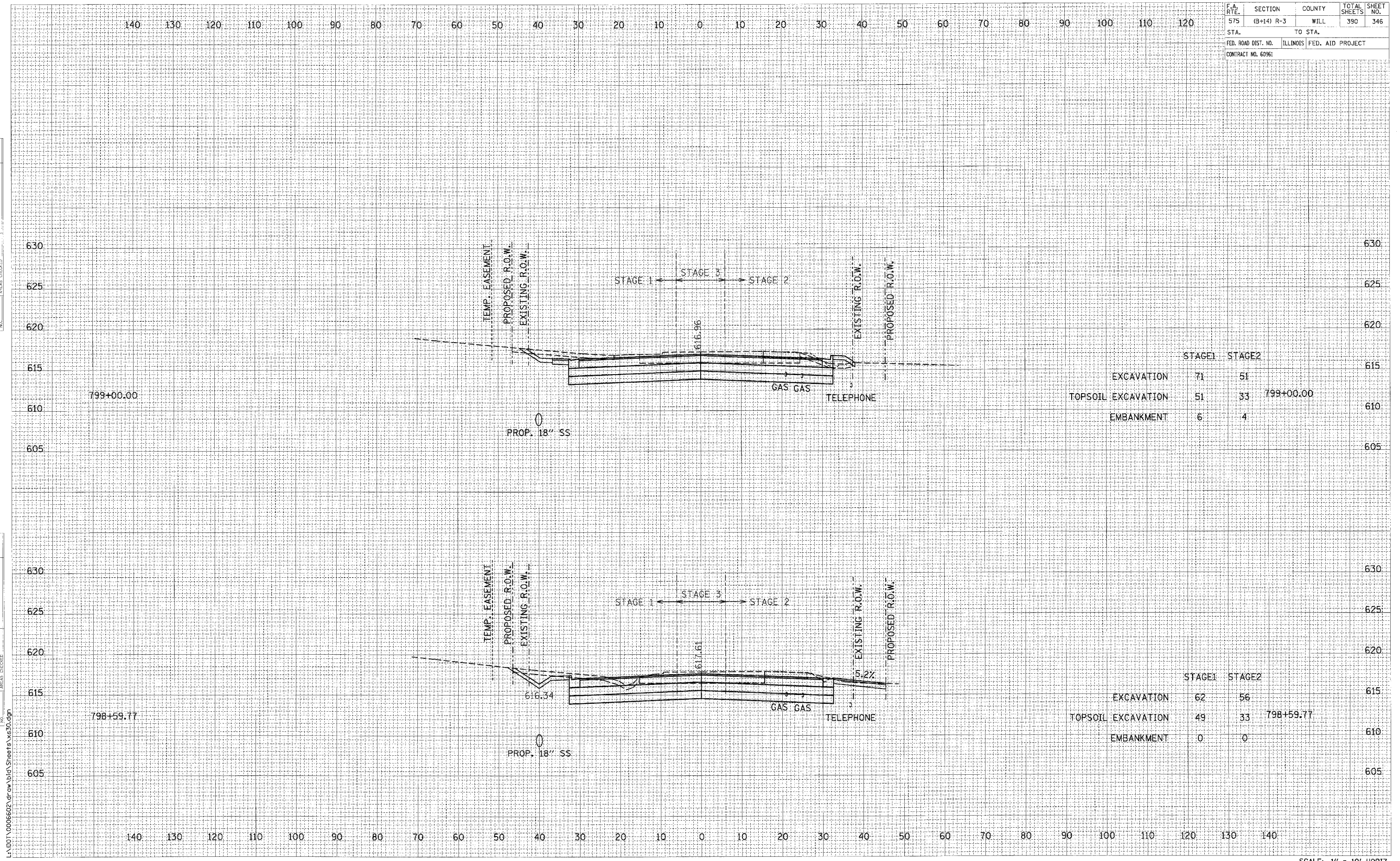

	STAGE1	STAGE2	
EXCAVATION	71	51	
TOPSOIL EXCAVATION	51	33	799+00.00
EMBANKMENT	6	4	

	STAGE1	STAGE2	
EXCAVATION	62	56	
TOPSOIL EXCAVATION	49	33	798+59.77
EMBANKMENT	0	0	

CROSS SECTIONS: U.S. ROUTE 30 - STA. 798+59.77 TO STA. 799+00.00

SCALE: 1" = 10' HORIZ.  
1" = 5' VERT.

L:\DOT\000602\Draw\Bldg\Sheets\30.dgn