

F.A. RTE.	SECTION	COUNTY	TOTAL SHEETS	SHEET NO.
575	(B+14) R-3	WILL	390	361
STA.		TO STA.		
FED. ROAD DIST. NO.		ILLINOIS FED. AID PROJECT		
CONTRACT NO. 60961				

DATE	BY
SAVED	
SURVEY	
PLOTTED	
NOTE BOOK	
AREAS CHECKED	
NO.	

DATE	BY
ORIGINAL SURVEY	
PLOTTED	
NOTE BOOK	
AREAS CHECKED	
NO.	

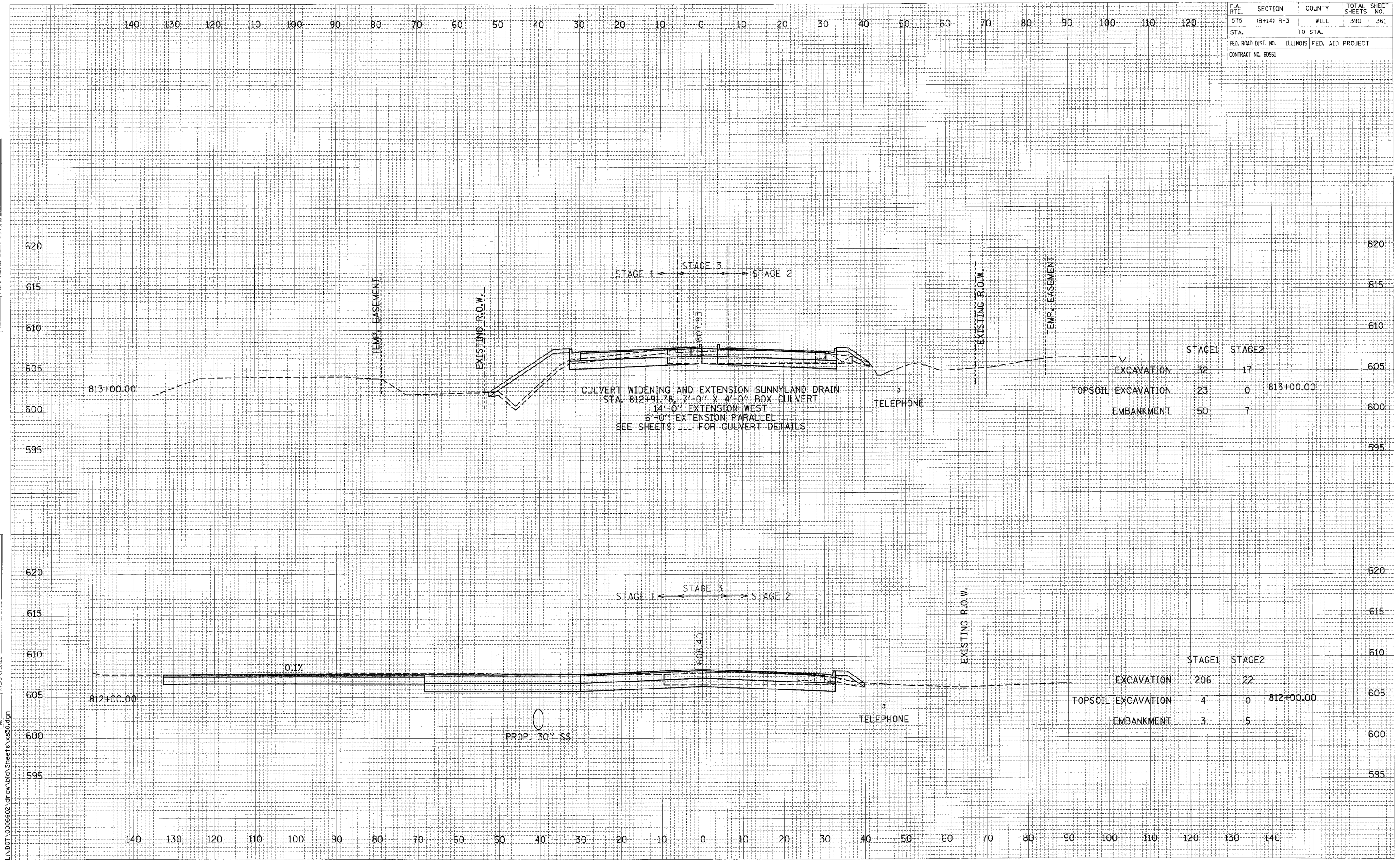

CROSS SECTIONS: U.S. ROUTE 30 - STA. 812+00.00 TO STA. 813+00.00  
 SCALE: 1" = 10' HORIZ.  
 1" = 5' VERT.

L:\DOT\0006602\Draw\1d\1d\Sheets\vs30.dgn