

F.A. RTE.	SECTION	COUNTY	TOTAL SHEETS	SHEET NO.
575	(B&I) R-3	WILL	390	373
STA. 764+00		TO STA. 768+00		
FED. ROAD DIST. NO.		ILLINOIS	FED. AID PROJECT	
CONTRACT NO. 80981				

MUNICIPALITY: CREST HILL

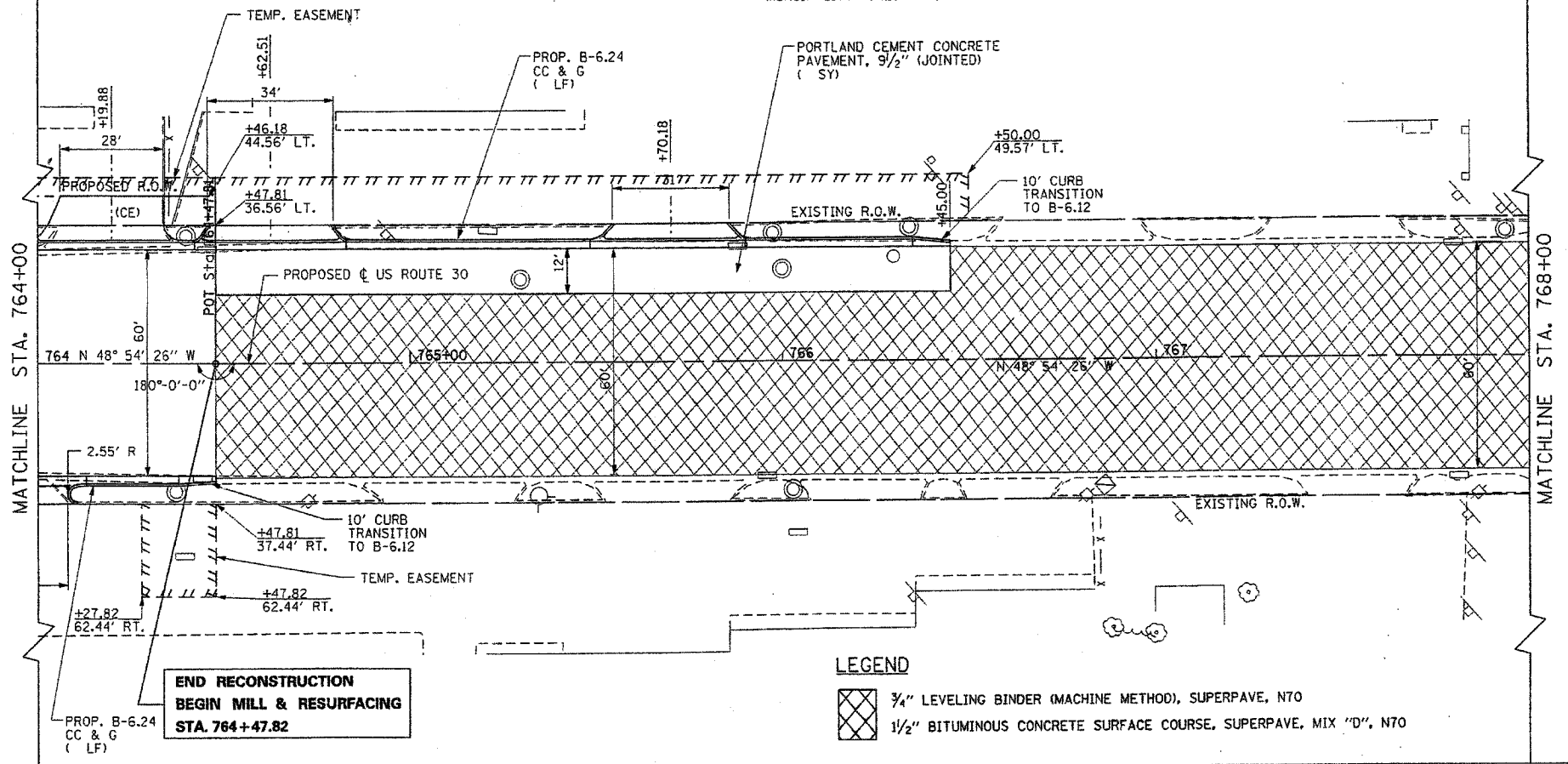

- NOTES:**
1. FOR CURVE DATA AND BENCHMARKS SEE ALIGNMENT, TIES & BENCHMARKS SHEETS.
 2. FOR REMOVAL INFORMATION SEE REMOVAL SHEETS.
 3. FOR DRAINAGE AND UTILITY INFORMATION SEE DRAINAGE/UTILITY SHEETS.
 4. FOR DRIVEWAY PAVEMENT MATERIAL AND THICKNESS SEE SCHEDULE OF DRIVEWAY QUANTITIES.
 5. REFER TO DISTRICT ONE STANDARD DETAIL FOR DRIVEWAY DESIGN.
 6. ALL RADII ARE TO EDGE OF PAVEMENT UNLESS OTHERWISE NOTED.
 7. FOR MAILBOX TURNOUTS SEE CONSTRUCTION DETAIL SHEET.

**END RECONSTRUCTION
BEGIN MILL & RESURFACING
STA. 764+47.82**

- LEGEND**
- 3/4" LEVELING BINDER (MACHINE METHOD), SUPERPAVE, N70
 - 1 1/2" BITUMINOUS CONCRETE SURFACE COURSE, SUPERPAVE, MIX "D", N70

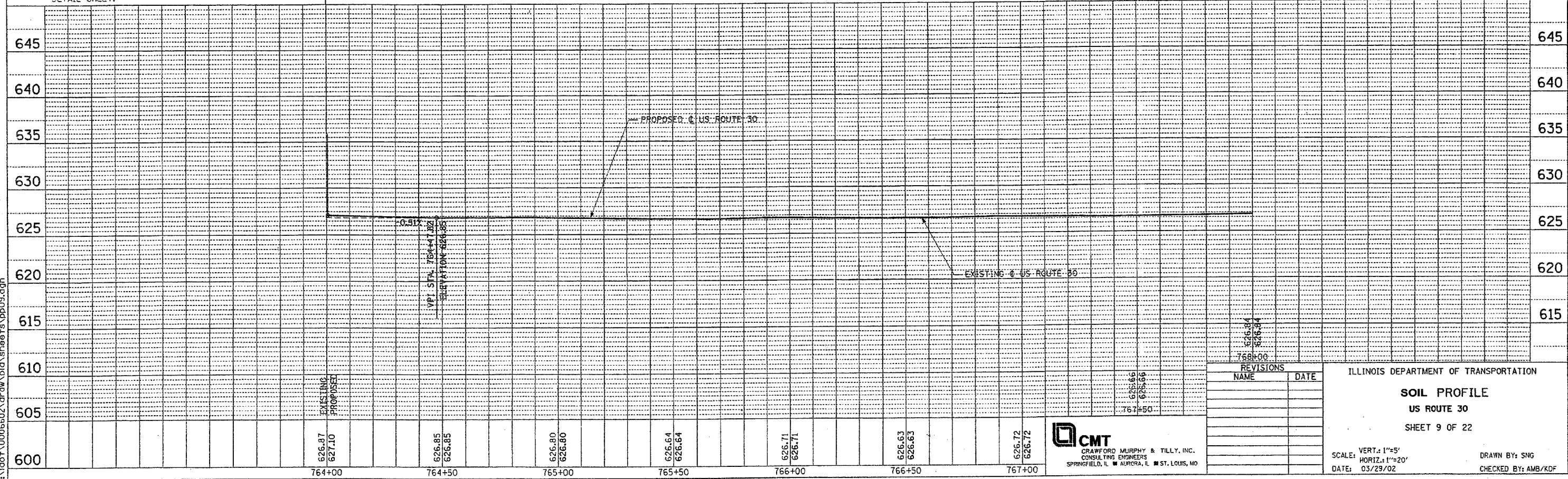

REVISIONS	
NAME	DATE

ILLINOIS DEPARTMENT OF TRANSPORTATION

SOIL PROFILE

US ROUTE 30

SHEET 9 OF 22

SCALE: VERT. 1"=5'
HORIZ. 1"=20'

DATE: 03/29/02

DRAWN BY: SNG
CHECKED BY: AMB/KDF

CMT
CRAWFORD MURPHY & TILLY, INC.
CONSULTING ENGINEERS
SPRINGFIELD, IL ■ AURORA, IL ■ ST. LOUIS, MO

I:\dot\0006602\draw\bid\sheet\sheet9.dgn