

F.A. RTE.	SECTION	COUNTY	TOTAL SHEETS	SHEET NO.
575	(B&I) R-3	WILL	380	375
STA.	774+00	TO STA.	780+00	
FED. ROAD DIST. NO.	ILLINOIS	FED. AID PROJECT		
CONTRACT NO. 60961				

- NOTES:
1. FOR CURVE DATA AND BENCHMARKS SEE ALIGNMENT, TIES & BENCHMARKS SHEETS.
 2. FOR REMOVAL INFORMATION SEE REMOVAL SHEETS.
 3. FOR DRAINAGE AND UTILITY INFORMATION SEE DRAINAGE/UTILITY SHEETS.
 4. FOR DRIVEWAY PAVEMENT MATERIAL AND THICKNESS SEE SCHEDULE OF DRIVEWAY QUANTITIES.
 5. REFER TO DISTRICT ONE STANDARD DETAIL FOR DRIVEWAY DESIGN.
 6. ALL RADII ARE TO EDGE OF PAVEMENT UNLESS OTHERWISE NOTED.
 7. FOR MAILBOX TURNOUTS SEE CONSTRUCTION DETAIL SHEET.

UNINCORPORATED WILL COUNTY

BITUMINOUS CONCRETE SURFACE COURSE
SUPERPAVE MIX "D", N70-1 1/2"
LEVELING BINDER (MACHINE METHOD)
SUPERPAVE, N70 -2"

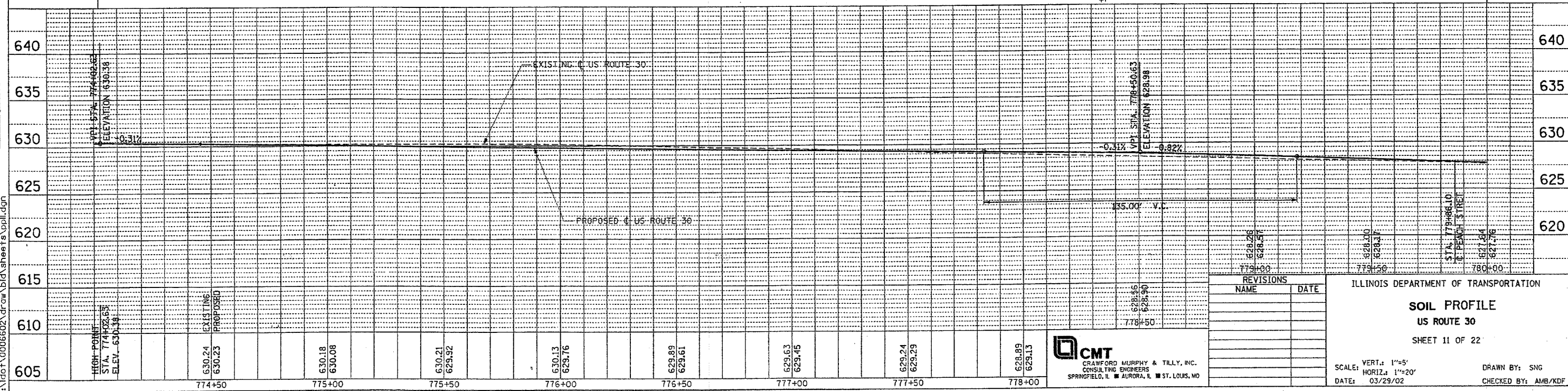
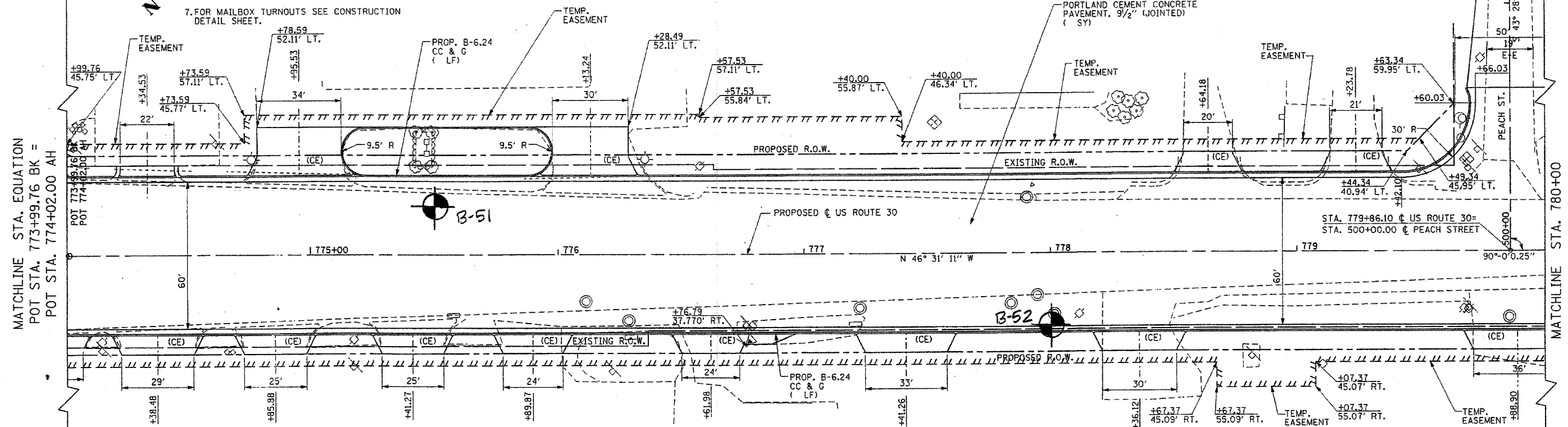

REVISIONS	
NAME	DATE

ILLINOIS DEPARTMENT OF TRANSPORTATION
SOIL PROFILE
US ROUTE 30
SHEET 11 OF 22

SCALE: VERT: 1"=5'
HORIZ: 1"=20'
DATE: 03/29/02

DRAWN BY: SNG
CHECKED BY: AMB/KDF

CMT
CRAWFORD MURPHY & TILLY, INC.
CONSULTING ENGINEERS
SPRINGFIELD, IL ■ AURORA, IL ■ ST. LOUIS, MO

DATE: 03/29/02
 DRAWN BY: SNG
 CHECKED BY: AMB/KDF
 PROJECT: US ROUTE 30
 SHEET: 11 OF 22