

F.A.P.	SECTION	COUNTY	TOTAL SHEETS	SHEET NO.
575	14-B-R-1 & 15N-3	WILL	143	1

STATE OF ILLINOIS
DEPARTMENT OF TRANSPORTATION
DIVISION OF HIGHWAYS

**PLANS FOR PROPOSED
HIGHWAY**

**F.A.P. 575: US 30 (LINCOLN HIGHWAY)
AT LILY CACHE ROAD & OVER LILY CACHE CREEK
SECTION: 14-B-R-1 & 15N-3
INTERSECTION RECONSTRUCTION, BRIDGE
REPLACEMENT AND TRAFFIC SIGNAL INSTALLATION
WILL COUNTY
C-91-002-01**

FOR INDEX OF SHEETS, SEE SHEET NO. 2

THE IMPROVEMENT IS LOCATED IN THE VILLAGE OF PLAINFIELD IN WILL COUNTY

FINAL PLANS

DESIGN DESIGNATION - 3240 (20) ARTERIAL 5.51 (PCC-20)



TRAFFIC DATA

US 30: 2003 ADT = 32400
POSTED SPEED LIMIT = 35 MPH

LILY CACHE ROAD: 1999 ADT = 2250
POSTED SPEED LIMIT = 35 MPH

U.S. ROUTE 30
BEGIN IMPROVEMENT
STA. 12+25

LILY CACHE ROAD
BEGIN STA. 105+00
END STA. 110+46

STRUCTURES
U.S. 30 OVER LILY CACHE CREEK
EXISTING SN: 099-0237
PROPOSED SN: 099-4648

U.S. 30 RETAINING WALL
PROPOSED SN: 099-W012

U.S. ROUTE 30
END IMPROVEMENT
STA. 37+50

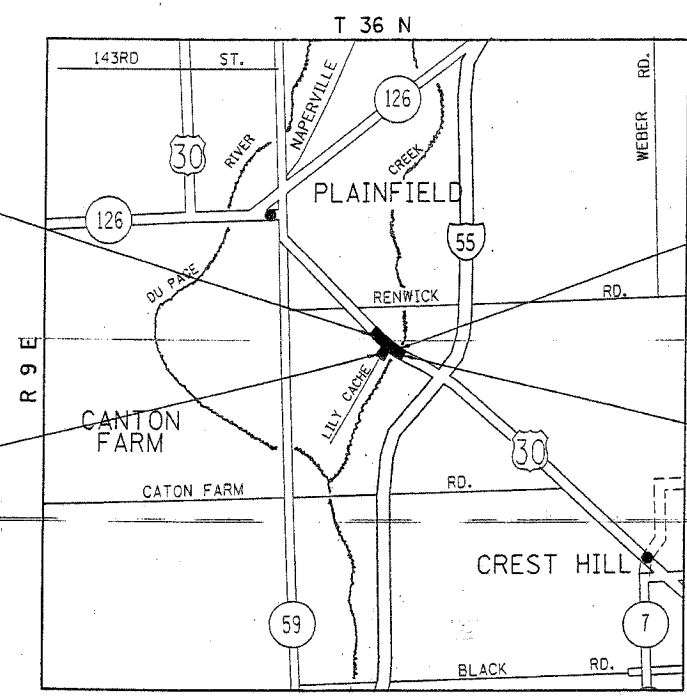

PLAINFIELD TOWNSHIP

MAP SCALE: 1 INCH = 2.0 MILE

GROSS AND NET LENGTH OF IMPROVEMENT = 3071 LINEAR FEET = 0.58 MILES

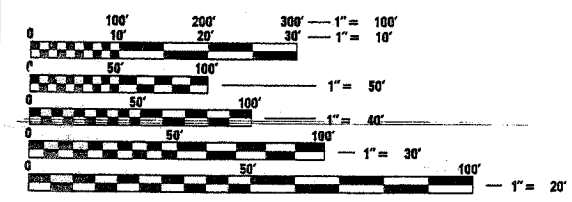

FULL SIZE PLANS HAVE BEEN PREPARED USING STANDARD ENGINEERING SCALES. REDUCED SIZED PLANS WILL NOT CONFORM TO STANDARD SCALES. IN MAKING MEASUREMENTS ON REDUCED PLANS, THE ABOVE SCALES MAY BE USED.

J.U.L.I.E.
JOINT UTILITY LOCATION INFORMATION FOR EXCAVATION
1-800-392-0123

CONTRACT NO. 62098

STATE OF ILLINOIS
DEPARTMENT OF TRANSPORTATION
DIVISION OF HIGHWAYS

SUBMITTED March 29, 20 05

Dina O'Keefe
DEPUTY DIRECTOR OF HIGHWAYS, REGION ENGINEER

July 1, 20 05
Mike Hine
ENGINEER OF DESIGN AND ENVIRONMENT

July 1, 20 05
Victor Mader
DIRECTOR OF HIGHWAYS, CHIEF ENGINEER

**PRINTED BY THE AUTHORITY
OF THE STATE OF ILLINOIS**

DISTRICT ONE DESIGN PLAN PREPARATION ENGINEER:
KEN ENG/ISSAM RAYAN (847)705-4240