

F.A.P. RTE.	SECTION	COUNTY	TOTAL SHEETS	SHEET NO.
575	14-B-R-1&15N-3	WILL	143	28
STA.		TO STA.		
FED. ROAD DIST. NO. 1		ILLINOIS FED. AID PROJECT		
CONTRACT NO. 62098				

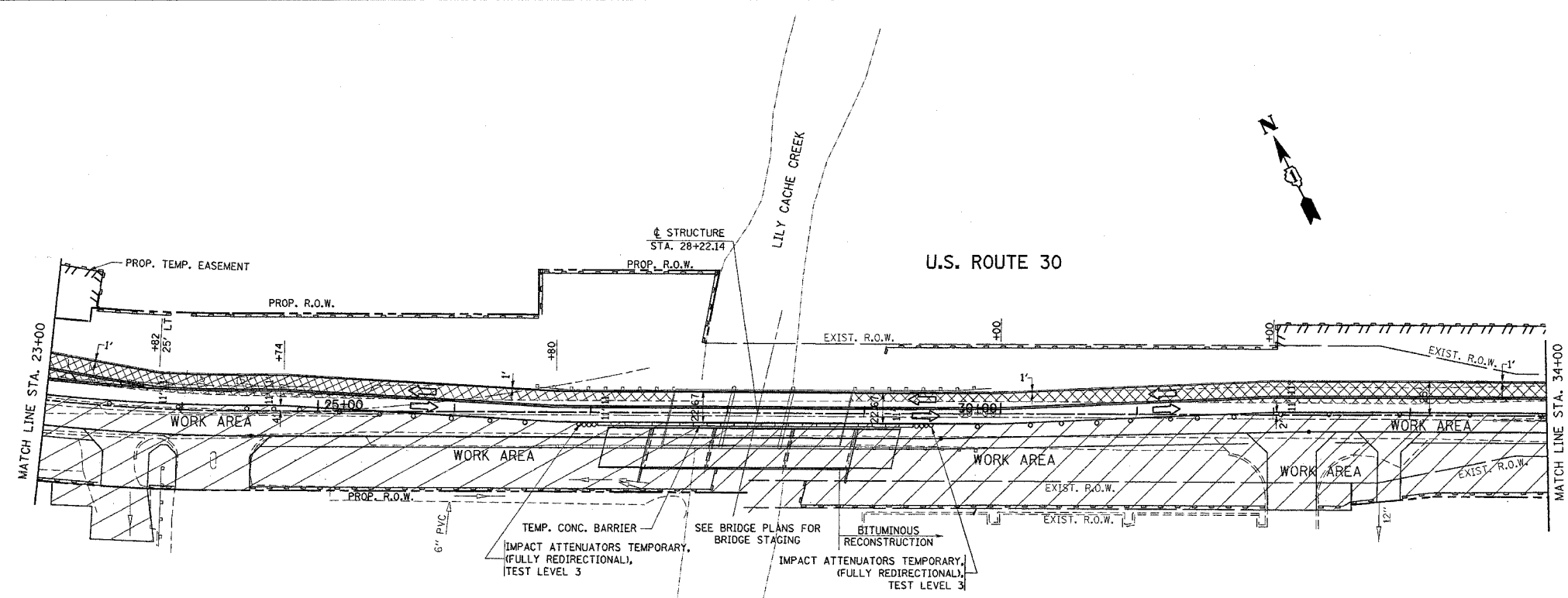

SOIL EROSION AND SEDIMENT CONTROL NOTES

THE SOIL AND WATER CONSERVATION DISTRICT IS RESPONSIBLE FOR CONDUCTING SITE VISITS AND VERIFYING THAT THE PRACTICES ARE WORKING PROPERLY AND DETERMINE IF ADDITIONAL PRACTICES ARE NEEDED FOR BETTER SOIL EROSION AND SEDIMENT CONTROL. IF ADDITIONAL PRACTICES ARE DEEMED NECESSARY BY THE SWCD THE CONTRACTOR WILL IMPLEMENT THE PRACTICES IN A TIMELY MANNER.

THE WILL/SOUTH COOK SOIL AND WATER CONSERVATION DISTRICT MUST BE NOTIFIED ONE WEEK PRIOR TO THE PRE-CONSTRUCTION CONFERENCE, ONE WEEK PRIOR TO THE COMMENCEMENT OF THE LAND DISTURBING ACTIVITIES, AND ONE WEEK PRIOR TO FINAL INSPECTION.

ALL SOIL EROSION AND SEDIMENT CONTROL PRACTICES ARE REFERENCED FROM THE ILLINOIS URBAN MANUAL.

NOTE:

1. NO SLOPE SHALL BE LEFT UNDISTURBED FOR MORE THAN 14 DAYS WITHOUT THE PLACEMENT OF TEMPORARY OR PERMANENT SEEDING.
2. SOIL AND EROSION CONTROL PRACTICE SHALL BE IN ACCORDANCE WITH STANDARD 280001 "TEMPORARY EROSION CONTROL SYSTEM".
3. ANY AREA WHERE THERE IS NO PROPOSED GRADING, THE EXISTING GROUND COVER SHALL REMAIN.

LEGEND

- ◆ TEMPORARY DITCH CHECK
- ⊕ DRAINAGE STRUCTURE INLET FILTER
- PERIMETER EROSION BARRIER
- +— TEMPORARY SWALE
- ~ TEMPORARY DITCH
- ▨ SODDING, SALT TOLERANT
- ▩ SODDING, SALT TOLERANT

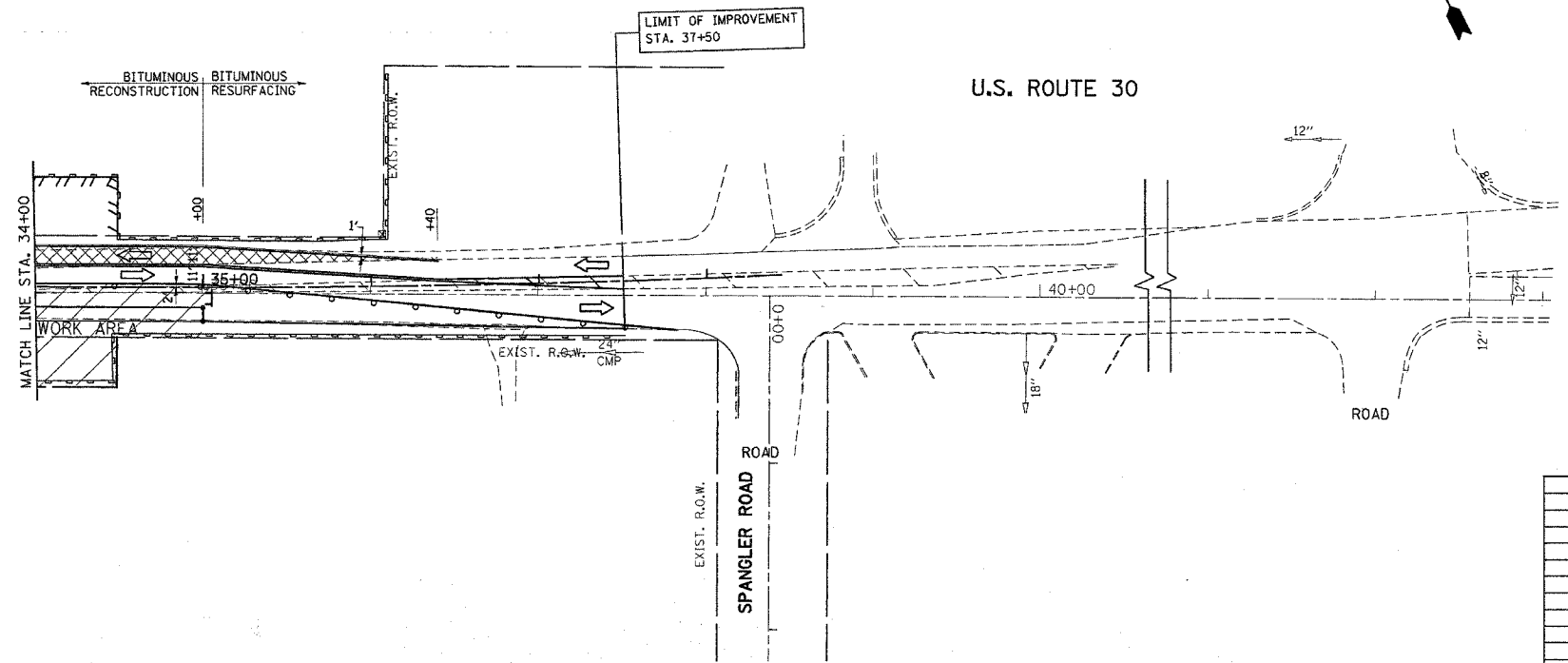

REVISIONS	
NAME	DATE

ILLINOIS DEPARTMENT OF TRANSPORTATION
 US RTE 30 @ LILY CACHE RD.
 SUGGESTED STAGING AND
 EROSION CONTROL PLAN
 STAGE I AND IA
 SCALE: VERT. _____
 HORIZ. _____
 DATE 5/20/2005
 DRAWN BY _____
 CHECKED BY _____