

F.A.P. RTE.	SECTION	COUNTY	TOTAL SHEETS	SHEET NO.
575	14-B-R-1&15N-3	WILL	143	51
STA.		TO STA.		
FED. ROAD DIST. NO. 1		ILLINOIS	FED. AID PROJECT	
CONTRACT NO. 62098				

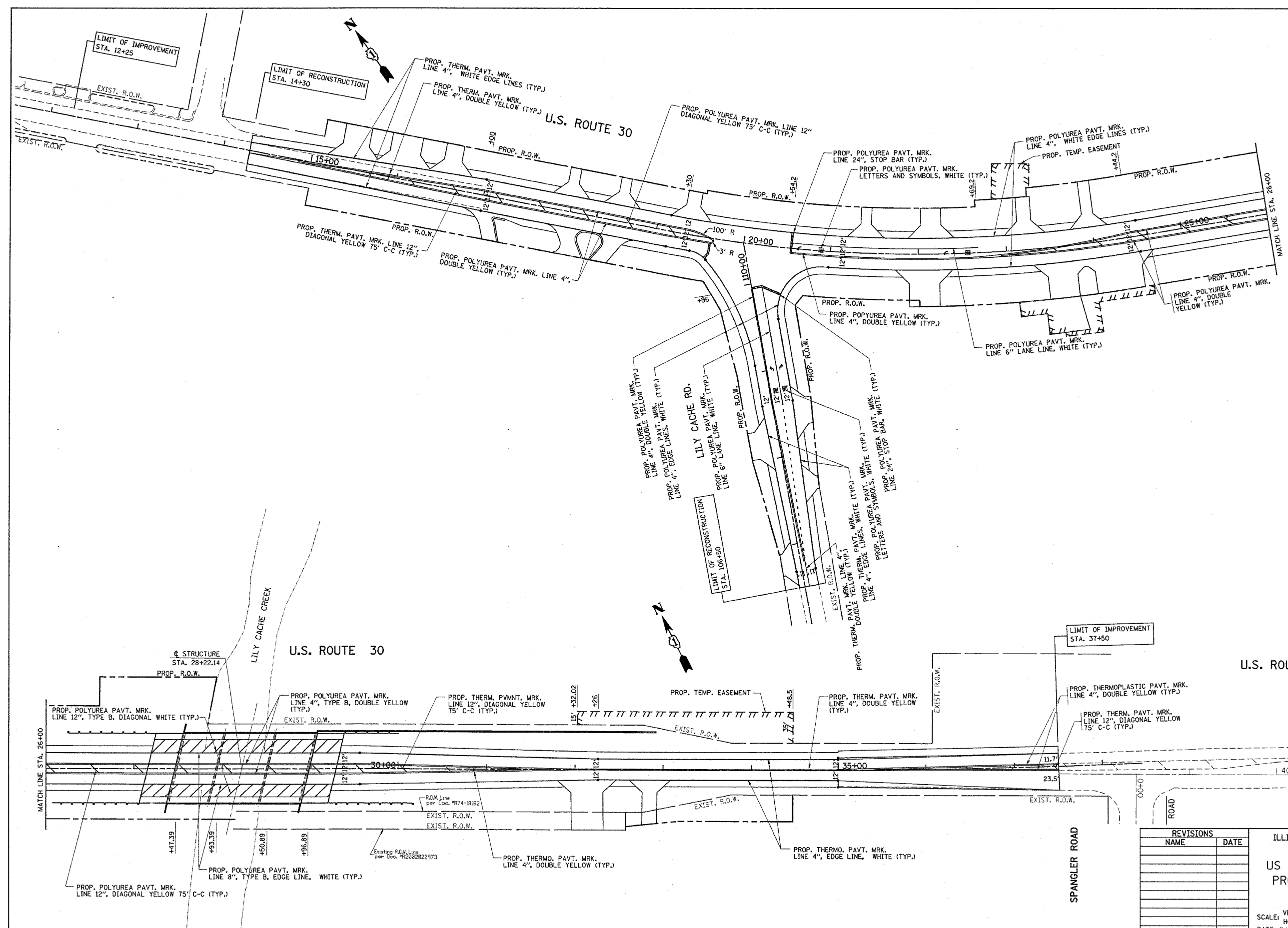

REVISIONS	
NAME	DATE

ILLINOIS DEPARTMENT OF TRANSPORTATION  
 US RTE 30 @ LILY CACHE ROAD  
 PROPOSED PAVEMENT MARKING  
 PLAN

SCALE: VERT.  
 HORIZ.  
 DATE 5/20/2005

DRAWN BY  
 CHECKED BY