

F.A.I. RTE. 94/90	SECTION	COUNTY COOK	TOTAL SHEETS 598	SHEET NO. 274
STA. 62302		TO STA. 1508+00		
FED. ROAD DIST. NO. ILLINOIS FED. AID PROJECT 62302 • (1818, ETC, 2324.6-1)PR-9				

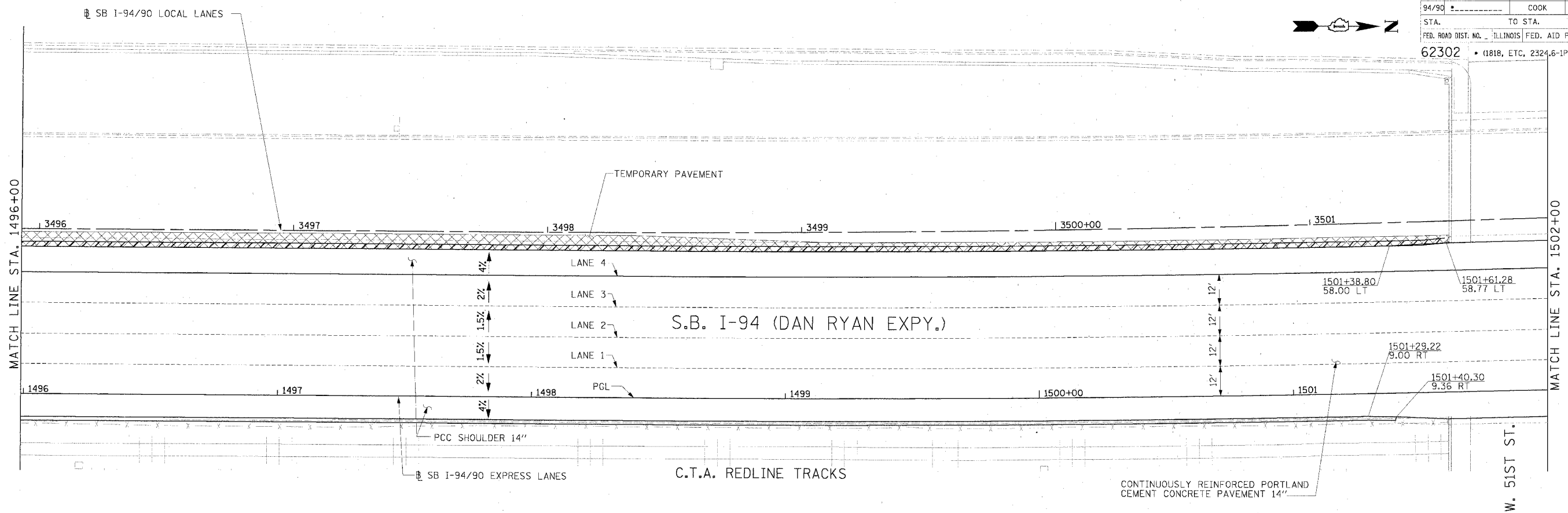

NOTE:
1. PAVEMENT ELEVATIONS ALONG RAMP, GORES AND IN AREAS OF SUPERELEVATION TRANSITION ARE PROVIDED AT 25' INTERVALS. FOR ALL OTHER ELEVATIONS, REFER TO PROFILE AND TYPICAL SECTIONS.

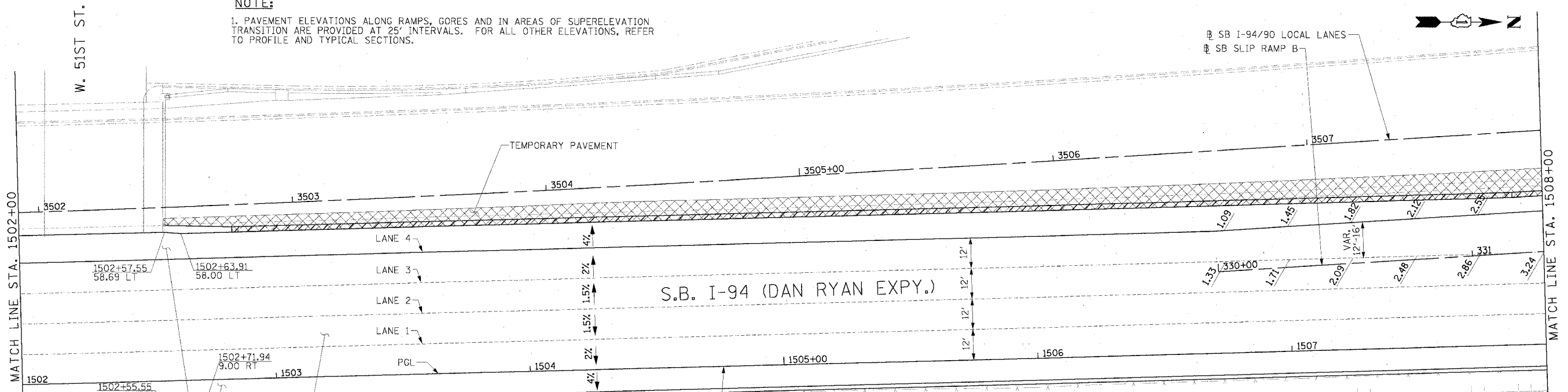

Edwards AND Kelcey
ONE NORTH FRANKLIN
CHICAGO, IL 60606
PHONE: (312) 251-3000
FAX: (312) 251-3015
WEB: WWW.EKCORP.COM

LEGEND
 ..* ELEVATION STATIONED OFF OF SB I-94/90 EXPRESS LANES
 (*.***) ELEVATION STATIONED OFF OF SB I-94/90 LOCAL LANES
 [*.**] ELEVATION STATIONED OFF OF SLIP RAMP ALIGNMENT

REVISIONS	
NAME	DATE

ILLINOIS DEPARTMENT OF TRANSPORTATION
 F.A.I. 94/90 (DAN RYAN EXPRESSWAY)
 31ST STREET TO 71ST STREET
 SB EXPRESS LANE RECONSTRUCTION
 PAVEMENT JOINTING AND ELEVATION PLAN
 SOUTHBOUND STA. 1496+00 TO STA. 1508+00
 SCALE: 0' 10' 20' 30' 40'
 DATE: 7/1/05
 DRAWN BY: TAI
 CHECKED BY: PJM

JT-12
 06/24/2005 8:11:36 AM