

|                     |         |                             |              |           |
|---------------------|---------|-----------------------------|--------------|-----------|
| F.A.I. RTE.         | SECTION | COUNTY                      | TOTAL SHEETS | SHEET NO. |
| 94/90               |         | COOK                        | 598          | 438       |
| STA.                |         | TO STA.                     |              |           |
| FED. ROAD DIST. NO. |         | ILLINOIS FED. AID PROJECT   |              |           |
| 62302               |         | • (1818, ETC, 2324.6-1P)R-9 |              |           |

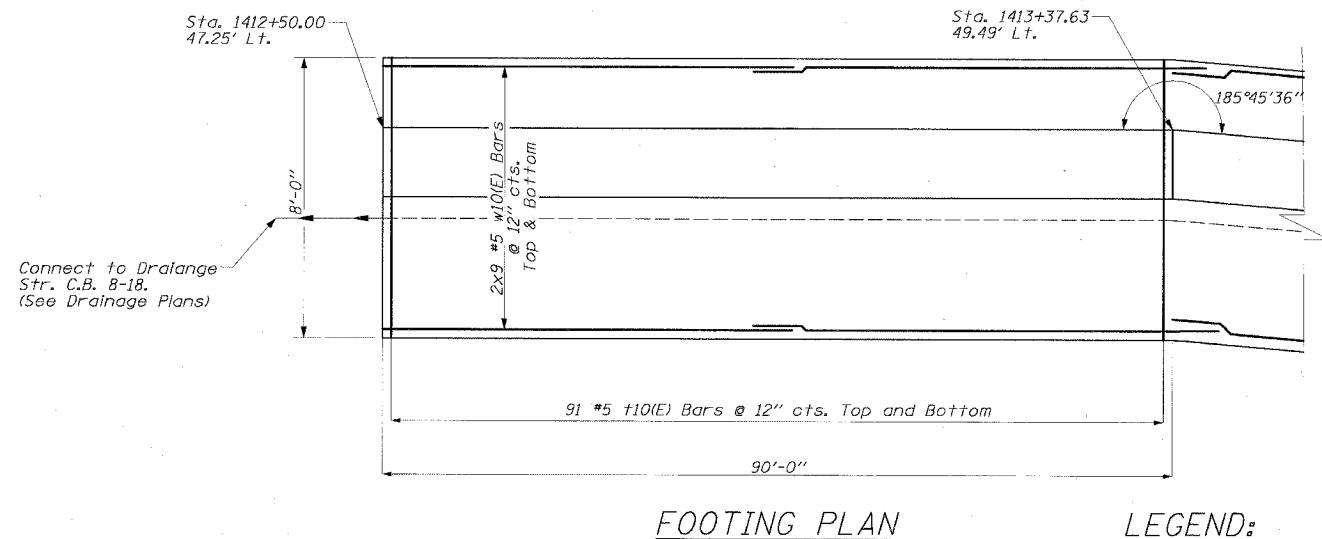
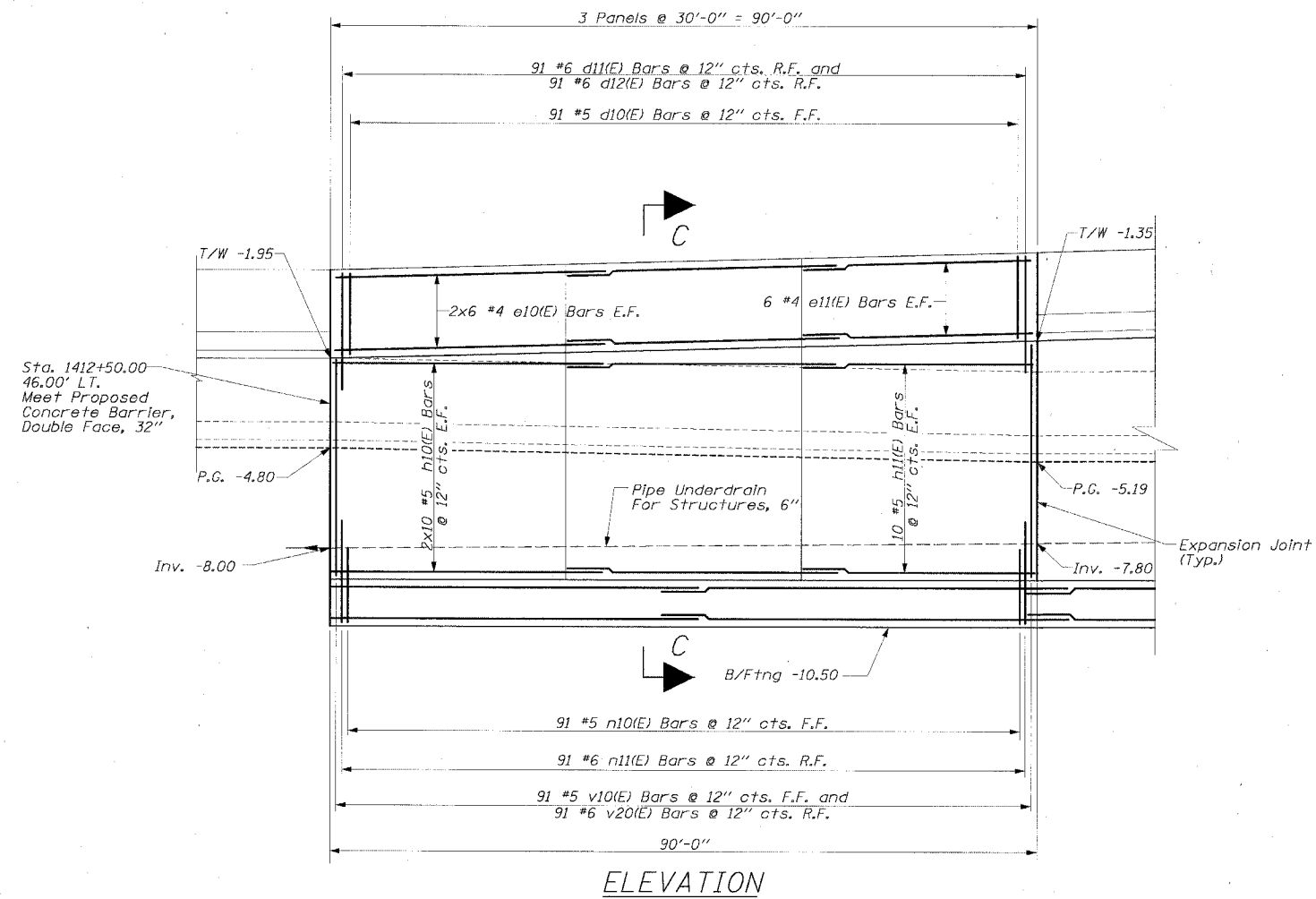

**LEGEND:**  
 B/Ftng = Bottom Of Footing Elev.  
 T/W = Top Of Wall Elev.  
 P.G. = Proposed Ground Elev.  
 Soil Boring Location  
 SSS-22

| REVISIONS |      |
|-----------|------|
| NAME      | DATE |
|           |      |
|           |      |
|           |      |
|           |      |
|           |      |
|           |      |
|           |      |
|           |      |
|           |      |
|           |      |

ILLINOIS DEPARTMENT OF TRANSPORTATION  
 F.A.I. 94/90 (DAN RYAN EXPRESSWAY)  
 31ST STREET TO 71ST STREET  
 SB EXPRESS LANE RECONSTRUCTION  
 RETAINING WALL SEL  
 GENERAL PLAN AND ELEVATION  
 SB STA. 1416+88.18 TO STA. 1421+97.41  
 STRUCTURE NO. NONE  
 SCALE: 1" = 20'  
 DATE: 07/17/05  
 DRAWN BY: ABW  
 CHECKED BY: EL

**Edwards AND Kelcey**  
 ONE NORTH FRANKLIN  
 CHICAGO, IL 60606  
 PHONE: (312) 251-3000  
 FAX: (312) 251-3015  
 WEB: WWW.EKCORP.COM

A:\030099\03\5\Con 1418\5\CAUD\5\Retaining Wall\Plans\6-Final\RetWall-04.dgn 06/24/2005 12:42:15 PM