

F.A.P. RTE.	SECTION	COUNTY	TOTAL SHEETS	SHEET NO.
066	21 (B&G) R	MCHENRY	66	58
STA. 110+00.00		TO STA. 112+50.00		

FED. AID PROJECT

CONTRACTOR TO RESTORE TEMPORARY PAVEMENT AREAS

#62391

90 80 70 60 50 40 30 20 10 0 10 20 30 40 50 60 70 80

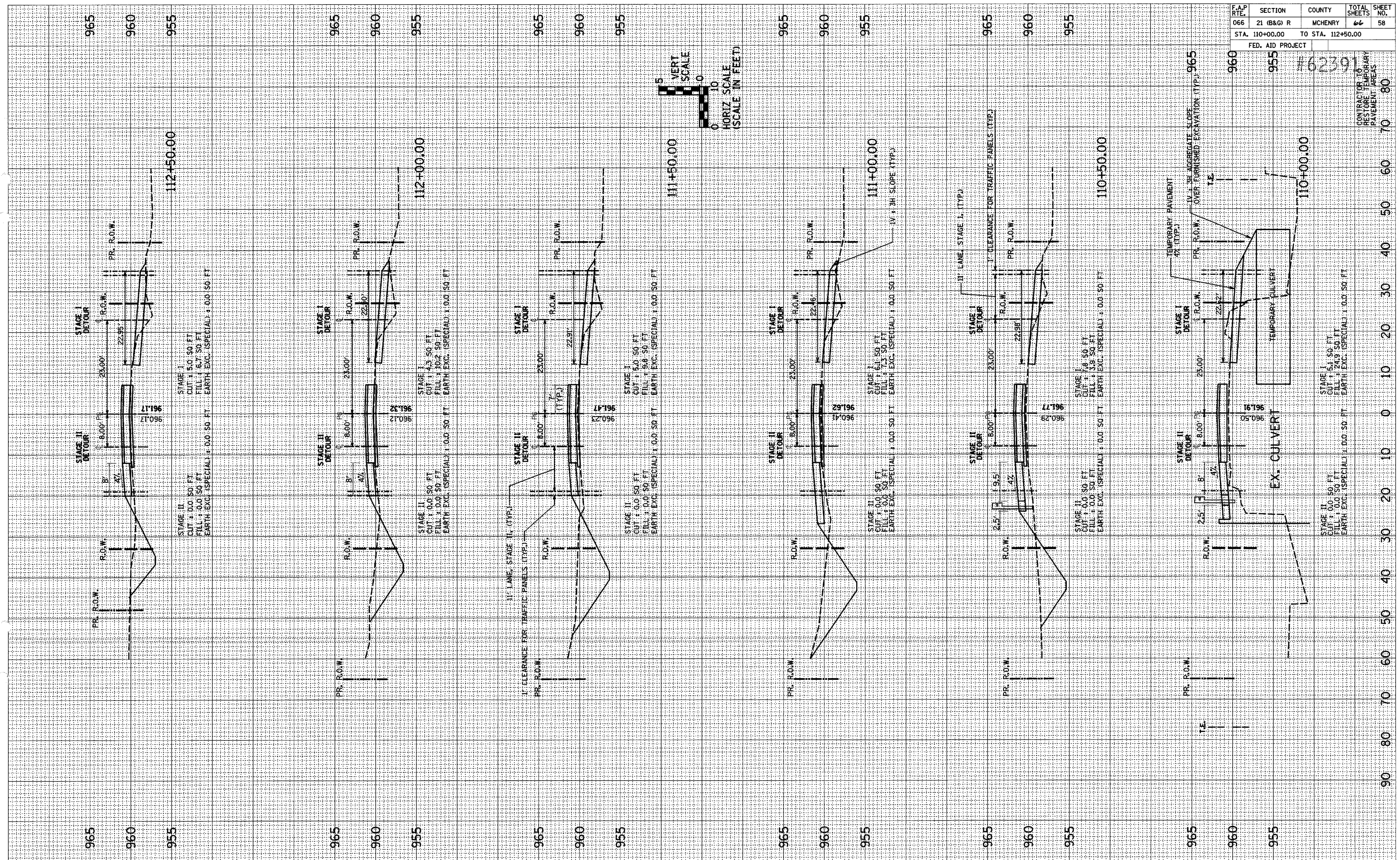

US ROUTE 14 STA. 110+00 TO STA. 112+50 TEMP. PAVEMENT