

STATE	SECTION	COUNTY	TOTAL SHEETS	SHEET NO.
94	2005-011E	COOK	40	37
STA.	TO STA.			
FED. ROAD DIST. NO. 1	ILLINOIS	FED. AID PROJECT		

62929

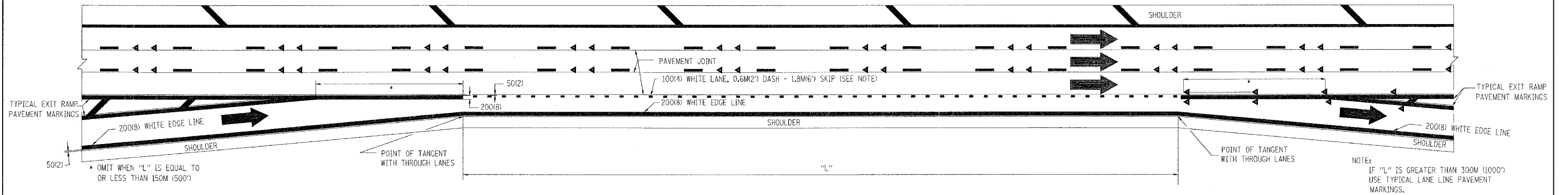

TYPICAL ENTRANCE/EXIT RAMP COMBINATION PAVEMENT MARKINGS

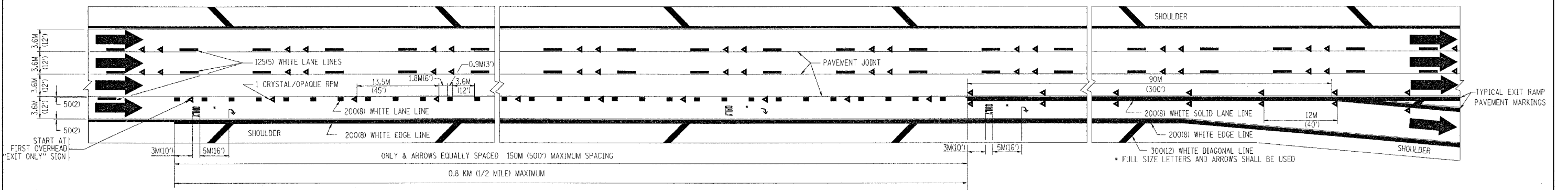

TYPICAL EXIT ONLY LANE PAVEMENT MARKINGS

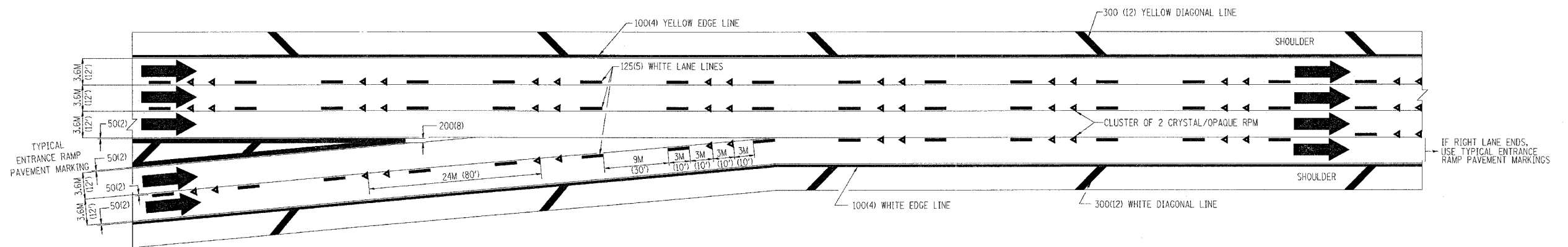

TYPICAL TWO LANE ENTRANCE RAMP PAVEMENT MARKINGS

REVISIONS	
NAME	DATE
DWS	1/90
DWS	5/91

ILLINOIS DEPARTMENT OF TRANSPORTATION

MULTI-LANE FREEWAY PAVEMENT MARKING DETAILS

SCALE: NONE
DATE: 5/31/2005

DRAWN BY C.A.D.D.
CHECKED BY

TC12 SHEET 2 OF 2

REVISION DATE: 01/01/96

1 11:00:30 03/21/2005