

F.A. RTE.	SECTION	COUNTY	TOTAL SHEETS	SHEET NO.
39	150-41	LASALLE	33	12
STA.		TO STA.		
FED. ROAD DIST. NO.		ILLINOIS	FED. AID PROJECT	

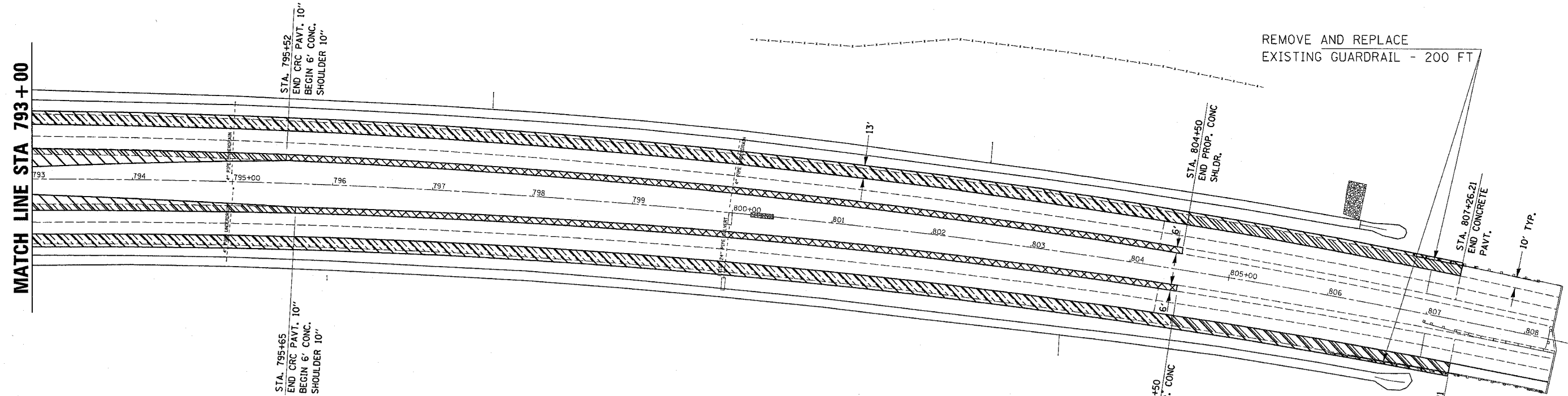

MATCH LINE STA 793+00



STA. 795+52  
END CRC PAVT. 10"  
BEGIN 6' CONC.  
SHOULDER 10"

STA. 795+65  
END CRC PAVT. 10"  
BEGIN 6' CONC.  
SHOULDER 10"

STA. 804+50  
END PROP. CONC  
SHLDR.

STA. 804+50  
END PROP. CONC  
SHLDR.

STA. 807+26.21  
END CONCRETE  
PAVT.

STA. 807+33.21  
END CONCRETE  
PAVT.

- PCC SHOULDER REMOVAL
- BITUMINOUS SHOULDER REMOVAL
- PROPOSED 10" CONCRETE SHOULDER
- CONTINUOUSLY REINFORCED PCC PVMT 10"

EXIST. CURVE 39CLS-1  
PI STA. = 806+74.99  
Δ = 21° 02' 26" (RT)  
D = 0° 44' 58"  
R = 7,644.15'  
T = 1,419.56'  
L = 2,807.14'  
E = 130.69'  
S = 130.69'  
T.R. = ----  
S.E. RUN = ----  
P.C. STA. = 792+55.43  
P.T. STA. = 820+62.57

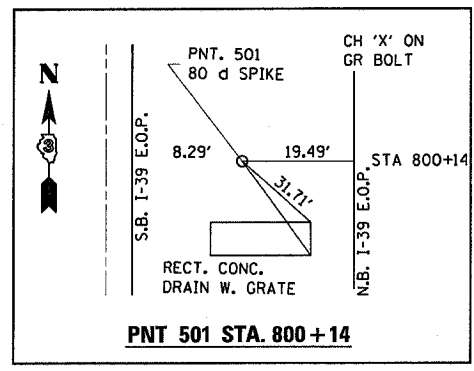

PNT 501 STA. 800+14

PLOT DATE = 4/22/2005  
 FILE NAME = #FILEL#  
 PLOT SCALE = #SCALE#  
 REFERENCE = #REF#

REVISIONS	
NAME	DATE

ILLINOIS DEPARTMENT OF TRANSPORTATION

## CROSSOVER PLAN SOUTH

SCALE: VERT. \_\_\_\_\_  
 HORIZ. \_\_\_\_\_

DATE \_\_\_\_\_ DRAWN BY \_\_\_\_\_  
 CHECKED BY \_\_\_\_\_