

| F.A.I. RTE. | SECTION | COUNTY | TOTAL SHEETS | SHEET NO. |
|-----------------------|---------|----------|-------------------|-----------|
| 412 | (50-5B) | LASALLE | 29 | 27 |
| FED. ROAD DIST. NO. _ | | ILLINOIS | STATE AID PROJECT | |

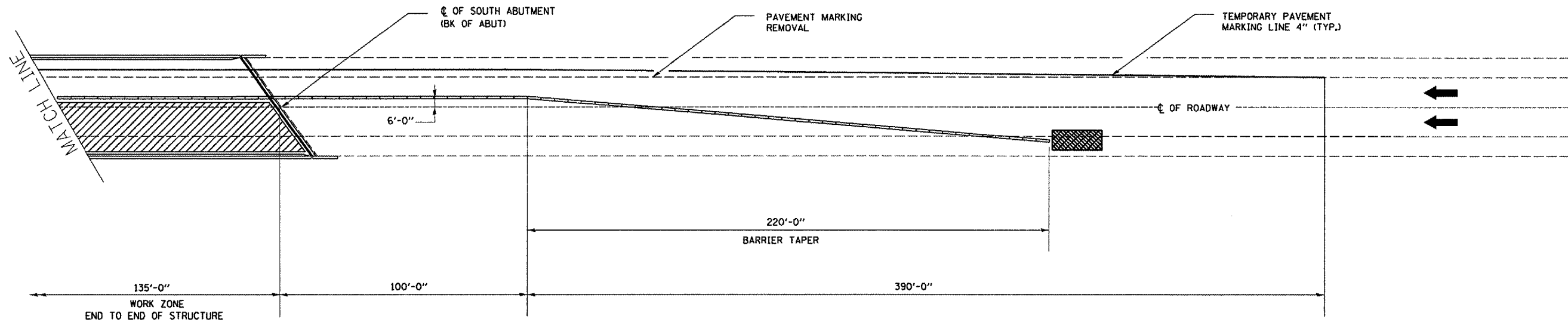

PLAN

LEGEND

- TEMPORARY CONCRETE BARRIER
- WORK ZONE
- IMPACT ATTENUATOR

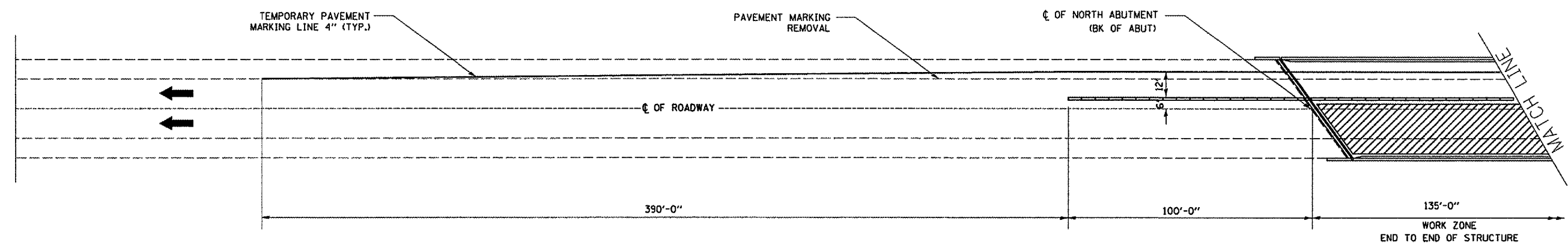

PLAN

WORK THIS SHEET WITH TRAFFIC CONTROL AND PROTECTION STANDARD 701402 (SPECIAL)

| REVISIONS | |
|-----------|------|
| NAME | DATE |
| | |
| | |
| | |
| | |
| | |
| | |
| | |
| | |
| | |

ILLINOIS DEPARTMENT OF TRANSPORTATION
TEMPORARY CONCRETE BARRIER
STAGE I
 F.A.I. 412 SOUTHBOUND
 OVER C. & N.W. RAILROAD
 SECTION (50-5B)I
 STA. 1216 + 43.45
 DATE 04/24/2005
 DRAWN BY RW
 CHECKED BY

MARCH 24, 2005
 C:\PROJECTS\CMA IN06\CM302\DETAILS.DGN