

EXIST. CURVE 733
 PI STA. = 5+66.29
 $\Delta = 90^\circ 00' 00''$ (RT)
 D = 71' 00' 17"
 R = 80.69'
 T = 80.69'
 L = 126.75'
 E = 33.42'
 e = NONE
 P.C. STA. = 4+85.59
 P.T. STA. = 6+12.34

EXIST. CURVE 735
 PI STA. = 8+51.36
 $\Delta = 25^\circ 33' 59''$ (LT)
 D = 29' 38' 20"
 R = 193.31'
 T = 43.86'
 L = 86.26'
 E = 4.91'
 e = NONE
 P.C. STA. = 8+07.50
 P.T. STA. = 8+93.76

EXIST. CURVE 736
 PI STA. = 12+09.35
 $\Delta = 34^\circ 23' 04''$ (LT)
 D = 14' 18' 24"
 R = 400.48'
 T = 123.91'
 L = 240.34'
 E = 18.73'
 e = NONE
 P.C. STA. = 10+85.44
 P.T. STA. = 13+25.77

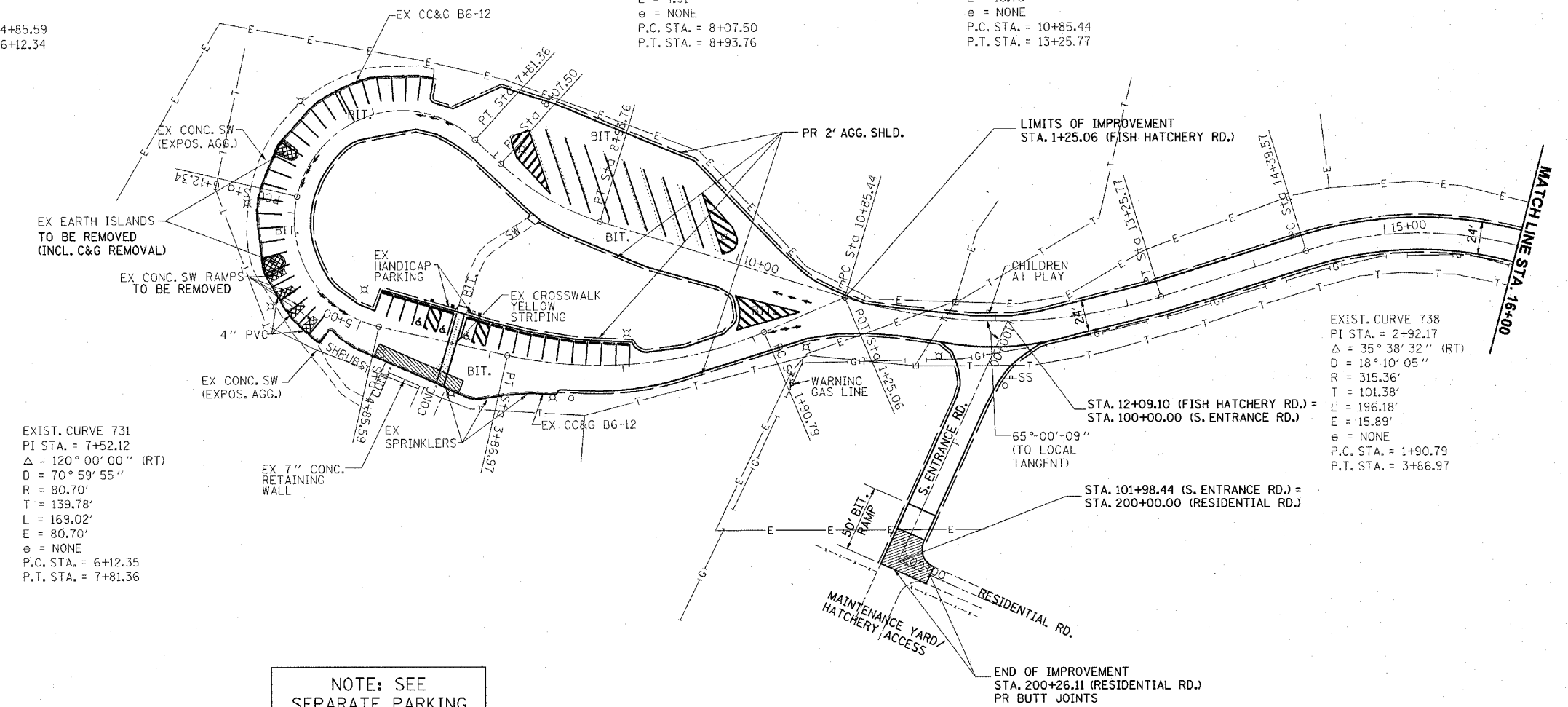

EXIST. CURVE 731
 PI STA. = 7+52.12
 $\Delta = 120^\circ 00' 00''$ (RT)
 D = 70' 59' 55"
 R = 80.70'
 T = 139.78'
 L = 169.02'
 E = 80.70'
 e = NONE
 P.C. STA. = 6+12.35
 P.T. STA. = 7+81.36

EXIST. CURVE 738
 PI STA. = 2+92.17
 $\Delta = 35^\circ 38' 32''$ (RT)
 D = 18' 10' 05"
 R = 315.36'
 T = 101.38'
 L = 196.18'
 E = 15.89'
 e = NONE
 P.C. STA. = 1+90.79
 P.T. STA. = 3+86.97

NOTE: SEE SEPARATE PARKING AREA DETAILS FOR MORE INFORMATION

REVISIONS		ILLINOIS DEPARTMENT OF TRANSPORTATION
NAME	DATE	
		JAKE WOLF MEMORIAL FISH HATCHERY ROAD AND PARKING AREA PLAN SHEETS

SCALE: VERT. HORIZ. DATE

DRAWN BY CHECKED BY

c:\projects\4654196\p&pf\fish_hatch.dgn
 2/9/2004
 *REF01