

EXIST. CURVE PSC12  
 PI STA. = 140+47.57  
 $\Delta = 3^\circ 44' 40''$  (LT)  
 $D = 1^\circ 23' 06''$   
 $R = 4,136.74'$   
 $T = 135.22'$   
 $L = 270.34'$   
 $E = 2.21'$   
 P.C. STA. = 139+12.35  
 P.T. STA. = 141+82.69

PROP. CURVE PSC12  
 PI STA. = 140+47.52  
 $\Delta = 3^\circ 44' 40''$  (LT)  
 $D = 1^\circ 23' 06''$   
 $R = 4,136.74'$   
 $T = 135.22'$   
 $L = 270.34'$   
 $E = 2.21'$   
 P.C. STA. = 139+12.30  
 P.T. STA. = 141+82.64

SE = 3.10%  
 SE TRANS:  
 LT STA 138+27.063 TO STA 139+67.290 (0.0% - -3.1%)  
 RT STA 138+27.063 TO STA 139+67.290 (0.0 - +3.1%)  
 LT STA 141+27.630 TO STA 142+75.689 (-3.1% - 0.0%)  
 RT STA 141+27.630 TO STA 142+75.689 (+3.1% - 0.0%)

EXIST. CURVE PSC13  
 PI STA. = 144+33.82  
 $\Delta = 2^\circ 01' 14''$  (RT)  
 $D = 0^\circ 58' 44''$   
 $R = 5,853.14'$   
 $T = 103.21'$   
 $L = 206.41'$   
 $E = 0.91'$   
 P.C. STA. = 143+30.60  
 P.T. STA. = 145+37.01

PROP. CURVE PSC13  
 PI STA. = 144+33.77  
 $\Delta = 2^\circ 01' 14''$  (RT)  
 $D = 0^\circ 58' 44''$   
 $R = 5,853.14'$   
 $T = 103.21'$   
 $L = 206.41'$   
 $E = 0.91'$   
 P.C. STA. = 143+30.55  
 P.T. STA. = 145+36.96

SE = 2.30%  
 SE TRANS:  
 LT STA 142+75.689 TO STA 143+85.540 (0.0% - -2.3%)  
 RT STA 142+75.689 TO STA 143+85.540 (0.0 - -2.3%)  
 LT STA 144+90.428 TO STA 145+78.139 (+2.3% - 0.0%)  
 RT STA 144+90.428 TO STA 145+78.139 (-2.3% - 0.0%)

EXIST. CURVE PSC14  
 PI STA. = 148+43.33  
 $\Delta = 32^\circ 29' 36''$  (LT)  
 $D = 18^\circ 16' 18''$   
 $R = 313.58'$   
 $T = 91.38'$   
 $L = 177.83'$   
 $E = 13.04'$   
 P.C. STA. = 147+51.95  
 P.T. STA. = 149+29.78

PROP. CURVE PSC14  
 PI STA. = 148+43.28  
 $\Delta = 32^\circ 29' 36''$  (LT)  
 $D = 18^\circ 16' 18''$   
 $R = 313.58'$   
 $T = 91.38'$   
 $L = 177.83'$   
 $E = 13.04'$   
 P.C. STA. = 147+51.90  
 P.T. STA. = 149+29.73

SE = 6.00%  
 SE TRANS:  
 LT STA 145+78.139 TO STA 148+06.950 (0.0% - -6.0%)  
 RT STA 145+78.139 TO STA 148+06.950 (0.0 - +6.0%)  
 LT STA 148+74.780 TO STA 149+84.780 (-6.0% - -2.0%)  
 RT STA 148+74.780 TO STA 150+94.780 (+6.0% - -2.0%)

STA. 138+00 TO STA. 138+50  
 STA. 139+00 TO STA. 140+00  
 STA. 140+50 TO STA. 142+90  
 PR TREE REMOVAL = 0.46 ACRES  
 NOTE : (1) MEASURED AREA FOR PAYMENT  
 3' OUTSIDE CONST. LIMITS  
 TO 3' OUTSIDE CONSTRUCTION LIMITS  
 (2) SAVE AS MANY TREES AS POSSIBLE

PLAN  
 SURVEYED BY: \_\_\_\_\_ DATE: \_\_\_\_\_  
 PLOTTED BY: \_\_\_\_\_  
 CHECKED BY: \_\_\_\_\_  
 CAD FILE NAME: \_\_\_\_\_  
 NO. \_\_\_\_\_

PROFILE  
 SURVEYED BY: \_\_\_\_\_ DATE: \_\_\_\_\_  
 PLOTTED BY: \_\_\_\_\_  
 CHECKED BY: \_\_\_\_\_  
 STRUCTURE NOTATION: CHRD  
 NO. \_\_\_\_\_

2/6/2004  
 v:\p\projects\654196\p\psandrdr1.dgn  
 \*REF01

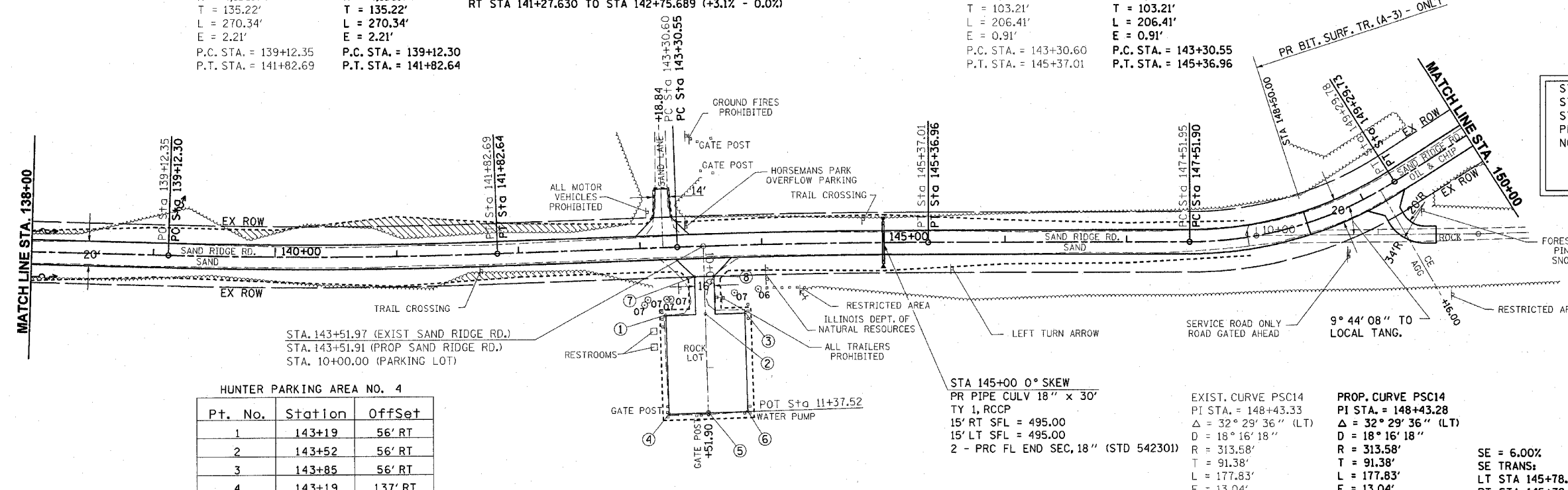

HUNTER PARKING AREA NO. 4

Pt. No.	Station	Offset
1	143+19	56' RT
2	143+52	56' RT
3	143+85	56' RT
4	143+19	137' RT
5	143+52	137' RT
6	143+85	137' RT
7	143+44	25' RT
8	143+60	25' RT

