

F.A. RTE.	SECTION	COUNTY	TOTAL SHEETS	SHEET NO.
	D-6 ITS #1	SANGAMON		11
STA.		TO STA.		
FED. ROAD DIST. NO.	ILLINOIS	FED. AID PROJECT		

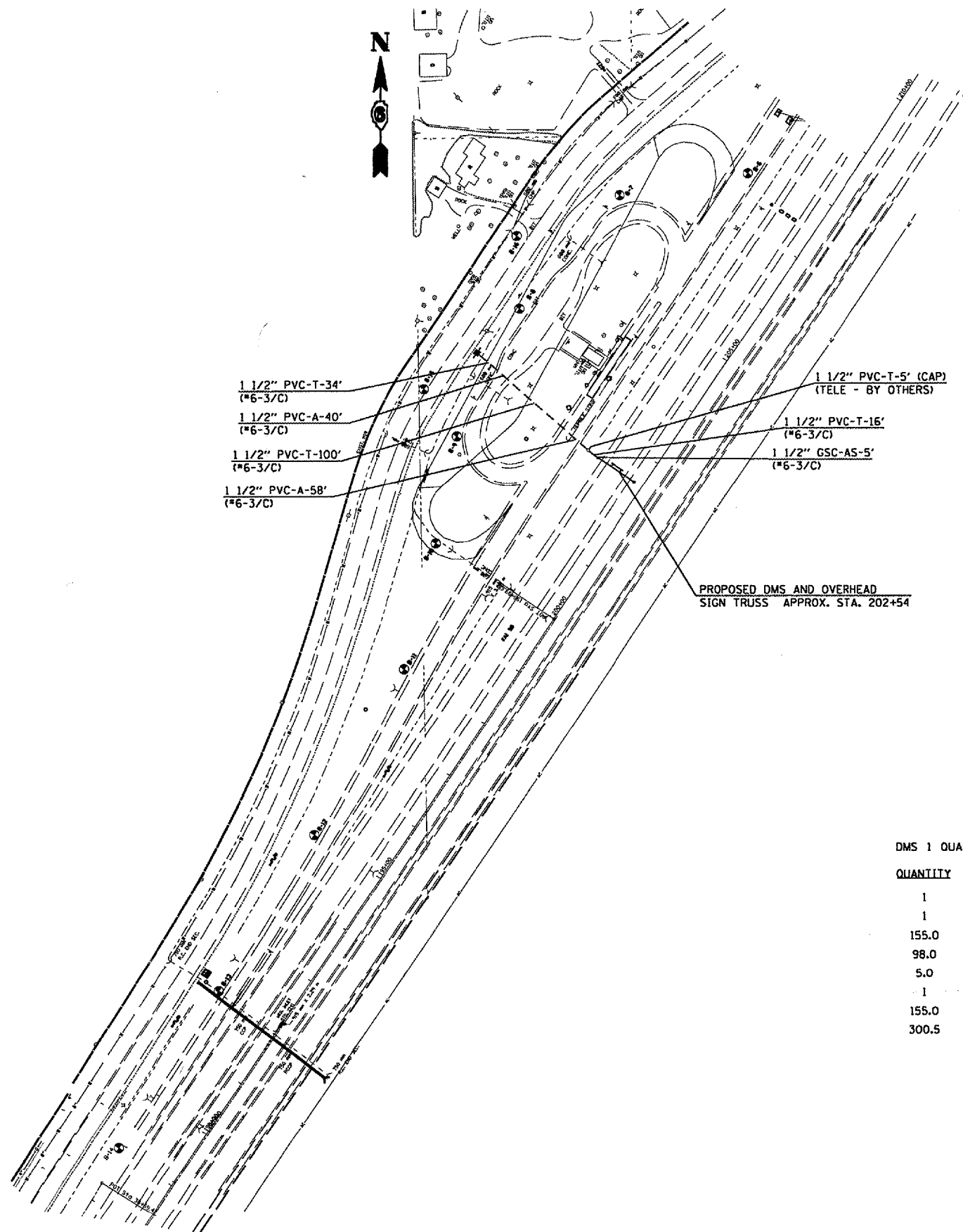

- 1 1/2" PVC-T-34' (*6-3/C)
- 1 1/2" PVC-A-40' (*6-3/C)
- 1 1/2" PVC-T-100' (*6-3/C)
- 1 1/2" PVC-A-58' (*6-3/C)
- 1 1/2" PVC-T-5' (CAP) (TELE - BY OTHERS)
- 1 1/2" PVC-T-16' (*6-3/C)
- 1 1/2" GSC-AS-5' (*6-3/C)

PROPOSED DMS AND OVERHEAD SIGN TRUSS APPROX. STA. 202+54

DMS 1 QUANTITIES

QUANTITY	UNIT
1	EACH
1	EACH
155.0	FOOT
98.0	FOOT
5.0	FOOT
1	EACH
155.0	FOOT
300.5	FOOT

ITEM
SERVICE INSTALLATION, TYPE A ✓
WOOD POLE, 25 FT., CLASS 4 ✓
CONDUIT IN TRENCH, 1 1/2" DIA., PVC ✓
CONDUIT, AUGERED, 1 1/2" DIA., PVC ✓
CONDUIT ATTACHED TO STRUCTURE, 1 1/2" DIA., GALVANIZED STEEL ✓
JUNCTION BOX (SPECIAL) ✓
TRENCH AND BACKFILL FOR ELECTRICAL WORK ✓
ELECTRIC CABLE IN CONDUIT, SERVICE, NO. 6 3/C ✓

PLOT DATE: * DATE *
 FILE NAME: * FILE *
 PLOT SCALE: * SCALE *
 USER NAME: * USER *

REVISIONS	
NAME	DATE

ILLINOIS DEPARTMENT OF TRANSPORTATION
DMS 1 PLAN VIEW
 D-6 ITS
 SANGAMON COUNTY
 SCALE: VERT. 1" = 100'
 HORIZ. 1" = 100'
 DATE: MAY 2005
 DRAWN BY: KDA
 CHECKED BY: