

F.A.P. RTE.	SECTION	COUNTY	TOTAL SHEETS	SHEET NO.
2	202-2RS-1	MADISON	9	5
STA. 1198+99.05 TO STA. 1203+00.00				
FED. ROAD DIST. NO. ILLINOIS FED. AID PROJECT				

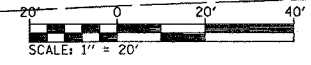

PROP. CURVE RTE3-1  
 PI STA. = 1198+73.95  
 $\Delta = 1^\circ 28' 44''$  (RT)  
 D =  $1^\circ 00' 00''$   
 R = 5,729.57'  
 T = 73.95'  
 L = 147.90'  
 E = 0.48'  
 T.R. = -----  
 S.E. RUN = -----  
 P.C. STA = 1198+00.00  
 P.T. STA = 1199+47.90

PROP. CURVE RTE3-2  
 PI STA. = 1201+92.62  
 $\Delta = 6^\circ 01' 11''$  (RT)  
 D =  $1^\circ 13' 52''$   
 R = 4,654.17'  
 T = 244.72'  
 L = 488.99'  
 E = 6.43'  
 T.R. = -----  
 S.E. RUN = -----  
 P.C. STA = 1199+47.90  
 P.T. STA = 1204+36.89  
 SUPER ATTAINED:  
 MATCH BRIDGE SUPER (1%) @ 1198+45.29 - 1200+21.23  
 (1202+90.22 - 1205+10.22)

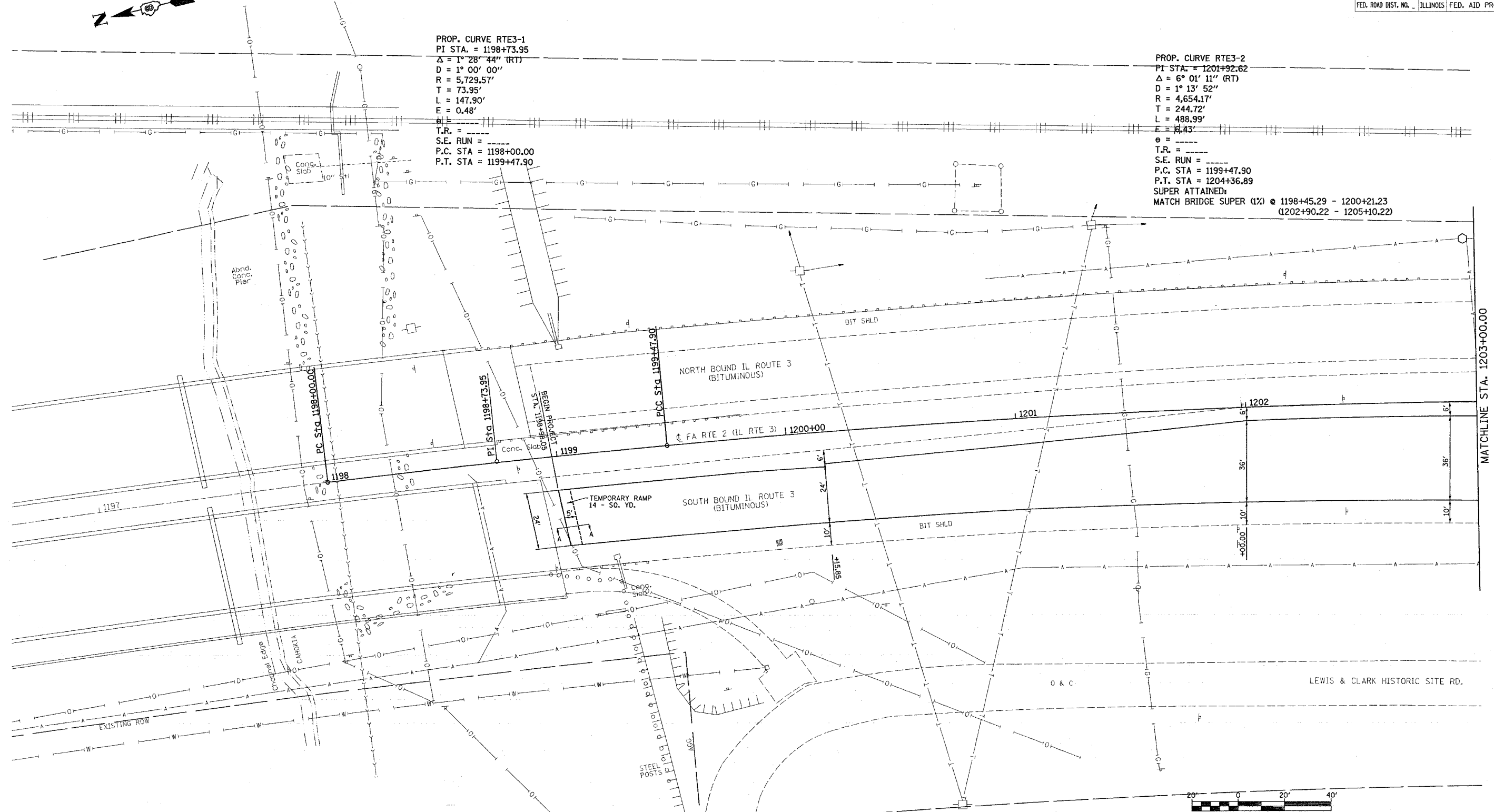

REVISIONS	
NAME	DATE

ILLINOIS DEPARTMENT OF TRANSPORTATION  
**PLAN VIEW**  
 FAP ROUTE 2  
 SECTION 202-2RS-1  
 MADISON COUNTY  
 SCALE: \_\_\_\_\_  
 DATE \_\_\_\_\_  
 DRAWN BY \_\_\_\_\_  
 CHECKED BY \_\_\_\_\_

PLOT DATE = 5/17/2005  
 FILE NAME = c:\projects\76954\plan\plan1198196a.dgn  
 PLOT SCALE = 1" = 20'  
 REFERENCE = 48624