

F.A.P. RTE.	SECTION	COUNTY	TOTAL SHEETS	SHEET NO.
2	202-2RS-1	MADISON	9	1

STATE OF ILLINOIS  
DEPARTMENT OF TRANSPORTATION  
DIVISION OF HIGHWAYS

**PROPOSED  
HIGHWAY PLANS**

FAP ROUTE 2 (IL 3)  
SECTION 202-2RS-1  
PROJECT: HS-0002(070)  
MADISON COUNTY

SKID PROOFING AT THE INTERSECTION  
OF ROUTE 3 AND NEW POAG ROAD

C-98-122-05

SEE SHEET 2 FOR INDEX OF SHEETS

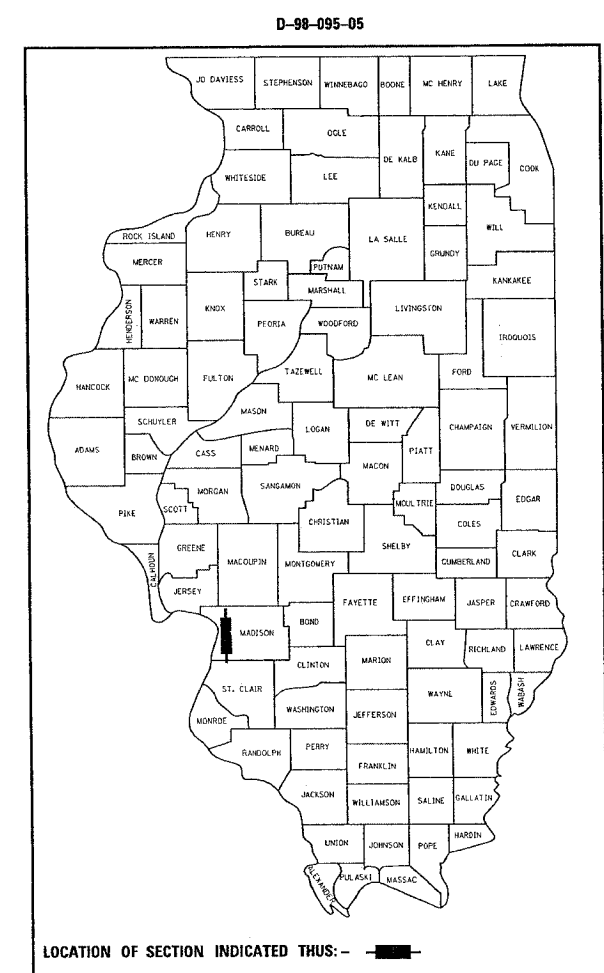

BEGIN PROJECT  
STA. 1198 + 99.05  
LAT. 38.80440  
LONG. -90.09915

END PROJECT  
STA. 1208 + 40.00  
LAT. 38.80359  
LONG. -90.09932

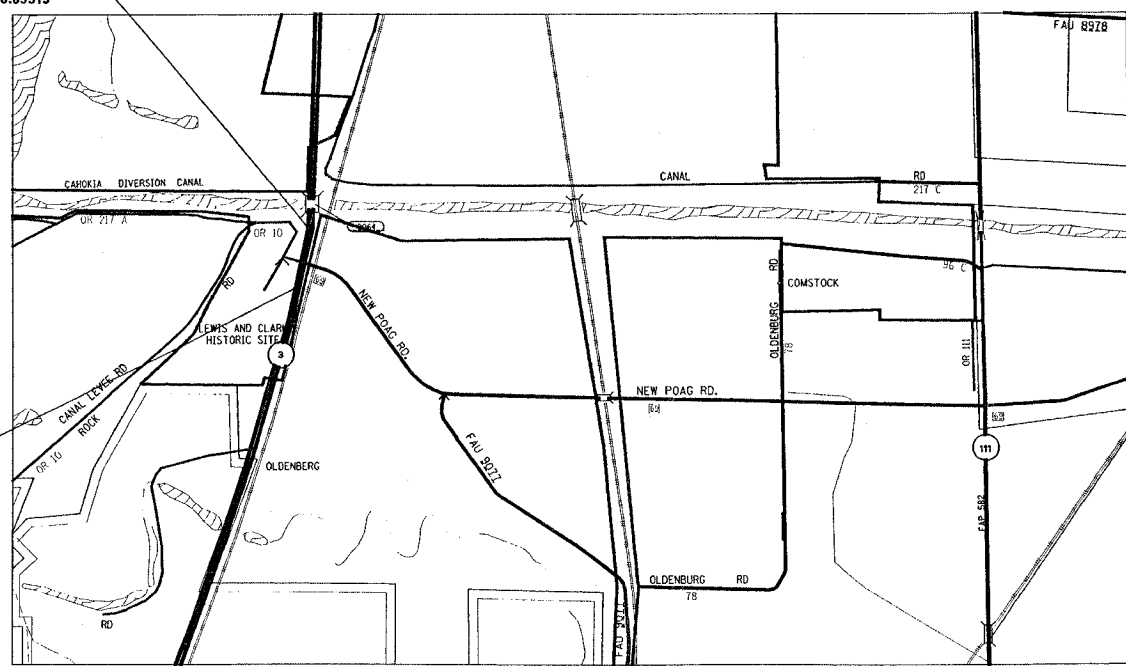

SCALE: 1" = 5 MILES

GROSS LENGTH: 0.178 MILES (940.95 FT.)  
NET LENGTH: 0.178 MILES (940.95 FT.)

ADT	
2003	18,800
S.U.	3.2%
M.U.	7.8%

MICROFILMED \_\_\_\_\_  
REEL NUMBER \_\_\_\_\_  
AWARDED \_\_\_\_\_  
RESIDENT ENGINEER \_\_\_\_\_  
AS BUILT CHANGES WERE MADE  
ON THE FOLLOWING SHEETS \_\_\_\_\_

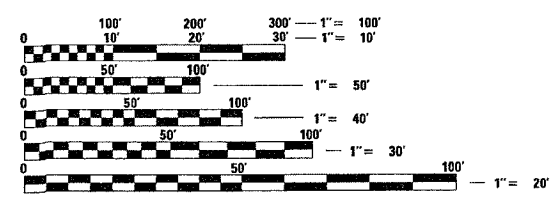

FULL SIZE PLANS HAVE BEEN PREPARED USING STANDARD ENGINEERING SCALES. REDUCED SIZED PLANS WILL NOT CONFORM TO STANDARD SCALES. IN MAKING MEASUREMENTS ON REDUCED PLANS, THE ABOVE SCALES MAY BE USED.

J.U.L.I.E.  
JOINT UTILITY LOCATION INFORMATION FOR EXCAVATION  
1-800-892-0123

CONTRACT NO. 76954

STATE OF ILLINOIS  
DEPARTMENT OF TRANSPORTATION  
DIVISION OF HIGHWAYS

SUBMITTED May 13 2005  
Mike Ramie  
DEPUTY DIRECTOR OF HIGHWAYS  
REGION FIVE ENGINEER

July 1 2005  
Mike Nune  
ENGINEER OF DESIGN AND ENVIRONMENT

July 1 2005  
Victor Mader  
DIRECTOR, DIVISION OF HIGHWAYS

**PRINTED BY THE AUTHORITY  
OF THE STATE OF ILLINOIS**

PROJECT ENGINEER: WENDA SOUTHERLAND (618) 346-3159  
SQUAD LEADER: BRIAN COURTWRIGHT (618) 346-3192

F.A.P. RTE.	SECTION	COUNTY	TOTAL SHEETS	SHEET NO.
2	202-2RS-1	MADISON	9	2
STA. _____		TO STA. _____		
FED. ROAD DIST. NO. _____		ILLINOIS FED. AID PROJECT		

GENERAL NOTES

- SAW CUTTING ON ALL EDGES FOR REMOVAL ITEMS SHALL BE INCLUDED IN THE COST OF THE REMOVAL ITEM AS INDICATED AND IN ACCORDANCE WITH SECTION 440 OF THE STANDARD SPECIFICATIONS.
- IF ANY SECTION OR SUB-SECTION MONUMENTS ARE ENCOUNTERED, THE ENGINEER SHALL BE NOTIFIED BEFORE SUCH MONUMENTS ARE REMOVED OR RESURFACED OVER. THE CONTRACTOR SHALL PROTECT AND CAREFULLY PRESERVE ALL PROPERTY MARKERS AND MONUMENTS UNTIL THE OWNER, AN AUTHORIZED SURVEYOR, OR AGENT HAS WITNESSED OR OTHERWISE REFERENCED THEIR LOCATION.
- EXCESS BITUMINOUS REMOVAL SHALL BE PAID FOR ACCORDING TO ARTICLE 109.04 OF THE STANDARD SPECIFICATIONS.
- MIXTURES FOR JOINTS, CRACKS, AND FLANGWAYS SHALL BE PAID FOR ACCORDING TO ARTICLE 109.04 OF THE STANDARD SPECIFICATIONS.
- THE THICKNESS OF THE BITUMINOUS MIXTURE SHOWN ON THE PLANS IS THE NOMINAL THICKNESS. DEVIATIONS FROM THE NOMINAL THICKNESS WILL BE PERMITTED WHEN SUCH DEVIATIONS OCCUR DUE TO IRREGULARITIES IN THE EXISTING SURFACE OR BASE ON WHICH THE BITUMINOUS MIXTURE IS PLACED.
- THE THICKNESS OF BITUMINOUS SURFACE REMOVAL IS THE REMOVAL DEPTH OF 1 1/2" AT THE CENTERLINE. THE REMOVAL DEPTH VARIES FROM 1/4" TO 2 1/4". AN ESTIMATED 345 TONS OF BITUMINOUS SURFACE WILL BE REMOVED.
- ILLINOIS STATE LAW REQUIRES A 48-HOUR NOTICE BE GIVEN TO ALL UTILITIES BEFORE DIGGING. FIELD MARKING OF FACILITIES MAY BE OBTAINED BY CONTACTING J.U.L.I.E. OR FOR NON-MEMBERS, THE UTILITY COMPANY DIRECTLY. AGENCIES KNOWN TO HAVE FACILITIES WITHIN THE PROJECT AREA ARE AS FOLLOWS:
  - AMEREN IP (BURIED)
  - AMEREN UE (AERIAL)
  - BUCKEYE PIPE LINE COMPANY (BURIED)
  - CHARTER COMMUNICATIONS (BURIED)
  - VILLAGE OF HARTFORD (BURIED)
  - KOCH PIPELINE COMPANY, LP (BURIED)
  - LACLEDE PIPELINE CORP. (BURIED)
  - SBC (BURIED)
  - ST. LOUIS PIPELINE (BURIED)
  - WILTEL COMMUNICATIONS, LLC (BURIED)

MEMBERS OF J.U.L.I.E. (800)-892-0123 ARE INDICATED BY •. NON J.U.L.I.E. MEMBERS MUST BE NOTIFIED INDIVIDUALLY.
- ALL TEMPORARY PAVEMENT MARKINGS WILL BE PLACED IN SUCH A MANNER SO AS NOT TO INTERFERE WITH THE PLACEMENT OF PERMANENT PAVEMENT MARKINGS.
- EXCEPT WHERE DESIGNATED OTHERWISE, THE LOCATIONS AND/OR DEPTHS OF UNDERGROUND UTILITIES SHOWN HAVE BEEN TAKEN FROM OFFICE RECORD INFORMATION FURNISHED BY THE UTILITY OWNERS AND MUST BE CONSIDERED APPROXIMATE.
- THE CONTRACTOR SHALL BE AWARE THAT THERE ARE MANHOLES & VALVES LOCATED WITHIN THE RESURFACING LIMITS. CARE SHALL BE TAKEN IN THESE LOCATIONS DURING MILLING OPERATIONS.
- THE CONTRACTOR SHALL VERIFY ALL DIMENSIONS AND CONDITIONS IN THE FIELD PRIOR TO CONSTRUCTION AND ORDERING OF MATERIALS.
- NO OVERNIGHT LANE CLOSURES WILL BE ALLOWED.
- "ROAD CONSTRUCTION AHEAD" SIGNS SHALL BE PLACED AT THE BEGINNING AND END OF THE PROJECT PLUS THE INTERSECTING SIDE ROADS, AND WILL BE INCLUDED IN THE TRAFFIC CONTROL PAY ITEMS. ALL CONSTRUCTION SIGNS SHALL BE FLUORESCENT ORANGE.
- FLAGMEN SHALL BE PRESENT DURING ALL CLOSURE HOURS, INCLUDING LUNCH HOUR, AND NO ADDITIONAL COMPENSATION SHALL BE APPLIED.
- THE PROJECT LOCATION IS A RAILROAD INTERCONNECT LOCATION. IDOT COMMUNICATIONS AND OPERATIONS ELECTRICAL UNIT MUST BE NOTIFIED WHEN WORK AFFECTING THE TRAFFIC SIGNAL IS UNDERWAY. THE DETECTOR LOOPS SHALL BE REPLACED 72 HOURS AFTER THE MILLING OPERATION.

INDEX OF SHEETS

- COVER SHEET
- GENERAL NOTES AND STANDARDS
- SUMMARY OF QUANTITIES
- TYPICAL SECTIONS
- PLAN SHEETS
- PAVEMENT MARKING PLANS
- TRAFFIC SIGNAL PLANS

COMMITMENTS:

COMMITMENTS FOR THIS PROJECT ARE AS FOLLOWS:  
NONE

LIST OF STANDARDS

- 001006
- 000001-04
- 701101-01
- 701106-01
- 701421-01
- 701426-02
- 701701-04
- 702001-05
- 780001-01
- 781001-02

PLOT DATE = 5/17/2006  
 FILE NAME = \\s01\p18095\p18095\p18095.dgn  
 PLOT SCALE = 5/8"=1'-0" / IN.  
 REFERENCE = #REF#

REVISIONS	
NAME	DATE

ILLINOIS DEPARTMENT OF TRANSPORTATION  
**GENERAL NOTES  
 AND STANDARDS**  
 FAP ROUTE 2  
 SECTION 202-2RS-1  
 MADISON COUNTY

SCALE: VERT.  
 HORIZ.  
 DATE

DRAWN BY  
 CHECKED BY



F.A.P. RTE.	SECTION	COUNTY	TOTAL SHEETS	SHEET NO.
2	202-2RS-1	MADISON	9	4
STA. _____ TO STA. _____		FED. ROAD DIST. NO. - ILLINOIS FED. AID PROJECT		

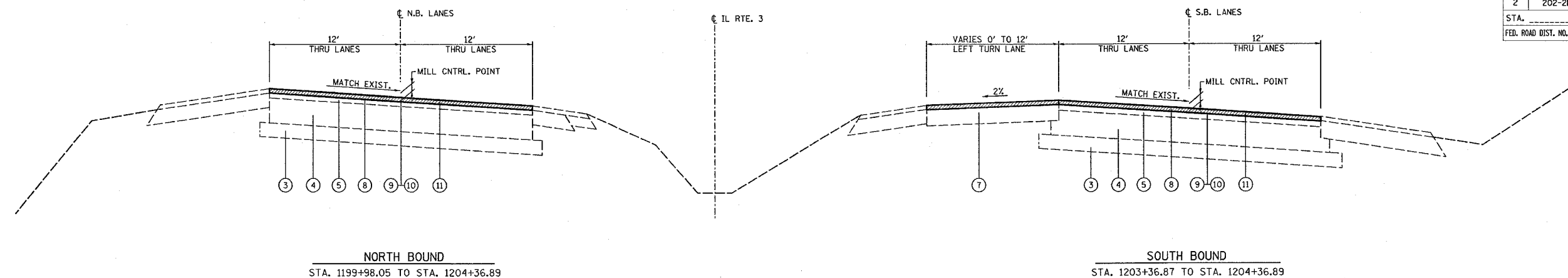

TYPICAL SECTION  
IL. ROUTE 3

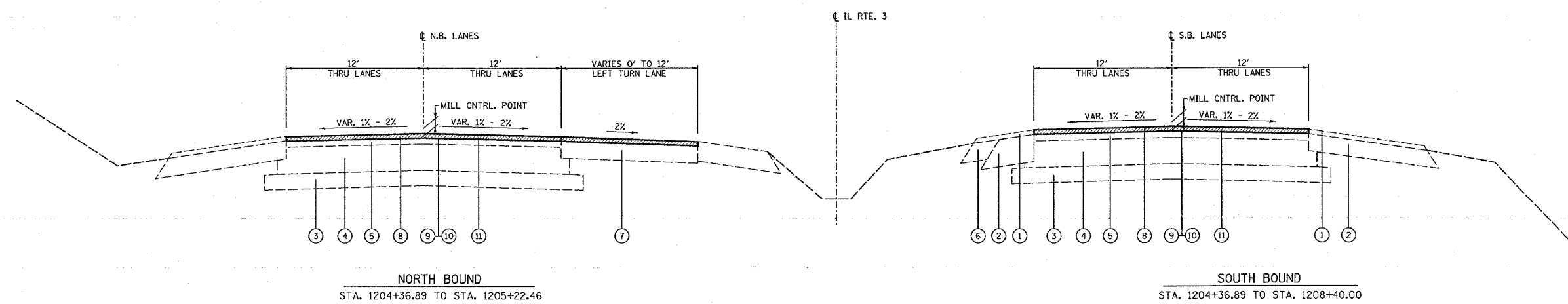

TYPICAL SECTION  
IL. ROUTE 3

**LEGEND**

- ① EXISTING BITUMINOUS SHOULDER OVERLAY
- ② EXISTING BITUMINOUS SHOULDER STABILIZATION - 10"
- ③ EXISTING SUB-BASE
- ④ EXISTING GRAVEL OR CRUSHED STONE BASE, TYPE A
- ⑤ EXISTING BITUMINOUS RESURFACING - 9"
- ⑥ EXISTING BITUMINOUS SHOULDER - 6"
- ⑦ EXISTING P.C.C. BASE COURSE - 9"
- ⑧ PROPOSED BITUMINOUS SURFACE REMOVAL - 1 1/2"
- ⑨ PROPOSED BITUMINOUS MATERIAL (PRIME COAT)
- ⑩ PROPOSED AGGREGATE (PRIME COAT)
- ⑪ PROPOSED BITUMINOUS SURFACE COURSE - 1 1/2"

MIXTURE REQUIREMENT CHART

MIXTURE USE	SURFACE
AC/PG	SBS 76-22
RAP % (MAX)	0%
DESIGN AIR Voids	4.0% @ Ndes=90
MIX COMPOSITION (GRADATION MIXTURE)	
FRICTION AGG	MIXTURE F

REVISIONS	
NAME	DATE

ILLINOIS DEPARTMENT OF TRANSPORTATION  
**TYPICAL SECTIONS**  
FAP ROUTE 2  
SECTION 202-2RS-1  
MADISON COUNTY

SCALE: VERT. \_\_\_\_\_  
HORIZ. \_\_\_\_\_

DATE \_\_\_\_\_ DRAWN BY \_\_\_\_\_  
CHECKED BY \_\_\_\_\_

PLOT DATE = 5/17/2005  
FILE NAME = c:\projects\76954\plan\ch04\9505a.dgn  
PLOT SCALE = 5/8"=1'-0"  
REFERENCE = 0

F.A.P. RTE.	SECTION	COUNTY	TOTAL SHEETS	SHEET NO.
2	202-2RS-1	MADISON	9	5
STA. 1198+99.05 TO STA. 1203+00.00				
FED. ROAD DIST. NO. ILLINOIS FED. AID PROJECT				



PROP. CURVE RTE3-1  
 PI STA. = 1198+73.95  
 $\Delta = 1^\circ 28' 44''$  (RT)  
 D =  $1^\circ 00' 00''$   
 R = 5,729.57'  
 T = 73.95'  
 L = 147.90'  
 E = 0.48'  
 T.R. = -----  
 S.E. RUN = -----  
 P.C. STA = 1198+00.00  
 P.T. STA = 1199+47.90

PROP. CURVE RTE3-2  
 PI STA. = 1201+92.62  
 $\Delta = 6^\circ 01' 11''$  (RT)  
 D =  $1^\circ 13' 52''$   
 R = 4,654.17'  
 T = 244.72'  
 L = 488.99'  
 E = 6.43'  
 T.R. = -----  
 S.E. RUN = -----  
 P.C. STA = 1199+47.90  
 P.T. STA = 1204+36.89  
 SUPER ATTAINED:  
 MATCH BRIDGE SUPER (1%) @ 1198+45.29 - 1200+21.23  
 (1202+90.22 - 1205+10.22)

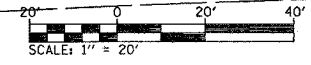
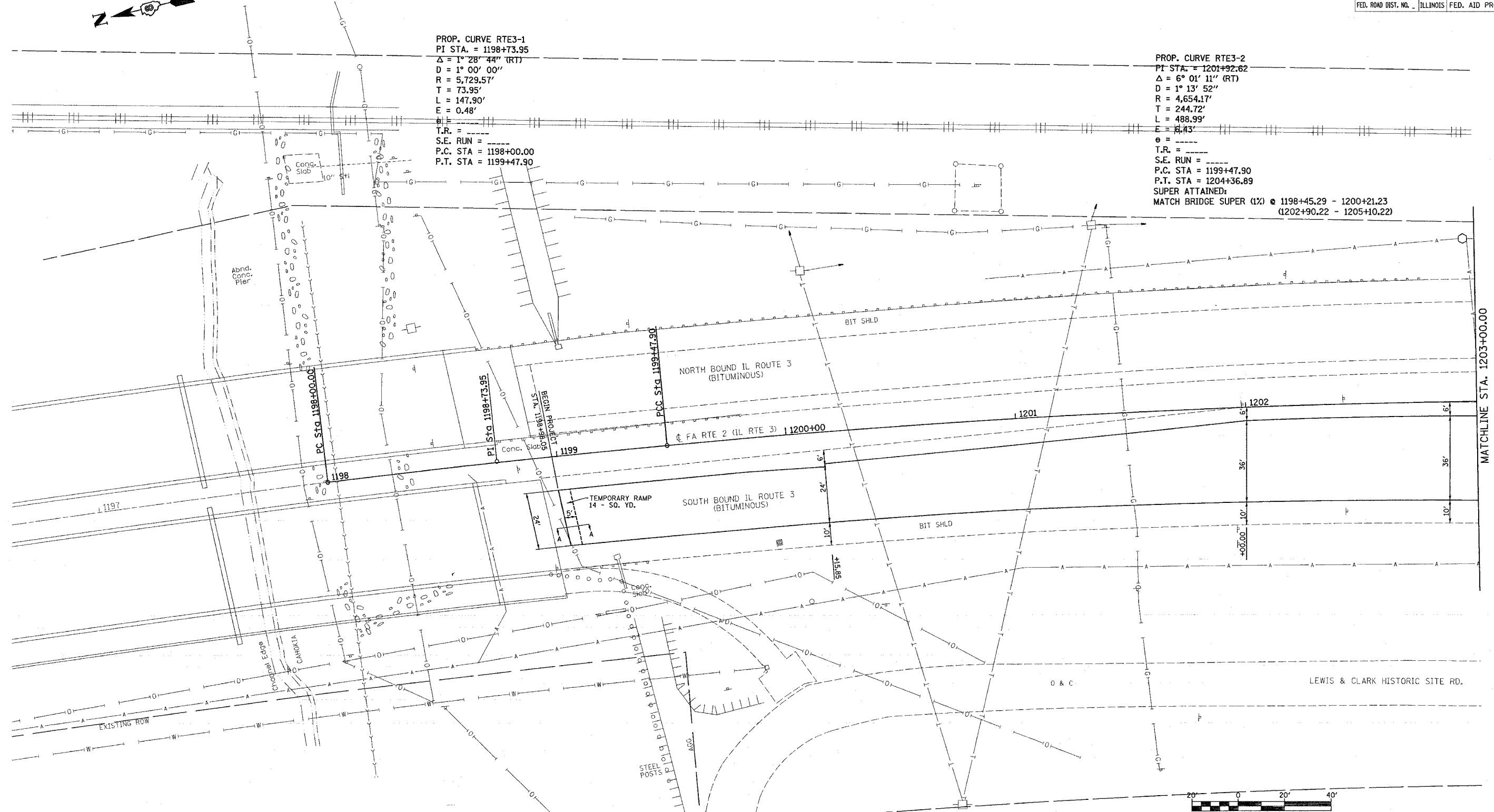

REVISIONS	
NAME	DATE

ILLINOIS DEPARTMENT OF TRANSPORTATION  
**PLAN VIEW**  
 FAP ROUTE 2  
 SECTION 202-2RS-1  
 MADISON COUNTY  
 SCALE: \_\_\_\_\_ DRAWN BY \_\_\_\_\_  
 DATE \_\_\_\_\_ CHECKED BY \_\_\_\_\_

PLOT DATE = 5/17/2005  
 FILE NAME = c:\projects\76954\plan\plan19956a.dgn  
 PLOT SCALE = 1" = 20'  
 REFERENCE = 48624

F.A.P. RTE.	SECTION	COUNTY	TOTAL SHEETS	SHEET NO.
2	202-2RS-1	MADISON	9	6
STA. 1203+00.00		TO STA. 1208+40.00		
FED. ROAD DIST. NO. -		ILLINOIS		FED. AID PROJECT

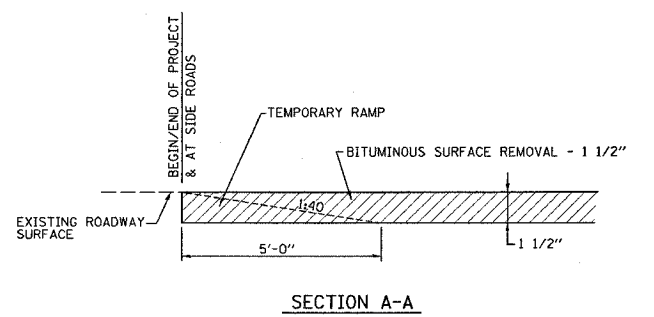
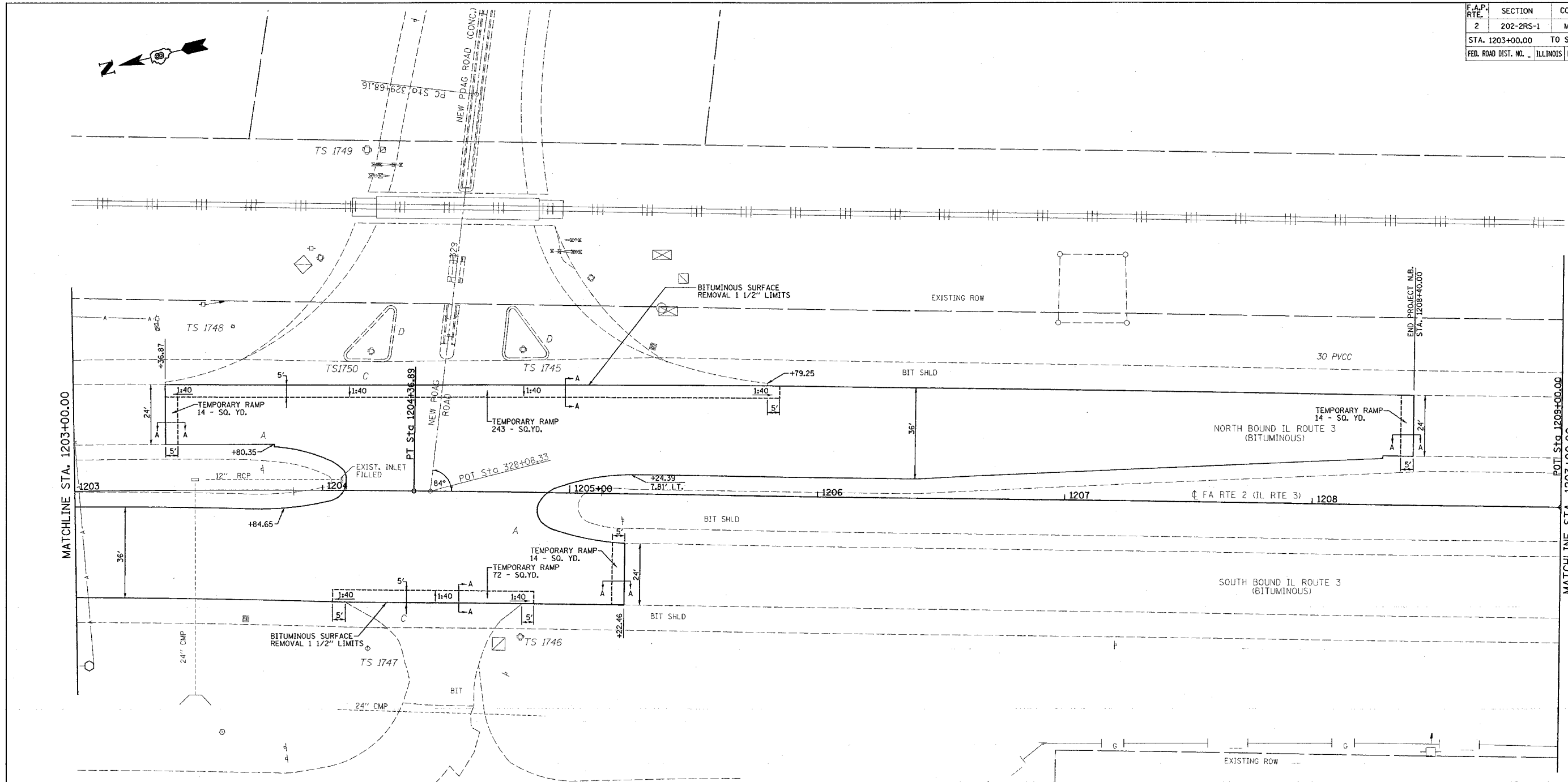

IL 3 RESURFACING SCHEDULE

STA to STA	Length (ft)	Width (ft)	Width (ft)	Avg. Width (ft)	Area (sq yds)	Bit. Sur face Removal 1 1/2" (sq yds)	Bit. Mat'l (PR. CT.) (tons)	Agg. (PR. CT.) (tons)	Sur face Course (tons)
<b>NORTHBOUND</b>									
1203+36.87 to 1204+09.35	72	24	24	24.0	193.28	193	0.06	0.29	16
1204+87.04 to 1206+39.48	152	36	36	36.0	609.76	610	0.19	0.91	51
1206+39.48 to 1208+40.00	201	36	24	30.0	668.40	668	0.21	1.00	56
<b>SOUTHBOUND</b>									
1198+99.05 to 1200+15.85	117	24	24	24.0	311.47	311	0.10	0.47	26
1200+15.85 to 1202+00.00	184	24	36	30.0	613.83	614	0.19	0.92	52
1202+00.00 to 1204+09.35	209	36	36	36.0	837.40	837	0.26	1.26	70
1204+87.04 to 1205+22.46	35	24	24	24.0	94.45	94	0.03	0.14	8
<b>CROSS OVER (1204+09.35 TO 1204+87.04)</b>						752	0.24	1.13	63
<b>TOTAL</b>						4079	1.3	6.1	342

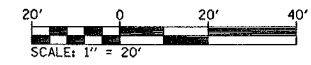

REVISIONS	
NAME	DATE

ILLINOIS DEPARTMENT OF TRANSPORTATION  
**PLAN VIEW**  
 FAP ROUTE 2  
 SECTION 202-2RS-1  
 MADISON COUNTY

SCALE: \_\_\_\_\_ DATE \_\_\_\_\_ DRAWN BY \_\_\_\_\_ CHECKED BY \_\_\_\_\_

PLOT DATE = 5/17/2005  
 FILE NAME = c:\projects\76954\plan\vol\09505a.dgn  
 PLOT SCALE = 28.000000 / 1 IN.  
 REFERENCE = #REF#

F.A.P. RTE.	SECTION	COUNTY	TOTAL SHEETS	SHEET NO.
2	202-2RS-1	MADISON	9	7
STA. _____ TO STA. _____				
FED. ROAD DIST. NO. _____ ILLINOIS FED. AID PROJECT				

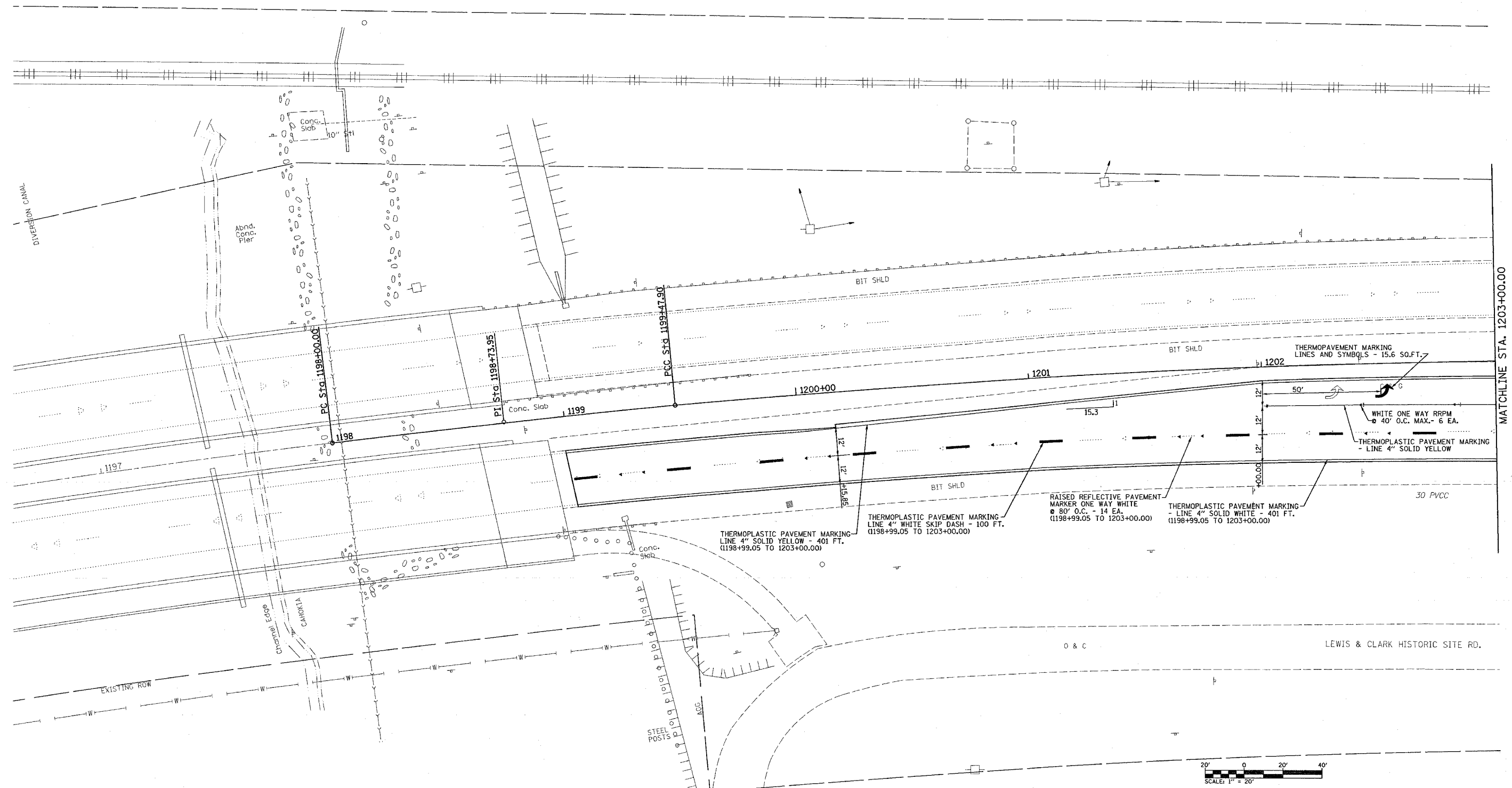

MATCHLINE STA. 1203+00.00



REVISIONS	
NAME	DATE

ILLINOIS DEPARTMENT OF TRANSPORTATION  
**PAVEMENT MARKING PLAN**  
 FAP ROUTE 2  
 SECTION 202-2RS-1  
 MADISON COUNTY

SCALE: \_\_\_\_\_ DATE \_\_\_\_\_ DRAWN BY \_\_\_\_\_ CHECKED BY \_\_\_\_\_

PLOT DATE = 5/17/2005  
 FILE NAME = c:\projects\vd9595\plan\marker\p109595a.dgn  
 PLOT SCALE = 20000 / 1 IN.  
 REFERENCE = REF

F.A.P. RTE.	SECTION	COUNTY	TOTAL SHEETS	SHEET NO.
2	202-2RS-1	MADISON	9	8
STA. _____		TO STA. _____		
FED. ROAD DIST. NO. _____		ILLINOIS FED. AID PROJECT		

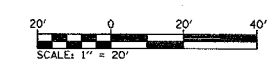
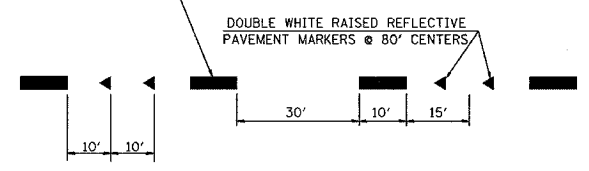
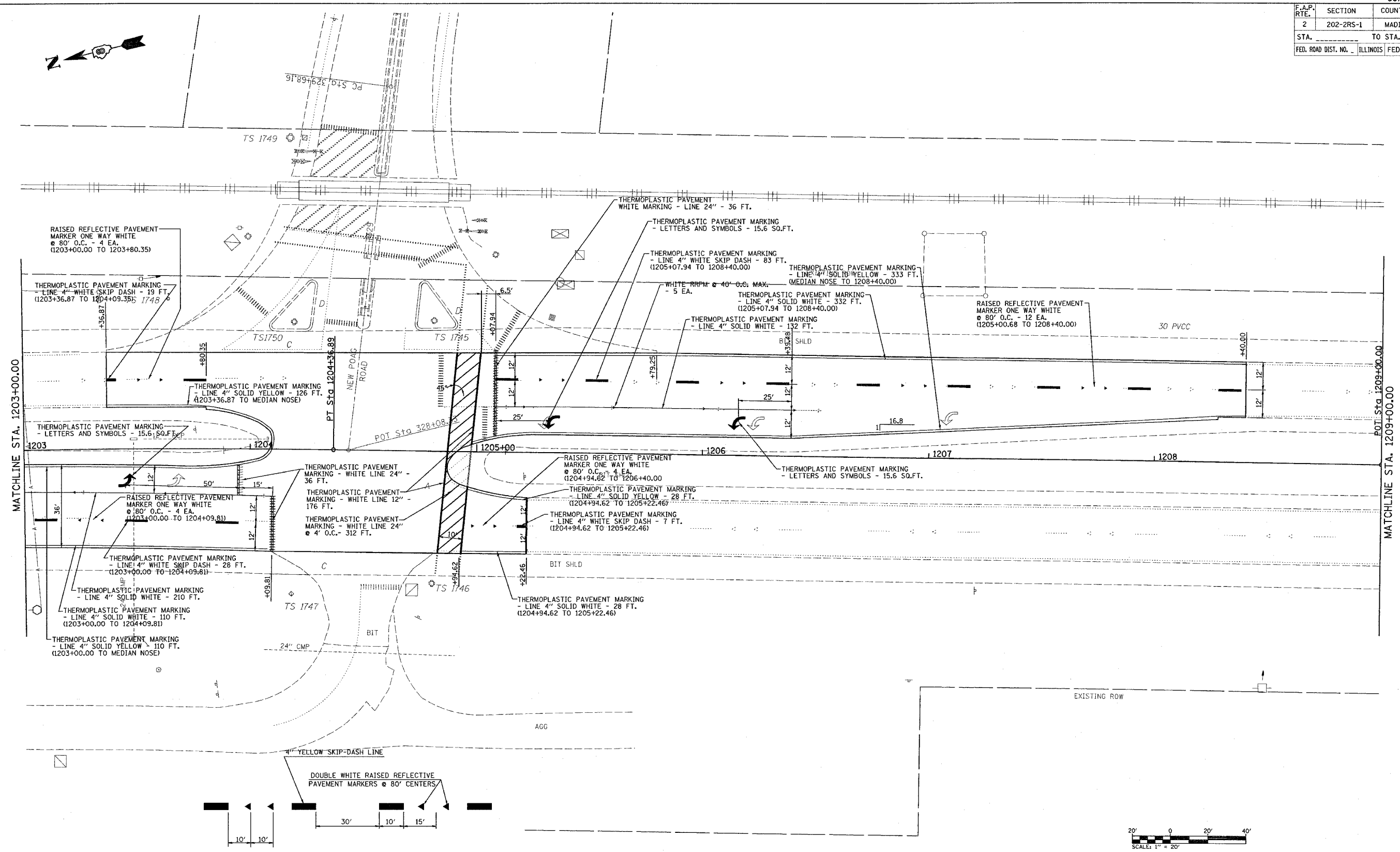
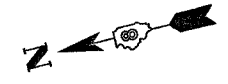

REVISIONS	
NAME	DATE

ILLINOIS DEPARTMENT OF TRANSPORTATION  
**PAVEMENT MARKING PLAN**  
 FAP ROUTE 2  
 SECTION 202-2RS-1  
 MADISON COUNTY

SCALE: \_\_\_\_\_ DATE \_\_\_\_\_ DRAWN BY \_\_\_\_\_ CHECKED BY \_\_\_\_\_

PLOT DATE = 5/17/2005  
 FILE NAME = C:\Users\jg505\Documents\jg505\mkmk\2109505.dgn  
 PLOT SCALE = 20.00000 / 1.00  
 REFERENCE = #REF#



F.A.P. RTE.	SECTION	COUNTY	TOTAL SHEETS	SHEET NO.
2	202-2RS-1	MADISON	9	9
STA. _____		TO STA. _____		
FED. ROAD DIST. NO. _____ ILLINOIS FED. AID PROJECT				

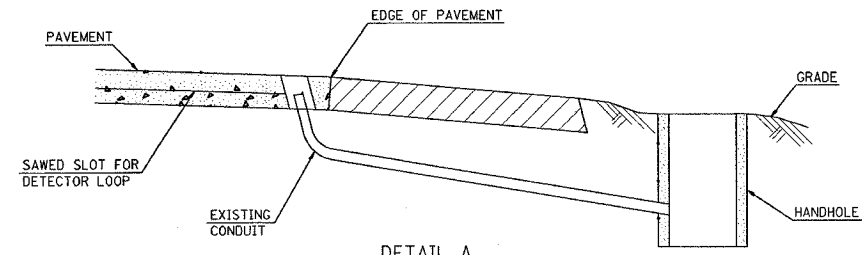
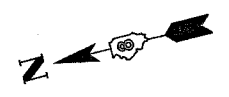

**DETAIL A**  
(NO SCALE)  
**RE-USE EXISTING DETECTOR LOOP LEAD-IN CONDUIT**

- 1 DRILL OUT PAVEMENT SEALANT AND CLEAN EXISTING CONDUIT.
- 2 REMOVE EXISTING CABLE TO HANDHOLE.
- 3 INSTALL LOOP LEAD-IN CONDUCTORS IN CONDUIT.
- 4 SPLICE NEW DETECTOR LOOP LEAD-IN CONDUCTORS TO EXISTING LEAD-IN CABLE IN HANDHOLE.
- 5 FILL HOLE WITH APPROVED SEALER. PREVENT SEALER FROM ENTERING INTO CONDUIT.

NOT A PAY ITEM. THE COST OF THIS WORK SHALL BE INCLUDED IN THE PAY ITEM "DETECTOR LOOP, TYPE 1"

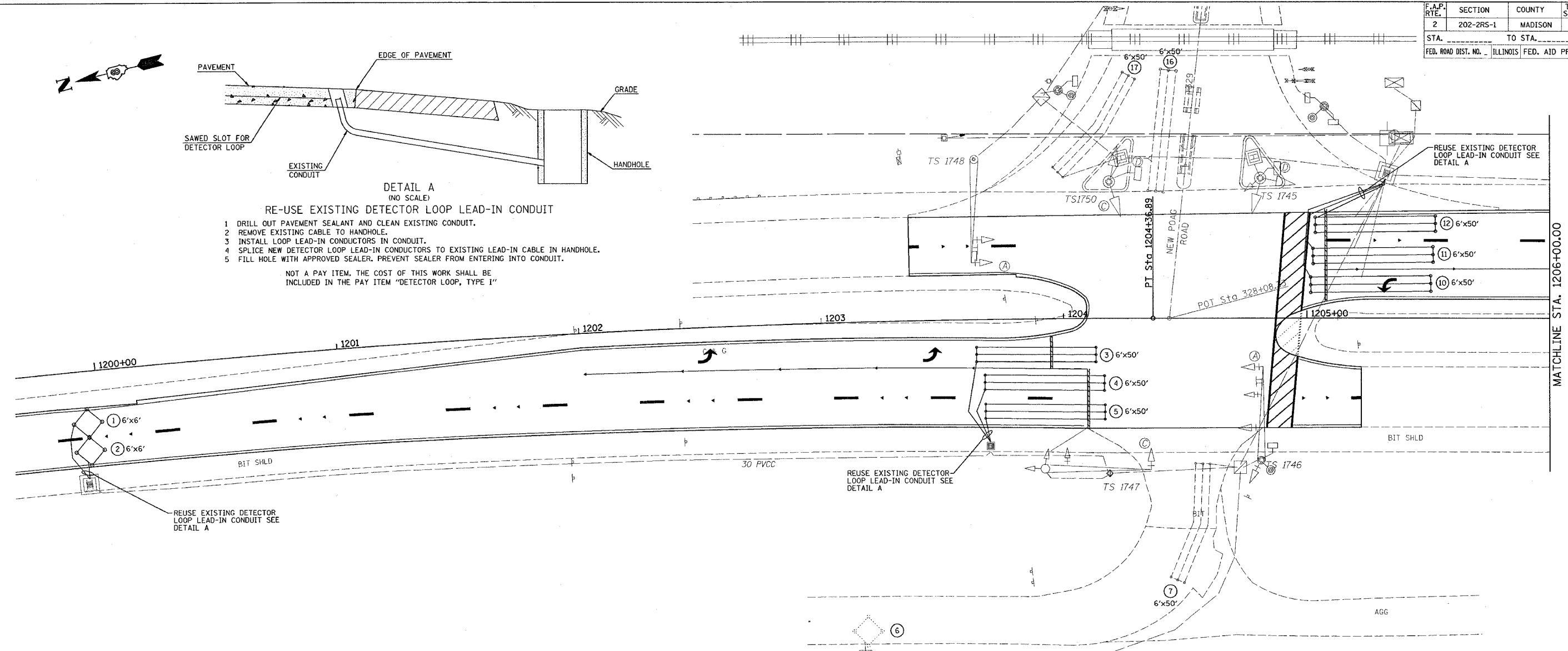

PAY ITEM	DESCRIPTION	UNIT	QUANTITY
88600000	DETECTOR LOOP, TYPE 1	FOOT	1227.5

DETECTOR LOOP REQUIREMENTS AND CALCULATIONS FOR IL 3 AND NEW POAG/LEWIS AND CLARK HISTORIC SITE ROADS

LOOP	PHASE (C/P)	LOOP SIZE (FT)	REQUIRED # OF TURNS	CALCULATED INDUCTANCE MICROHENRIES (μH)	CALCULATED RESISTANCE OHMS (Ω)
1 SB CCO A	2	6' X 6'	7	512.4	3.7
2 SB CCO B	2	6' X 6'	7	508.6	3.7
3 SB LT CD	5	6' X 50' (O)	3-6-3	852.0	3.1
4 SB THRU CD A	2	6' X 50' (O)	3-6-3	849.5	3.0
5 SB THRU CD B	2	6' X 50' (O)	3-6-3	844.7	2.9
6 EB CCO	4	NA	NA	NA	NA
7 EB THRU CD	4	NA	NA	NA	NA
8 NB CCO A	6	NA	NA	NA	NA
9 NB CCO B	6	NA	NA	NA	NA
10 NB LT CD	1	6' X 50' (O)	3-6-3	802.9	2.0
11 NB THRU CD A	6	6' X 50' (O)	3-6-3	800.1	1.9
12 NB THRU CD B	6	6' X 50' (O)	3-6-3	796.5	1.8
13 WB CCO	3	NA	NA	NA	NA
14 WB THRU CD A	3	NA	NA	NA	NA
15 WB RT CD A	3	NA	NA	NA	NA
16 WB THRU CD B	3	NA	NA	NA	NA
17 WB RT CD B	3	NA	NA	NA	NA

THE ABOVE VALUES ARE CALCULATED OF COMBINED LOOP AND LEAD-IN INDUCTANCES AND RESISTANCES. ACTUAL MEASURED VALUES SHOULD BE WITHIN +/- 20% OF THESE VALUES.

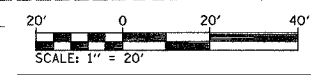
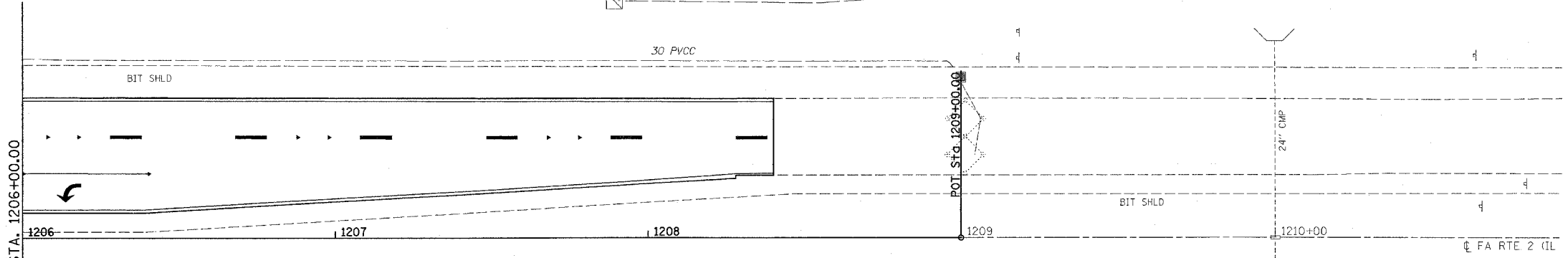

REVISIONS	
NAME	DATE

ILLINOIS DEPARTMENT OF TRANSPORTATION  
**TRAFFIC SIGNAL PLAN**  
FAP ROUTE 2  
SECTION 202-2RS-1  
MADISON COUNTY

SCALE: \_\_\_\_\_ DRAWN BY \_\_\_\_\_  
DATE \_\_\_\_\_ CHECKED BY \_\_\_\_\_

PLOT DATE = 5/17/2005  
 FILE NAME = c:\p\projects\205\205\plan\ts1206.dgn  
 PLOT SCALE = 20.00000 / IN.  
 REFERENCE = #REF#