

ROUTE	SECTION	COUNTY	TOTAL SHEETS	SHEET NO.
*	**	***	25	13
STA.		TO STA.		
FED. ROAD DIST. NO.		ILLINOIS FED. AID PROJECT *****		

* FAI 55/70 CONTRACT# 76966
 ** DIST 8 ITS 2006-1
 *** MADISON & ST. CLAIR

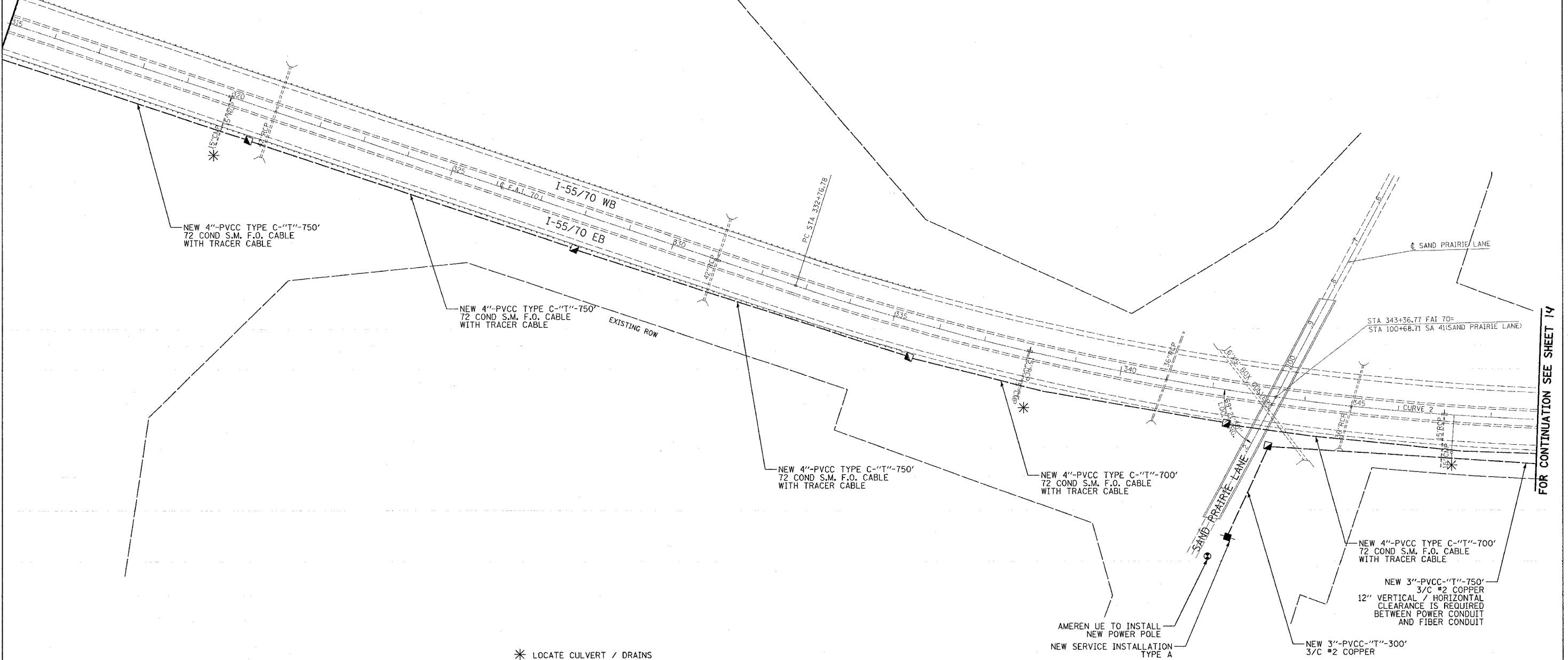

FOR CONTINUATION SEE SHEET 12



FOR CONTINUATION SEE SHEET 14

* LOCATE CULVERT / DRAINS
 VERIFY DEPTH. TRENCH OVER
 OR TRENCH AROUND PER FIELD
 ENGINEER'S RECOMMENDATION.

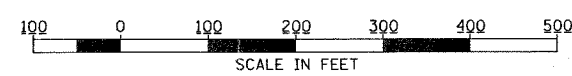

REVISIONS	
NAME	DATE

ILLINOIS DEPARTMENT OF TRANSPORTATION
 LOCATION 557007.OA.28D
 FAI 55/70
 SECTION DIST 8 ITS 2006-1
 MADISON AND ST. CLAIR COUNTY

SCALE: 1" = 100'
 DATE 05/02/05

DRAWN BY MAM
 CHECKED BY CAF

DATE PLOTTED: 05/02/05
 PLOTTER: HP DesignJet 5000
 SCALE: 1" = 100'
 SHEET: 13 OF 25