

| FED. AID DISTRICT NO. | SECTION | COUNTY | TOTAL SHEETS | SHEET NO. |
|-----------------------|---------|-------------|--------------|-----------|
| 7 | * | COOK/DUPAGE | 84 | 11 |

CONSTRUCTION PROCEDURE-STAGE 2
 *ELK GROVE VILLAGE SECTION 99-00041-00-CH
 CONTRACT NO. 83766

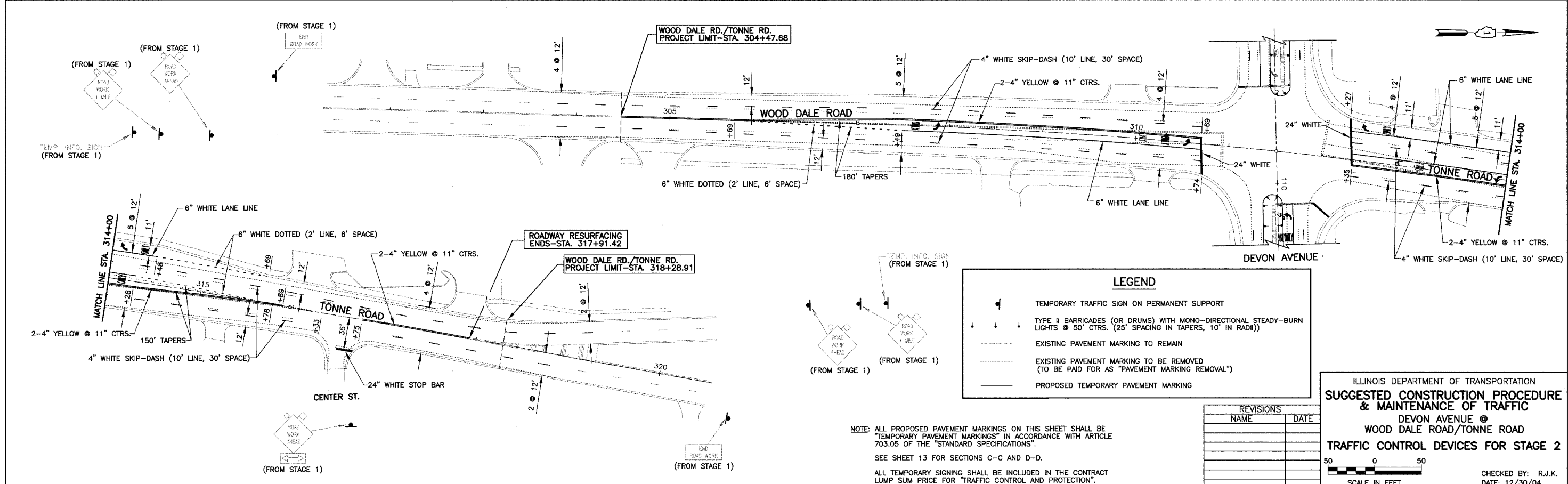
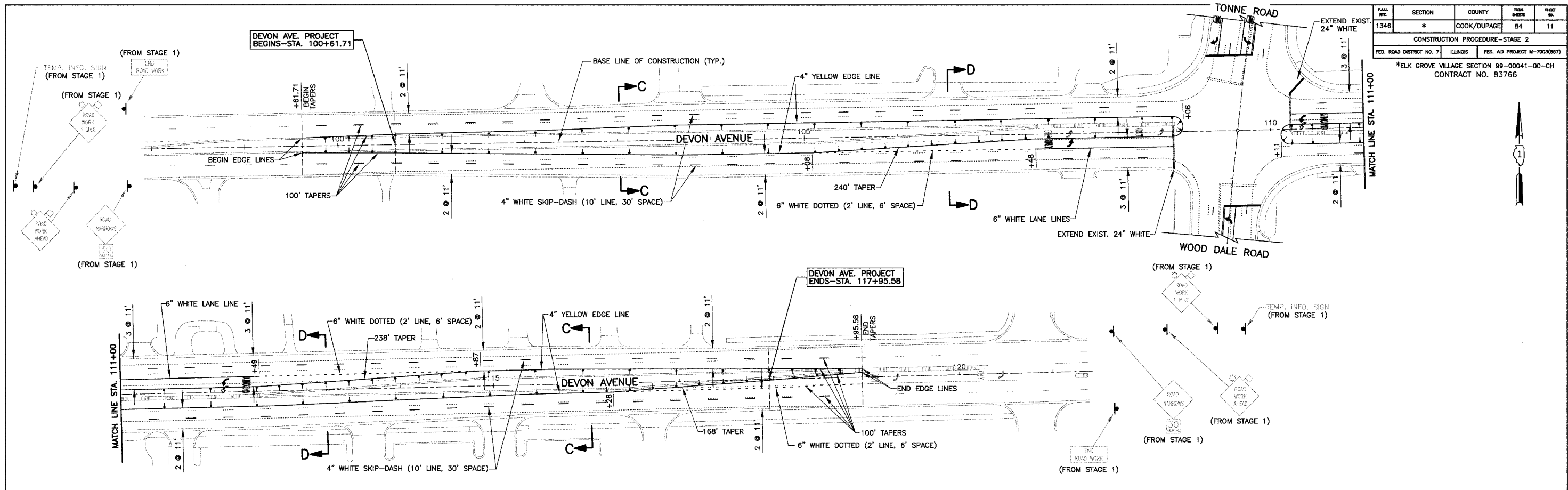

LEGEND

- TEMPORARY TRAFFIC SIGN ON PERMANENT SUPPORT
- TYPE II BARRICADES (OR DRUMS) WITH MONO-DIRECTIONAL STEADY-BURN LIGHTS @ 50' CTRS. (25' SPACING IN TAPERS, 10' IN RADI)
- EXISTING PAVEMENT MARKING TO REMAIN
- EXISTING PAVEMENT MARKING TO BE REMOVED (TO BE PAID FOR AS "PAVEMENT MARKING REMOVAL")
- PROPOSED TEMPORARY PAVEMENT MARKING

NOTE: ALL PROPOSED PAVEMENT MARKINGS ON THIS SHEET SHALL BE "TEMPORARY PAVEMENT MARKINGS" IN ACCORDANCE WITH ARTICLE 703.05 OF THE "STANDARD SPECIFICATIONS".
 SEE SHEET 13 FOR SECTIONS C-C AND D-D.
 ALL TEMPORARY SIGNING SHALL BE INCLUDED IN THE CONTRACT LUMP SUM PRICE FOR "TRAFFIC CONTROL AND PROTECTION".

| REVISIONS | |
|-----------|------|
| NAME | DATE |
| | |
| | |
| | |
| | |

ILLINOIS DEPARTMENT OF TRANSPORTATION
SUGGESTED CONSTRUCTION PROCEDURE & MAINTENANCE OF TRAFFIC
 DEVON AVENUE @
 WOOD DALE ROAD/TONNE ROAD
TRAFFIC CONTROL DEVICES FOR STAGE 2

SCALE IN FEET

CHECKED BY: R.J.K.
 DATE: 12/30/04