

SECTION	COUNTY	TOTAL SHEETS	SHEET NO.
1346	* COOK/DUPAGE	84	18

PLAN & PROFILE-DEVON AVE. STA. 107+00 TO 112+00  
 FED. ROAD DISTRICT NO. 7 ILLINOIS FED. AID PROJECT M-7003(067)  
 \*ELK GROVE VILLAGE SECTION 99-00041-00-CH CONTRACT NO. 83766

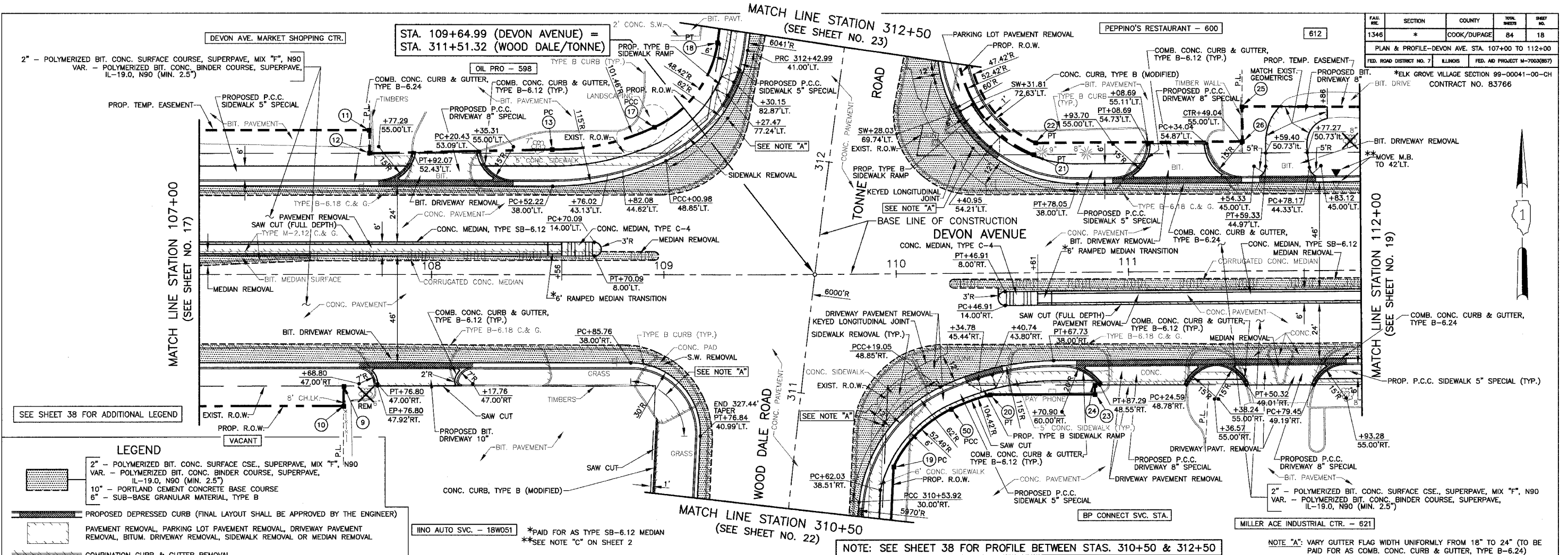

**LEGEND**

- 2" - POLYMERIZED BIT. CONC. SURFACE CSE., SUPERPAVE, MIX "F", N90  
VAR. - POLYMERIZED BIT. CONC. BINDER COURSE, SUPERPAVE, IL-19.0, N90 (MIN. 2.5")
- 10" - PORTLAND CEMENT CONCRETE BASE COURSE
- 6" - SUB-BASE GRANULAR MATERIAL, TYPE B
- PROPOSED DEPRESSED CURB (FINAL LAYOUT SHALL BE APPROVED BY THE ENGINEER)
- PAVEMENT REMOVAL, PARKING LOT PAVEMENT REMOVAL, DRIVEWAY PAVEMENT REMOVAL, BITUM. DRIVEWAY REMOVAL, SIDEWALK REMOVAL OR MEDIAN REMOVAL
- COMBINATION CURB & GUTTER REMOVAL
- CURB REMOVAL
- KEYED LONGITUDINAL JOINT WITHOUT TIE BARS
- PROP. R.O.W. CONTROL POINT (SEE SHEET 8 FOR LOCATIONS)

HINO AUTO SVC. - 18W051 \*PAID FOR AS TYPE SB-6.12 MEDIAN  
 \*\*SEE NOTE "C" ON SHEET 2

NOTE: SEE SHEET 38 FOR PROFILE BETWEEN STAS. 310+50 & 312+50

NOTE "A": VARY GUTTER FLAG WIDTH UNIFORMLY FROM 18" TO 24" (TO BE PAID FOR AS COMB. CONC. CURB & GUTTER, TYPE B-6.24)

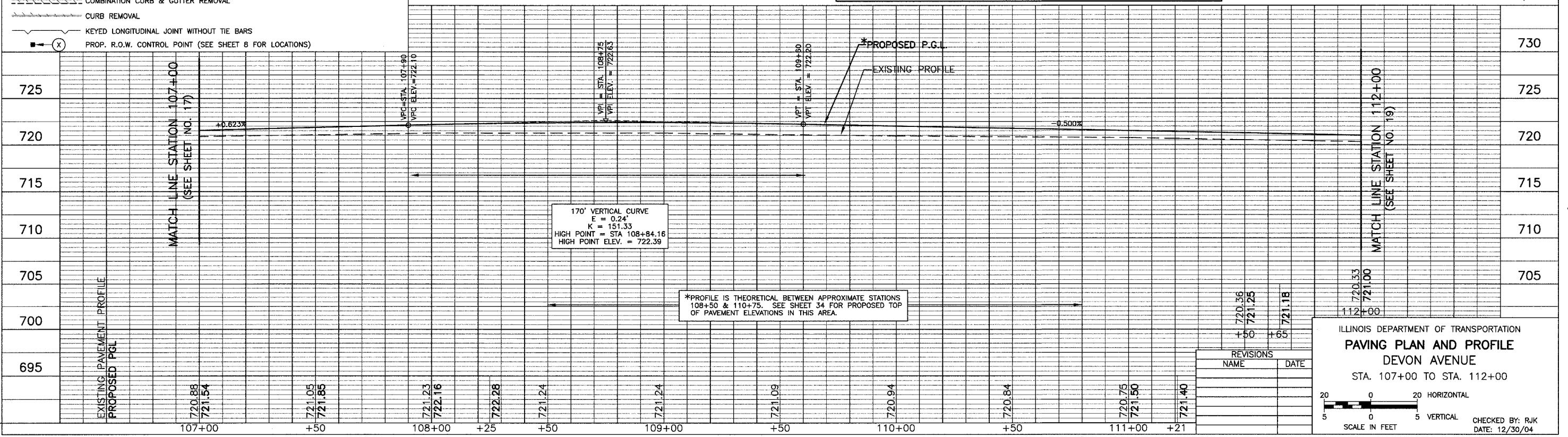

170' VERTICAL CURVE  
 E = 0.24  
 K = 151.33  
 HIGH POINT = STA 108+84.16  
 HIGH POINT ELEV. = 722.39

\*PROFILE IS THEORETICAL BETWEEN APPROXIMATE STATIONS 108+50 & 110+75. SEE SHEET 34 FOR PROPOSED TOP OF PAVEMENT ELEVATIONS IN THIS AREA.

REVISIONS

NAME	DATE

ILLINOIS DEPARTMENT OF TRANSPORTATION  
**PAVING PLAN AND PROFILE**  
 DEVON AVENUE  
 STA. 107+00 TO STA. 112+00

20 0 20 HORIZONTAL  
 5 0 5 VERTICAL  
 SCALE IN FEET

CHECKED BY: RJK  
 DATE: 12/30/04