

FILE NO.	SECTION	COUNTY	TOTAL SHEETS	SHEET NO.
1346	*	COOK/DUPAGE	84	19

PLAN & PROFILE-DEVON AVE. STA. 112+00 TO 117+00  
 FED. ROAD DISTRICT NO. 7 ILLINOIS FED. AID PROJECT M-7003(867)

\*ELK GROVE VILLAGE SECTION 99-00041-00-CH  
 CONTRACT NO. 83766

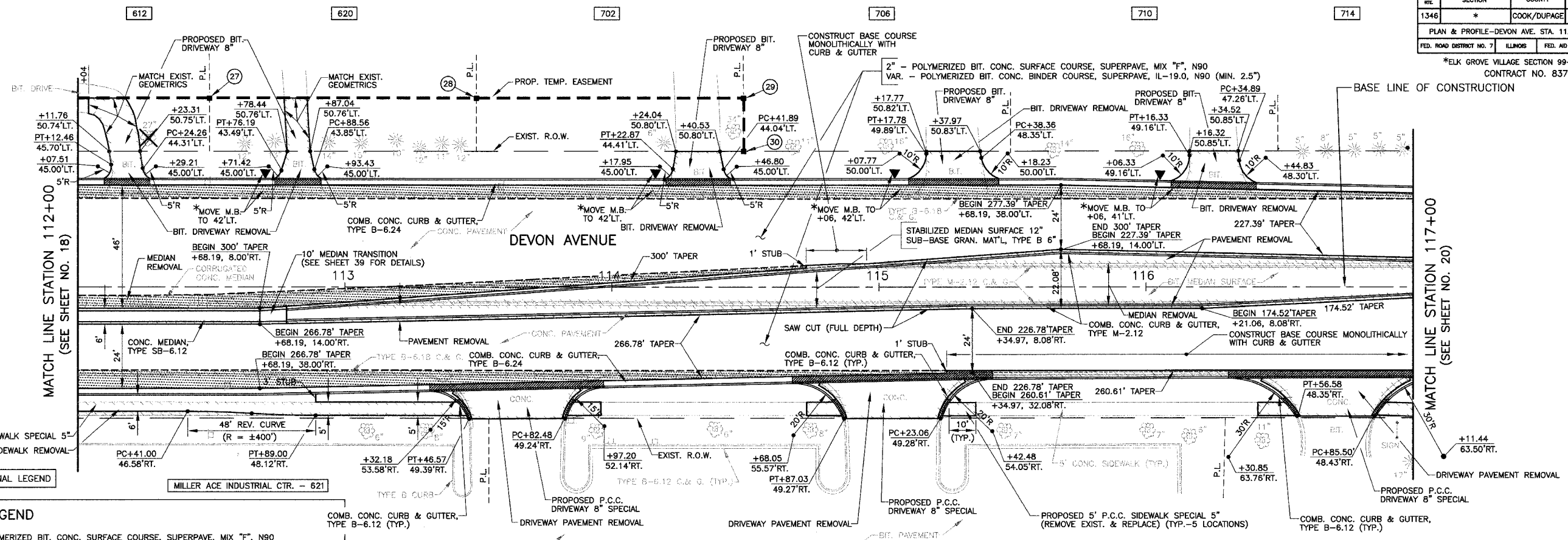

SEE SHEET 38 FOR ADDITIONAL LEGEND

MILLER ACE INDUSTRIAL CTR. - 621

JERRY CASTLE & SON HI LIFT, INC. - 651

ARROW PLASTICS/ILLINOIS BOTTLING

\*SEE NOTE "C" ON SHEET 2

**LEGEND**

- 2" - POLYMERIZED BIT. CONC. SURFACE COURSE, SUPERPAVE, MIX "F", N90
- VAR. - POLYMERIZED BIT. CONC. BINDER COURSE, SUPERPAVE, IL-19.0, N90 (MIN. 2.5")
- 10" - PORTLAND CEMENT CONCRETE BASE COURSE
- 6" - SUB-BASE GRANULAR MATERIAL, TYPE B
- PROPOSED DEPRESSED CURB (FINAL LAYOUT SHALL BE APPROVED BY THE ENGINEER)
- PAVEMENT REMOVAL, DRIVEWAY PAVEMENT REMOVAL, BITUMINOUS DRIVEWAY REMOVAL, SIDEWALK REMOVAL OR MEDIAN REMOVAL
- COMBINATION CURB & GUTTER REMOVAL
- PROP. R.O.W. CONTROL POINT (SEE SHEET 8 FOR LOCATIONS)

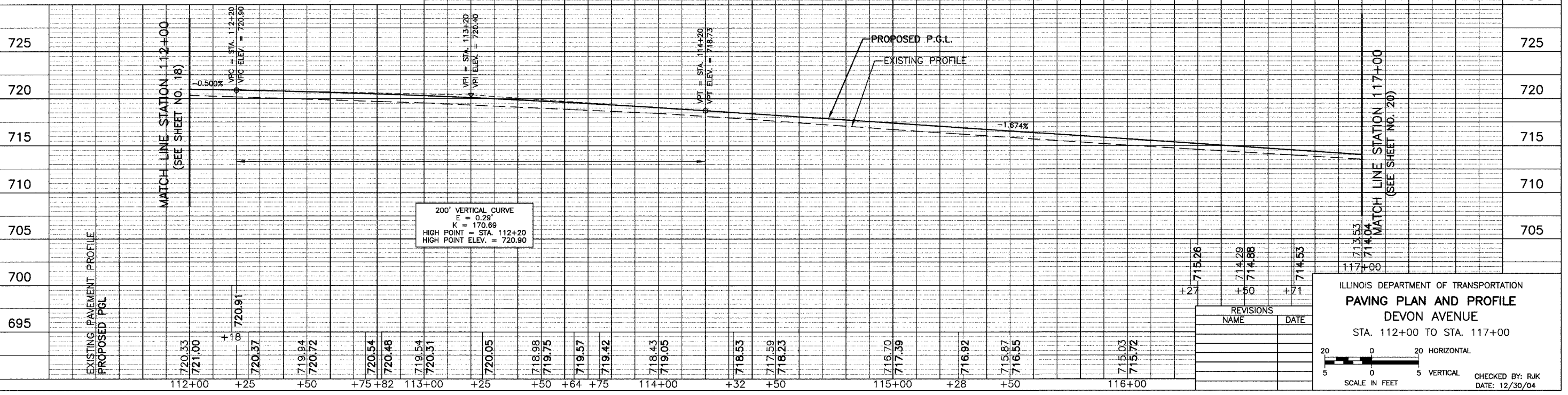

REVISIONS	
NAME	DATE

ILLINOIS DEPARTMENT OF TRANSPORTATION  
**PAVING PLAN AND PROFILE**  
 DEVON AVENUE  
 STA. 112+00 TO STA. 117+00

SCALE IN FEET  
 20 0 20 HORIZONTAL  
 5 0 5 VERTICAL

CHECKED BY: RJK  
 DATE: 12/30/04