

FAN. NO.	SECTION	COUNTY	TOTAL SHEETS	SHEET NO.
1346	*	COOK/DUPAGE	84	25

DRAINAGE & UTILITIES-DEVON AVE. STA. 98+00 TO 102+00  
 FED. ROAD DISTRICT NO. 7 ILLINOIS FED. AID PROJECT M-7003(857)

\*ELK GROVE VILLAGE SECTION 98-00041-00-CH  
 CONTRACT NO. 83766

① 9"-12" SS, CL. A, T-2 @ 52.00%  
 TBF = 3.5 CU YD

DEVON AVENUE PROJECT  
 BEGINS - STA. 100+61.71

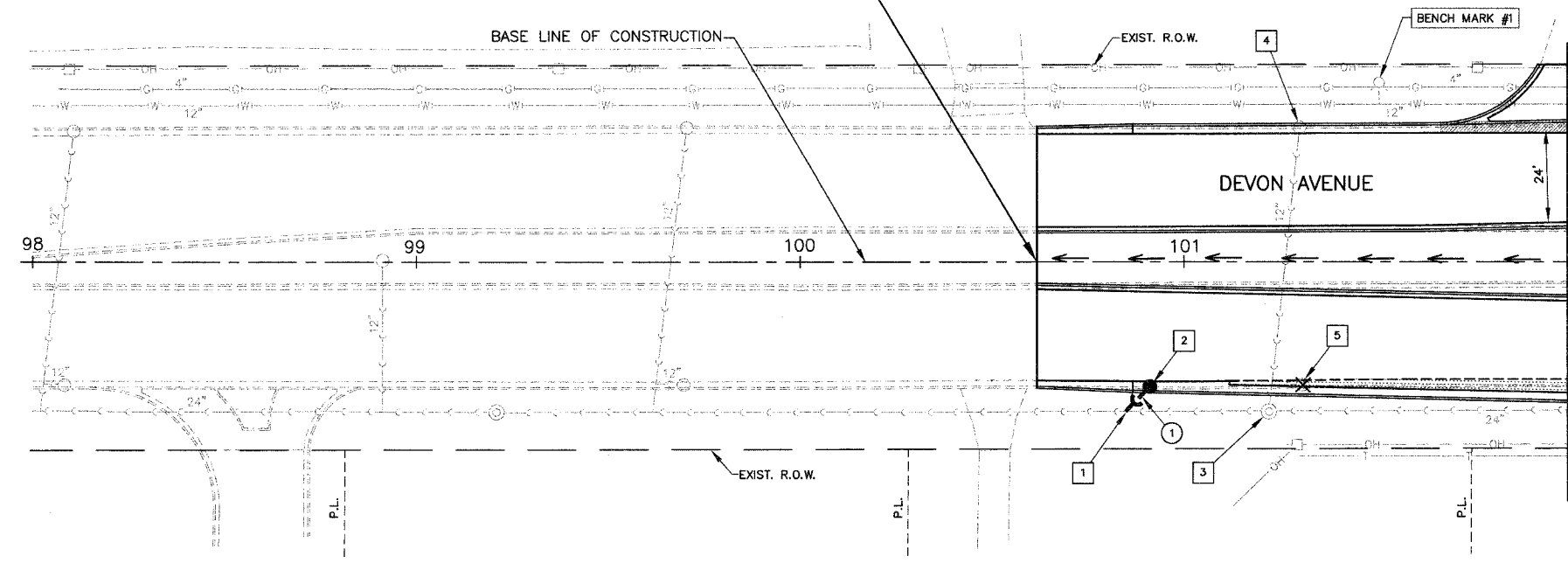

MATCHLINE STATION 102+00  
 (SEE SHEET NO. 26)



SEE SHEET 38 FOR ADDITIONAL LEGEND

LEGEND	
	PROPOSED PAVEMENT WIDENING
	PROPOSED DEPRESSED CURB

THE ENVIRONMENTAL FIRM IS REQUIRED TO CONTINUOUSLY MONITOR FOR WORKER SAFETY AND SOIL CONTAMINATION AT SEVERAL AREAS. SEE SPECIAL PROVISION FOR "NON-SPECIAL WASTE WORKING CONDITIONS" AND SUPPLEMENTAL SPECIFICATIONS FOR DETAILS.

- ① STA. 100+85.3, 39.1'RT  
CONNECT TO EXIST. PIPE  
W/STORM SEWER WYE  
INV = 710.62
- ② STA. 100+91.0, 31.7'RT  
C.B. T-C, T-24 FR & GR  
RIM = 718.55  
INV = 715.30
- ③ STA. 101+22.1, 39.0'RT  
ADJUST M.H.  
EXIST. RIM = 719.20  
PROP. RIM = 718.93  
INV = 714.37 (12"NE)  
EX. INV = 710.89 (18"E&W)
- ④ STA. 101+30.5, 33.2'LT  
ADJ. C.B. W/NEW T-24 FR & GR  
EXIST. RIM = 718.63  
PROP. RIM = 719.05
- ⑤ STA. 101+30.5, 30.8'RT  
C.B. TO BE REMOVED  
(SEAL OUTLET PIPE)

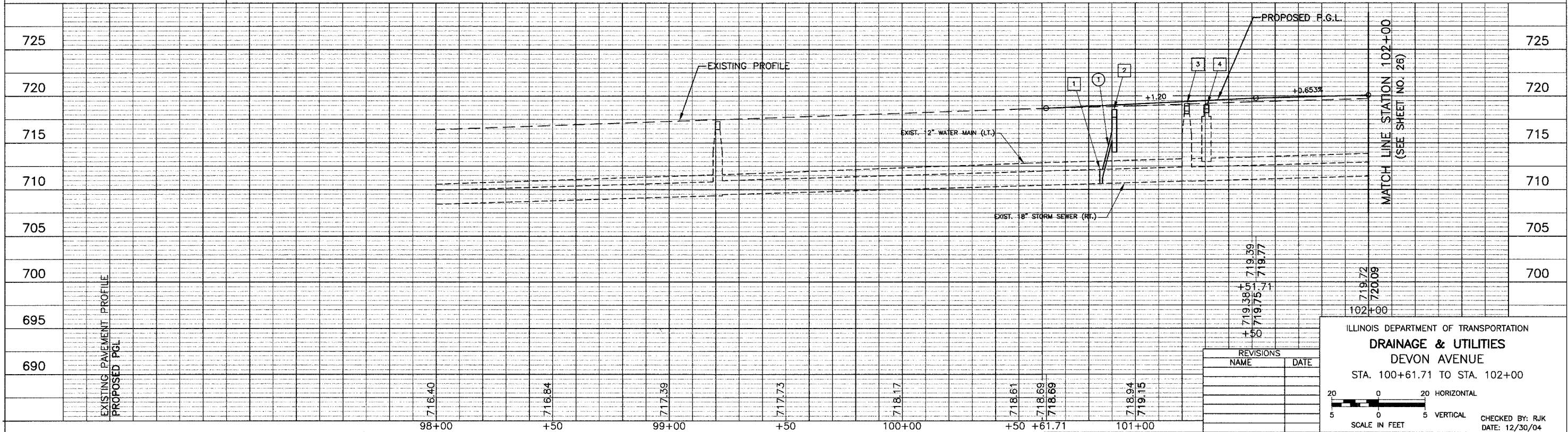

REVISIONS	
NAME	DATE

ILLINOIS DEPARTMENT OF TRANSPORTATION  
**DRAINAGE & UTILITIES**  
 DEVON AVENUE  
 STA. 100+61.71 TO STA. 102+00

20 0 20 HORIZONTAL  
 5 0 5 VERTICAL  
 SCALE IN FEET

CHECKED BY: RJK  
 DATE: 12/30/04