

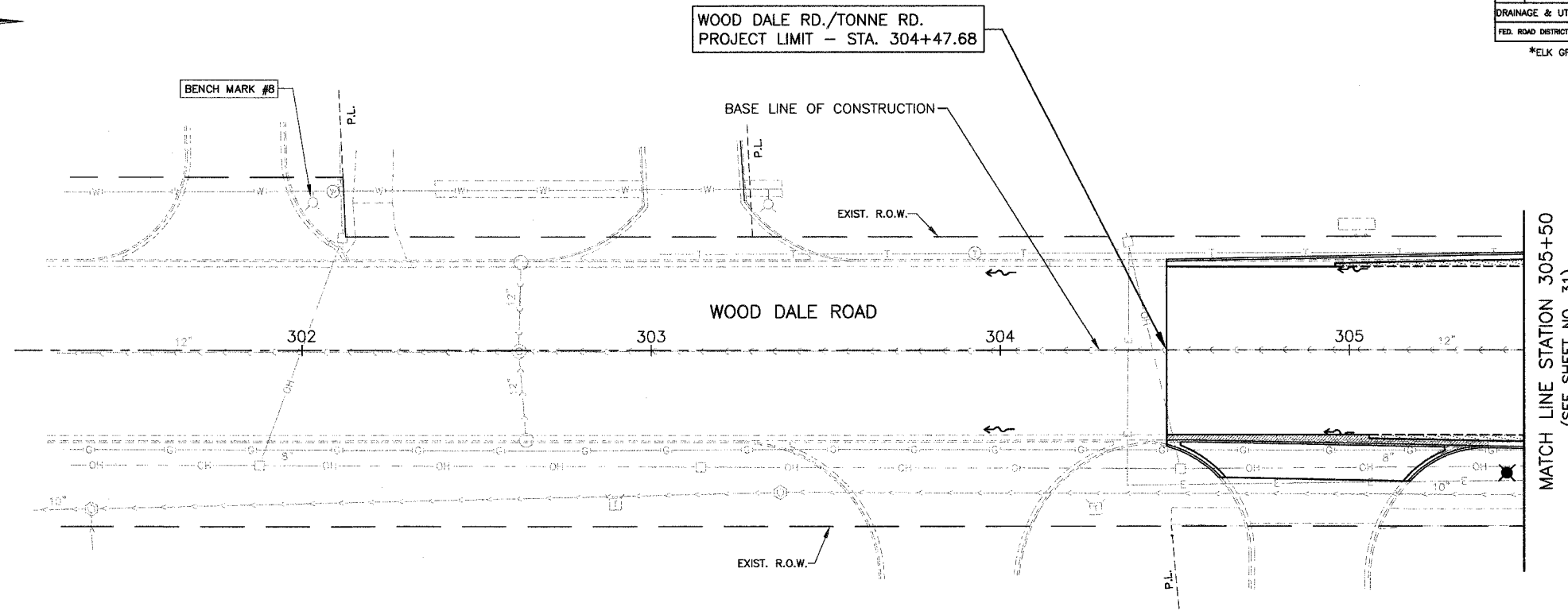

FAH. NO.	SECTION	COUNTY	TOTAL SHEETS	SHEET NO.
1346	*	COOK/DUPAGE	84	30
DRAINAGE & UTIL.-WOOD DALE RD. STA. 301+00 TO 305+50				
FED. ROAD DISTRICT NO. 7		ILLINOIS	FED. AID PROJECT M-7003(857)	
*ELK GROVE VILLAGE SECTION 99-00041-00-CH CONTRACT NO. 83766				



SEE SHEET 38 FOR ADDITIONAL LEGEND

LEGEND	
	PROPOSED PAVEMENT WIDENING
	PROPOSED DEPRESSED CURB

THE ENVIRONMENTAL FIRM IS REQUIRED TO CONTINUOUSLY MONITOR FOR WORKER SAFETY AND SOIL CONTAMINATION AT SEVERAL AREAS. SEE SPECIAL PROVISION FOR "NON-SPECIAL WASTE WORKING CONDITIONS" AND SUPPLEMENTAL SPECIFICATIONS FOR DETAILS.

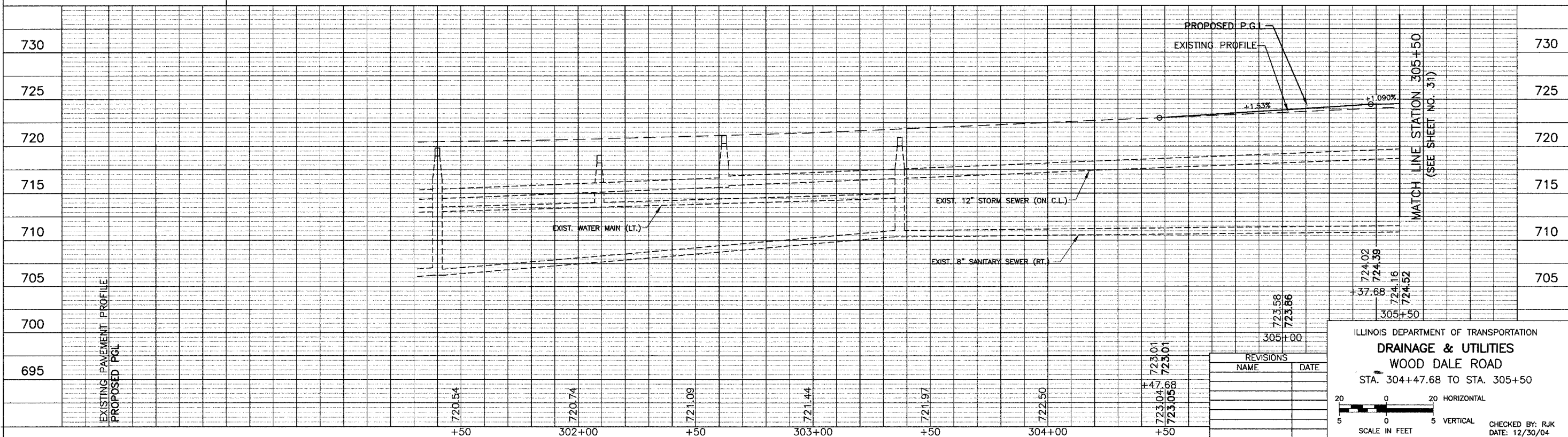

REVISIONS	
NAME	DATE

ILLINOIS DEPARTMENT OF TRANSPORTATION  
**DRAINAGE & UTILITIES**  
**WOOD DALE ROAD**  
 STA. 304+47.68 TO STA. 305+50

20 0 20 HORIZONTAL  
 5 0 5 VERTICAL  
 SCALE IN FEET

CHECKED BY: RJK  
 DATE: 12/30/04