

- 51 9'-12" SS, CL A, T-1 @ 0.56% TBF = 0.7 CU YD
- 52 9'-12" SS, CL A, T-1 @ 3.44% TBF = 0.1 CU YD
- 53 25'-PIPE UNDERDRAIN, FABRIC LINED TRENCH, 4"
- 54 25'-PIPE UNDERDRAIN, FABRIC LINED TRENCH, 4"
- 55 13'-12" SS, CL A, T-1 @ 0.54% TBF = 1.6 CU YD
- 56 7'-12" SS, CL A, T-1 @ 1.00% TBF = 0.7 CU YD
- 57 86'-12" SS, CL A, T-1 @ 0.74% TBF = 4.1 CU YD
- 58 55'-12" SS, CL A, T-1 @ 1.00% TBF = 0.2 CU YD CLD PATCH = 26.8 SQ YD
- 59 16'-12" SS, CL A, T-1 @ 1.00% TBF = 2.0 CU YD
- 60 12'-12" SS, CL A, T-1 @ 1.00% TBF = 2.3 CU YD
- 61 39'-12" SS (WM REQ) @ 1.00% TBF = 4.7 CU YD
- 62 16'-12" SS TO BE REMOVED (SEAL REMAINING PIPE)
- 63 25'-PIPE UNDERDRAIN, FABRIC LINED TRENCH, 4"
- 64 25'-PIPE UNDERDRAIN, FABRIC LINED TRENCH, 4"

SECTION	COUNTY	TOTAL SHEETS	SHEET NO.
*	COOK/DUPAGE	84	32
DRAIN. & UTIL.-TONNE RD. STA. 312+50 TO 317+50			
ILLINOIS FED. AID PROJECT M-7003(857)			
*ELK GROVE VILLAGE SECTION 99-00041-00-CH CONTRACT NO. 83766			

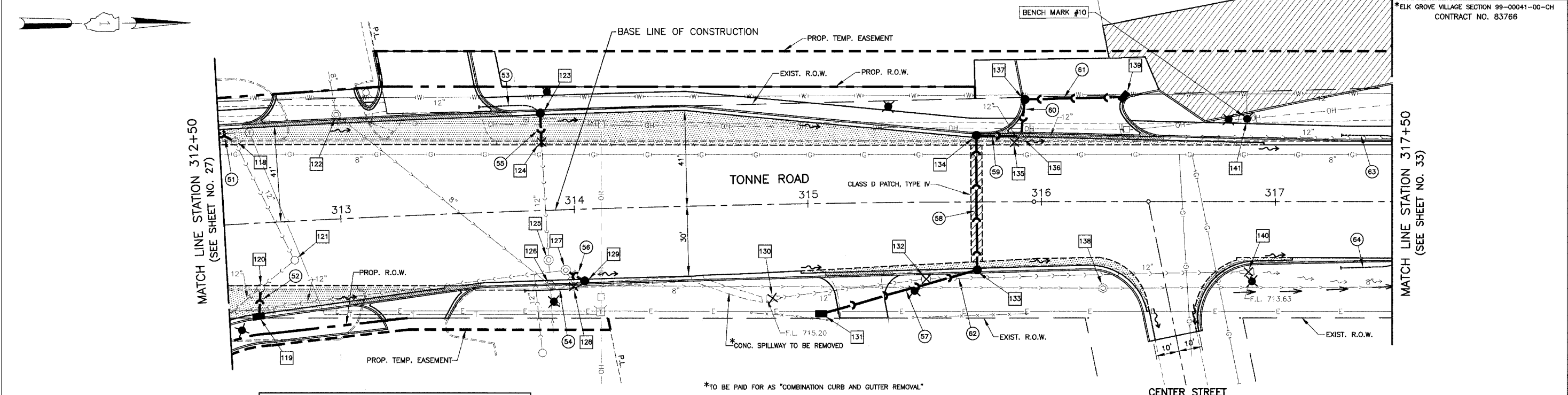

THE ENVIRONMENTAL FIRM IS REQUIRED TO CONTINUOUSLY MONITOR FOR WORKER SAFETY AND SOIL CONTAMINATION AT SEVERAL AREAS. SEE SPECIAL PROVISION FOR "NON-SPECIAL WASTE WORKING CONDITIONS" AND SUPPLEMENTAL SPECIFICATIONS FOR DETAILS.

*TO BE PAID FOR AS "COMBINATION CURB AND GUTTER REMOVAL"

SEE SHEET 38 FOR ADDITIONAL LEGEND

LEGEND	
	PROPOSED PAVEMENT WIDENING
	PROPOSED DEPRESSED CURB
	CLASS D PATCH, TYPE III, 10"

- 118 STA. 312+56.6, 34.0'LT ADJ. C.B. W/NEW T-1 FR. C.L. EXIST. RIM = 718.61 PROP. RIM = 719.68 INV = 715.56(12'SW) EX. INV = 715.56(12'NE)
- 119 STA. 312+62.6, 38.9'RT INLET T-A, T-1F, O.L. RIM = 719.66 INV = 716.57
- 120 STA. 312+63.7, 28.0'RT ADJ. C.B. W/NEW T-1 FR. C.L. EXIST. RIM = 718.59 PROP. RIM = 719.87 INV = 716.26(12'E) EX. INV = 714.65(12'NW&E)
- 121 STA. 312+79.3, 16.7'RT RECONSTRUCT C.B. EXIST. RIM = 718.82 PROP. RIM = 719.91
- 122 STA. 313+00.6, 44.7'LT ADJUST M.H. EXIST. RIM = 718.67 PROP. RIM = 719.07
- 123 STA. 313+87.0, 41.0'LT C.B. T-C, T-1F, O.L. RIM = 718.18 INV = 714.82
- 124 STA. 313+87.1, 28.0'LT FILL C.B. TO MAINTAIN FLOW INV = 714.75
- 125 STA. 313+80, 21.3'RT ADJUST M.H. EXIST. RIM = 717.88 PROP. RIM = 718.82
- 126 STA. 313+88.6, 32.3'RT ADJUST M.H. EXIST. RIM = 717.52 PROP. RIM = 718.92
- 127 STA. 313+95.4, 32.7'RT ADJUST M.H. EXIST. RIM = 717.66 PROP. RIM = 718.58 EX. INV = 714.72(12'S)
- 128 STA. 313+98.4, 25.8'RT C.B. TO BE REMOVED (SEAL OUTLET PIPE)
- 129 STA. 314+03.5, 30.0'RT C.B. T-C, T-1F, O.L. RIM = 716.43 INV = 714.79
- 130 STA. 314+81.0, 40.5'RT 12" PREC. R.C. FL. END SEC. TO BE REMOVED (SEAL PIPE OPENING)
- 131 STA. 315+04.5, 47.0'RT INLET T-A, T-5 GRATE RIM = 716.60 INV = 715.40
- 132 STA. 315+49.6, 32.7'RT C.B. TO BE REMOVED (SEAL INLET & OUTLET PIPES)
- 133 STA. 315+72.5, 28.2'RT C.B. T-A, 4D, T-1F, O.L. W/FLAT SLAB TOP RIM = 717.44 INV = 714.91 (12'SE&W) EX. INV = 712.41(12'N)
- 134 STA. 315+72.5, 27.8'LT C.B. T-A, 4D, T-1F, O.L. W/FLAT SLAB TOP RIM = 717.43 INV = 714.36 (12'E) EX. INV = 713.43(12'N)
- 135 STA. 315+88.8, 25.7'LT C.B. TO BE REMOVED (SEAL OUTLET PIPE)
- 136 STA. 315+91.9, 28.2'LT ADJUST M.H. EXIST. RIM = 716.81 PROP. RIM = 717.32 INV = 713.27(12'S&W) EX. INV = 712.41(12'N)
- 137 STA. 315+93.0, 43.7'LT C.B. T-A, 4D, T-1F, O.L. W/FLAT SLAB TOP RIM = 716.69 INV = 713.39(12'N&E)
- 138 STA. 316+26.3, 37.1'RT ADJUST M.H. EXIST. RIM = 716.20 PROP. RIM = 717.35
- 139 STA. 316+34.9, 44.6'LT INLET T-A, T-1F, O.L. RIM = 716.51 INV = 713.78
- 140 STA. 316+91.0, 29.8'RT 12" PREC. R.C. FL. END SEC. TO BE REMOVED (SEAL PIPE OPENING)
- 141 STA. 316+88.6, 35.4'LT FIRE HYDRANT TO BE MOVED (VERTICAL ADJUSTMENT)

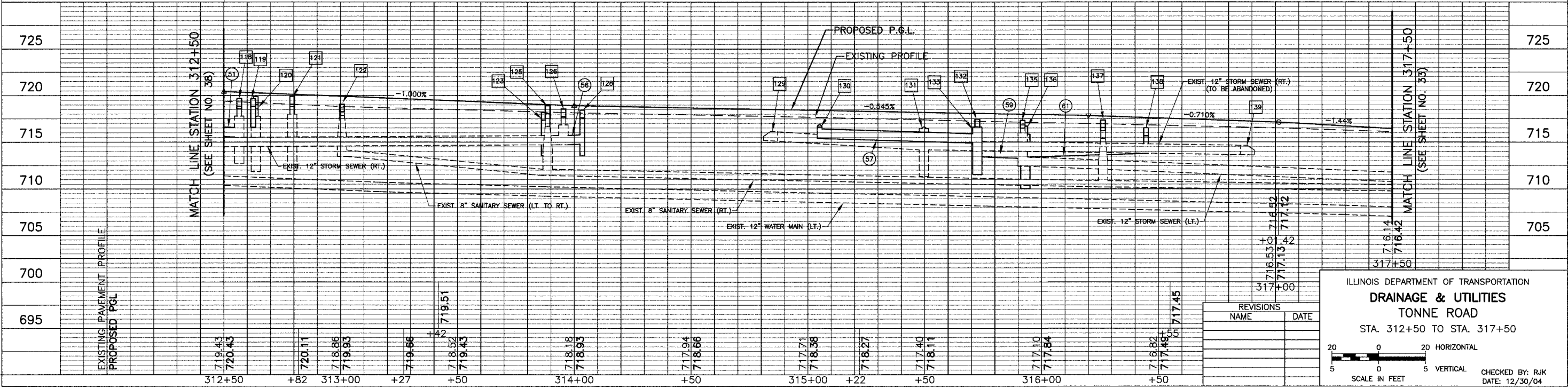

REVISIONS	
NAME	DATE

ILLINOIS DEPARTMENT OF TRANSPORTATION
DRAINAGE & UTILITIES
TONNE ROAD
 STA. 312+50 TO STA. 317+50

20 0 20 HORIZONTAL
 5 5 VERTICAL
 SCALE IN FEET

CHECKED BY: RJK
 DATE: 12/30/04