

- 64 25'-12" SS (WM REQ) @ 1.00%
TBF = 1.8 CU YD
CLD PATCH = 3.0 SQ YD
- 65 47'-12" SS, CL. A, T-1 @ 1.00%
TBF = 0.1 CU YD
CLD PATCH = 25.8 SQ YD

FAA FILE	SECTION	COUNTY	TOTAL SHEETS	SHEET NO.
1346	*	COOK/DUPAGE	84	33

DRAINAGE & UTILITIES-TONNE RD. STA. 317+50 TO 320+50
 FED. ROAD DISTRICT NO. 7 ILLINOIS FED. AID PROJECT M-7003(B57)

*ELK GROVE VILLAGE SECTION 99-00041-00-CH
CONTRACT NO. 83766

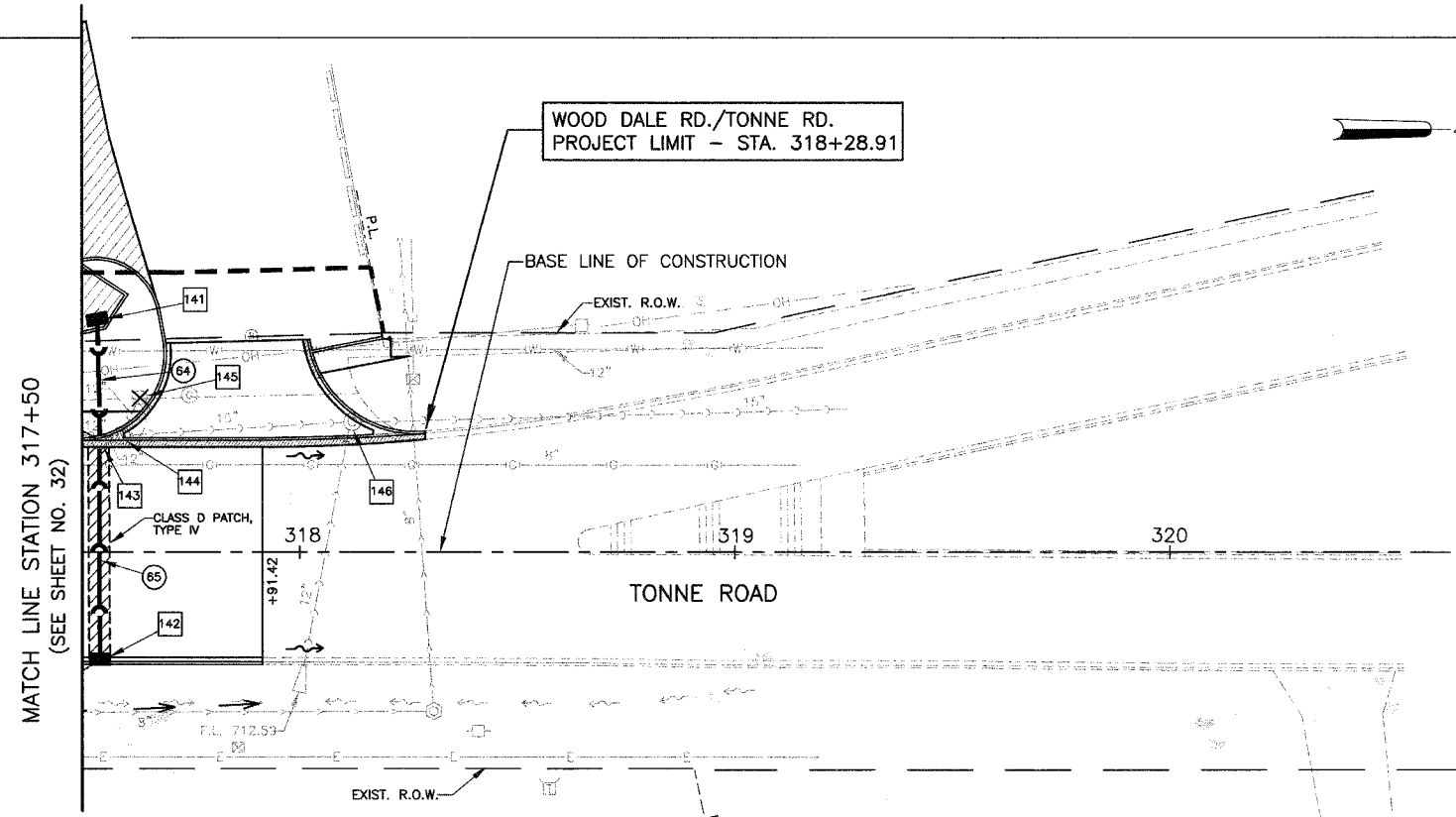

THE ENVIRONMENTAL FIRM IS REQUIRED TO CONTINUOUSLY MONITOR FOR WORKER SAFETY AND SOIL CONTAMINATION AT SEVERAL AREAS. SEE SPECIAL PROVISION FOR "NON-SPECIAL WASTE WORKING CONDITIONS" AND SUPPLEMENTAL SPECIFICATIONS FOR DETAILS.

SEE SHEET 38 FOR ADDITIONAL LEGEND

LEGEND

	PROPOSED DEPRESSED CURB
	CLASS D PATCH, TYPE III, 10"

- 141 STA. 317+54.0, 53.6'LT
INLET T-A, T-1F, O.L.
RIM = 714.92
INV = 712.59
- 142 STA. 317+54.0, 24.0'RT
INLET T-A, T-1F, O.L.
RIM = 715.88
INV = 713.23
- 143 STA. 317+54.1, 24.2'LT
ADJ. C.B. W/NEW T-23 FR & GR
EXIST. RIM = 715.59
PROP. RIM = 715.88
INV = 712.76(12"E)
INV = 712.34(12"W)
EX. INV = 712.24(12"NW)
- 144 STA. 317+59.0, 26.8'LT
ADJUST M.H.
EXIST. RIM = 715.54
PROP. RIM = 716.20
INV = 710.69(12"W)
EX. INV = 711.99(12"SE)
EX. INV = 710.69(12"S)
EX. INV = 710.44(15"N)
- 145 STA. 317+63.1, 35.4'LT
C.B. TO BE REMOVED
(SEAL OUTLET PIPE)
- 146 STA. 318+12.1, 29.8'LT
ADJUST M.H.
EXIST. RIM = 715.25
PROP. RIM = 715.30

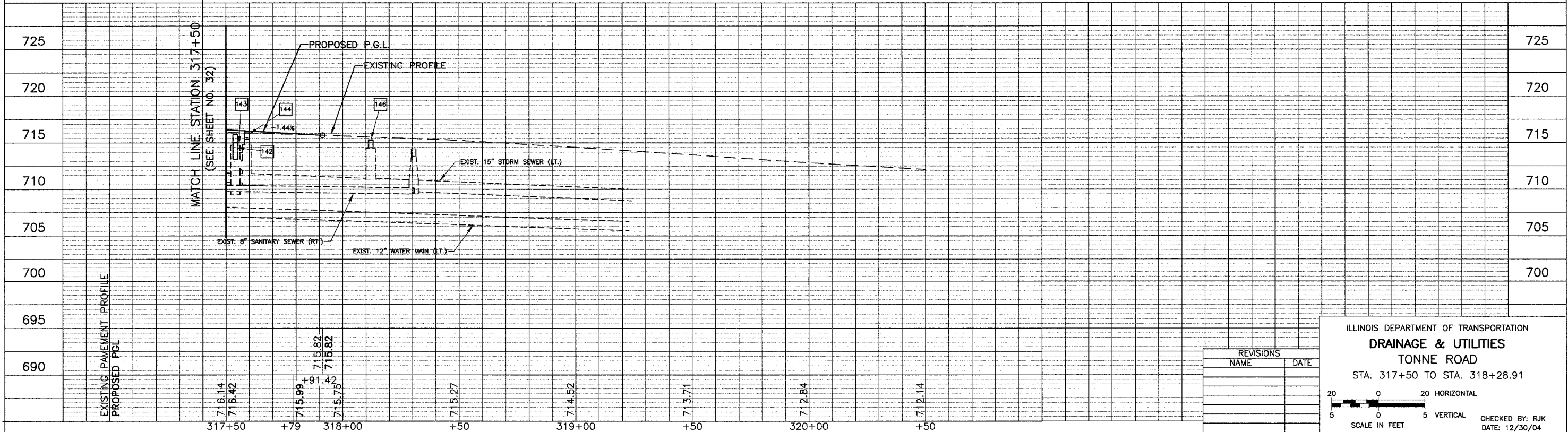

REVISIONS

NAME	DATE

ILLINOIS DEPARTMENT OF TRANSPORTATION

DRAINAGE & UTILITIES

TONNE ROAD

STA. 317+50 TO STA. 318+28.91

20 0 20 HORIZONTAL

5 0 5 VERTICAL

SCALE IN FEET

CHECKED BY: RJK
DATE: 12/30/04