

PLAN NO.	SECTION	COUNTY	TOTAL SHEETS	SHEET NO.
1346	*	COOK/DUPAGE	84	34
INTERSECTION PAVEMENT ELEVATIONS				
FED. ROAD DISTRICT NO. 7	ILLINOIS	FED. AID PROJECT M-7003(857)		

*ELK GROVE VILLAGE SECTION 99-00041-00-CH
CONTRACT NO. 83766

- LEGEND**
- XXX.XX ELEVATION OF TOP OF PROPOSED SURFACE COURSE
 - PROPOSED CATCH BASIN
 - PROPOSED INLET
 - XXX.XX TOP OF FRAME ELEVATION ON PROPOSED DRAINAGE STRUCTURE OR ELEVATION AT PROPOSED SUMMIT
 - DIRECTION OF GUTTER FLOW
 - - - - - EDGE OF EXIST. PAVEMENT TO REMAIN IN PLACE
 - — — — — BASE LINE OF CONSTRUCTION
 - - - - - PROPOSED PROFILE GRADE LINE

NOTE: ELEVATIONS ARE TYPICALLY SHOWN AT 25' INTERVALS (+00, +25, +50, +75).

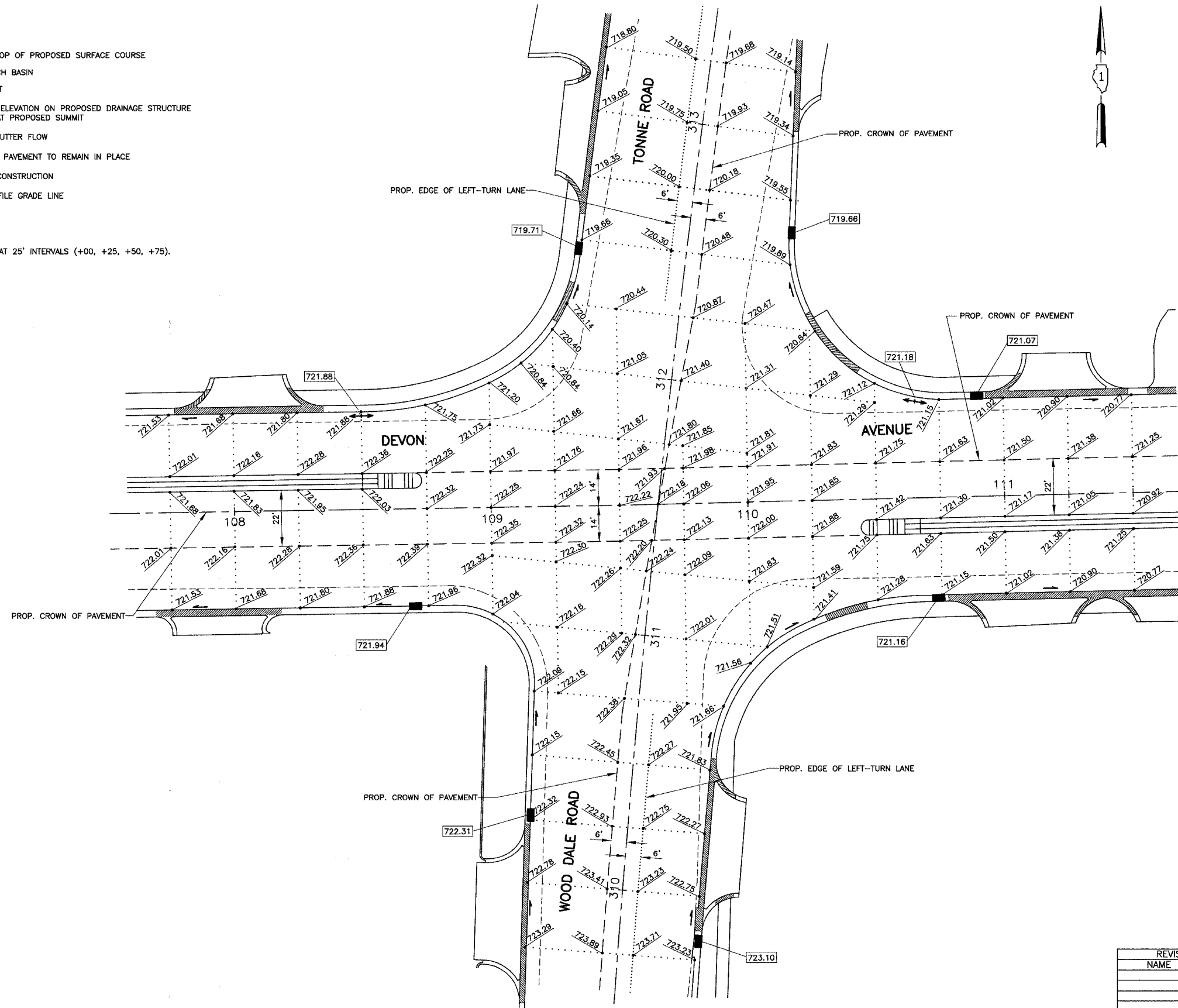

REVISIONS	
NAME	DATE

ILLINOIS DEPARTMENT OF TRANSPORTATION
INTERSECTION PAVEMENT ELEVATIONS
DEVON AVENUE @
WOOD DALE ROAD/TONNE ROAD

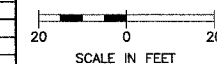

CHECKED BY: RJK
DATE: 12/30/04