

**RANDALL ROAD  
 C CURVE #2**

RADIUS = 9950.00'  
 ARC LENGTH = 232.66'  
 CHORD LENGTH = 116.33'  
 TANGENT LENGTH = 00'-34"-33"  
 MID ORDINATE = 0.68'  
 EXTERNAL SECANT = 0.68'  
 INCLUDED ANGLE = 01'-20"-23"  
 PC = 30+95.36  
 PT = 33+28.01

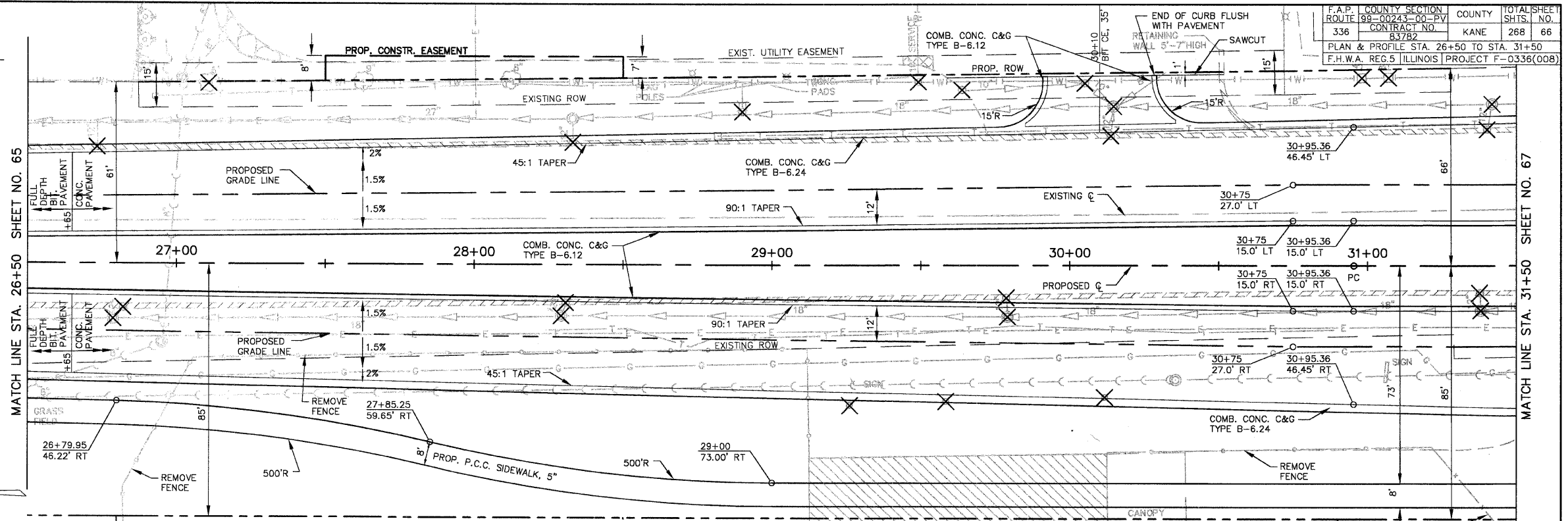

F.A.P. ROUTE	COUNTY SECTION	COUNTY	TOTAL SHEET
336	99-00243-00-PV	KANE	268
CONTRACT NO.	PROJECT NO.		
83782	F-0336(00B)		
PLAN & PROFILE STA. 26+50 TO STA. 31+50			
F.H.W.A. REG. 5 ILLINOIS PROJECT F-0336(00B)			

SCALE: 1" = 20'

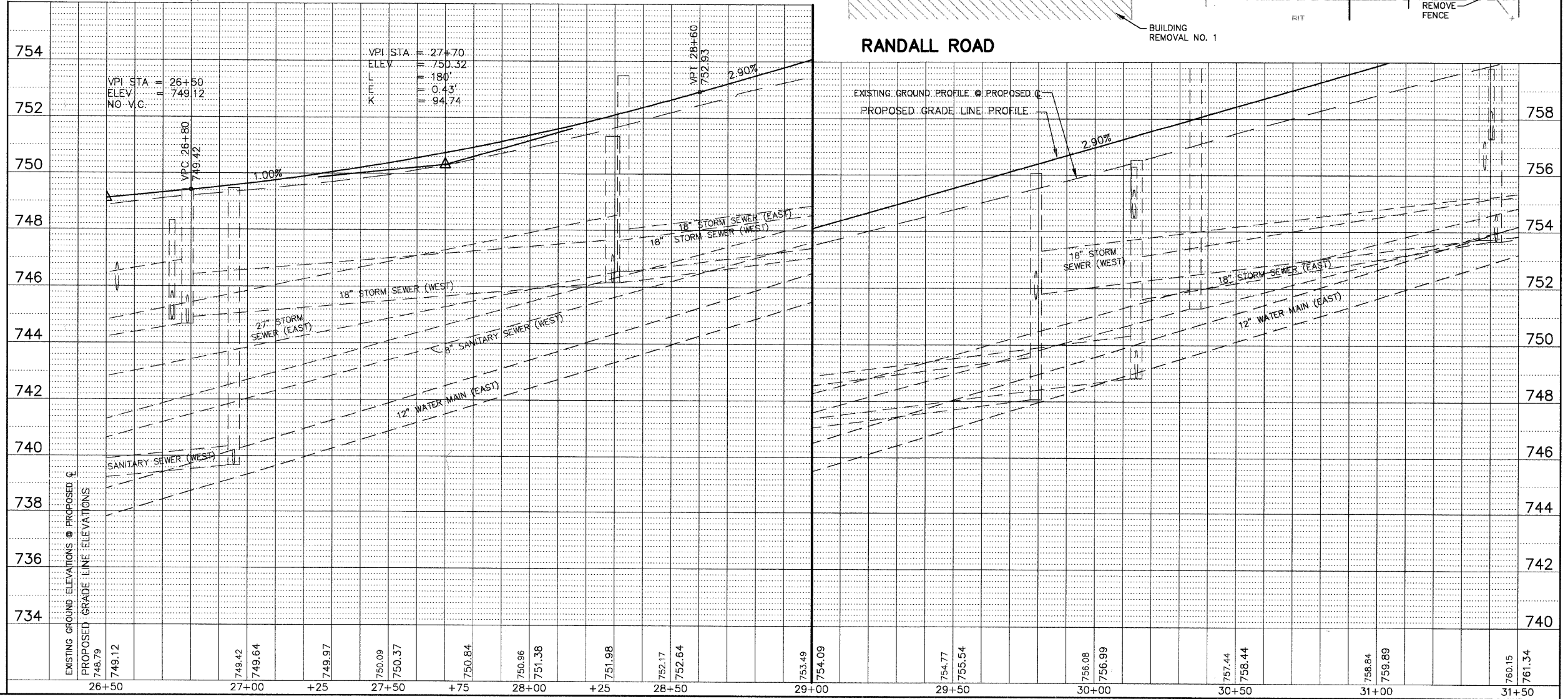

**RANDALL ROAD**

EXISTING GROUND ELEVATIONS @ PROPOSED C  
 PROPOSED GRADE LINE ELEVATIONS

748.79	749.12	749.42	749.64	749.97	750.09	750.37	750.84	750.96	751.38	751.98	752.17	752.64	753.49	754.09	754.77	755.54	756.08	756.99	757.44	758.44	758.84	759.89	760.15	761.34
26+50		27+00	+25	27+50	+75	28+00	+25	28+50		29+00		29+50		30+00		30+50		31+00		31+50				