

REL#	SECTION	COUNTY	TOTAL SHEETS	SHEET NO.
CH	A47	LAKE	176	39
STA.	13+00	TO STA.	18+00	
03-00088-00-FP	ELIROS	SURFACE TRANSPORTATION FUNDING		
CONTRACT NUMBER 83807				

CURVE #1
 $\Delta = 51^{\circ}07'29''$
 $D = 11^{\circ}00'39''$
 $R = 520.36'$
 $T = 248.89'$
 $L = 464.31'$
 $E = 56.46'$
 $PC STA. = 10+00.00$
 $PI STA. = 12+48.89$
 $PT STA. = 14+64.31$

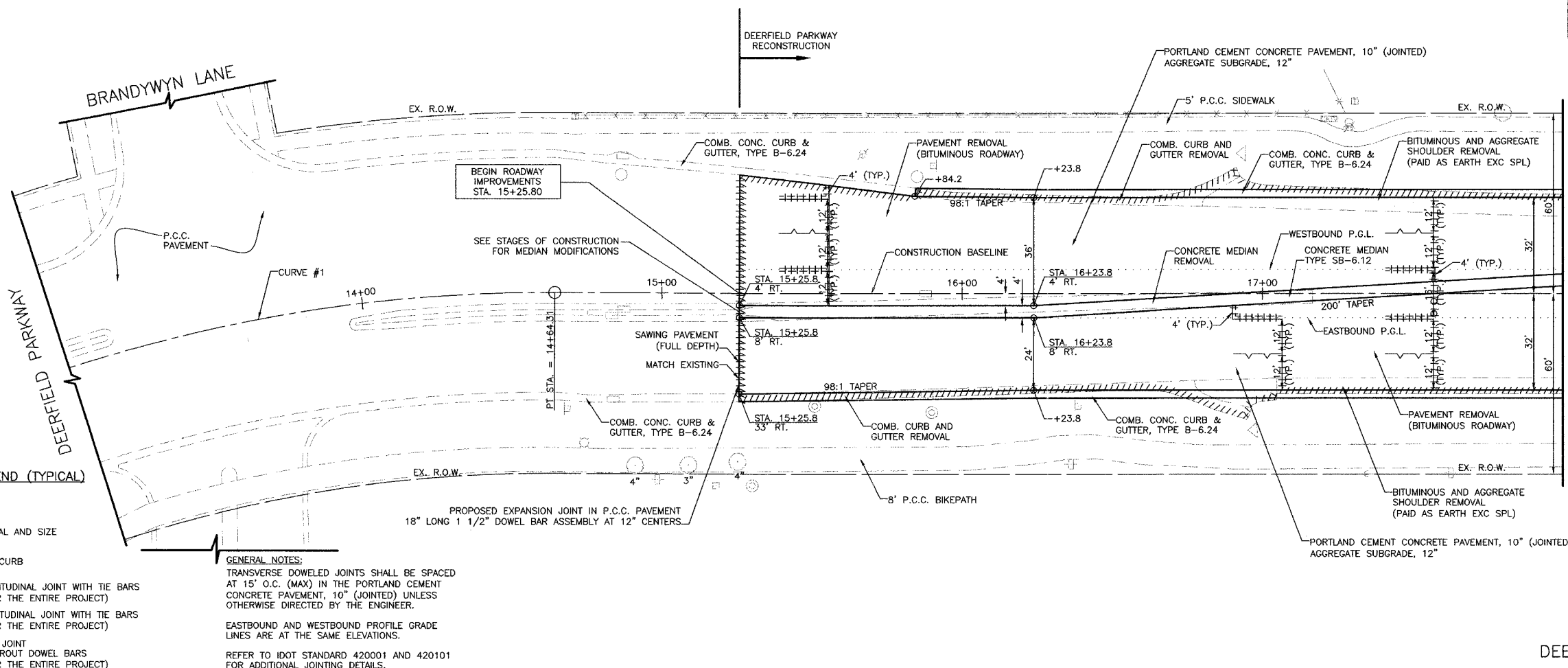

PLAN AND PROFILE LEGEND (TYPICAL)

- ////// REMOVAL
-
- DEPRESSED CURB
-
-
-

GENERAL NOTES:
 TRANSVERSE DOWELED JOINTS SHALL BE SPACED AT 15' O.C. (MAX) IN THE PORTLAND CEMENT CONCRETE PAVEMENT, 10" (JOINTED) UNLESS OTHERWISE DIRECTED BY THE ENGINEER.
 EASTBOUND AND WESTBOUND PROFILE GRADE LINES ARE AT THE SAME ELEVATIONS.
 REFER TO IDOT STANDARD 420001 AND 420101 FOR ADDITIONAL JOINTING DETAILS.

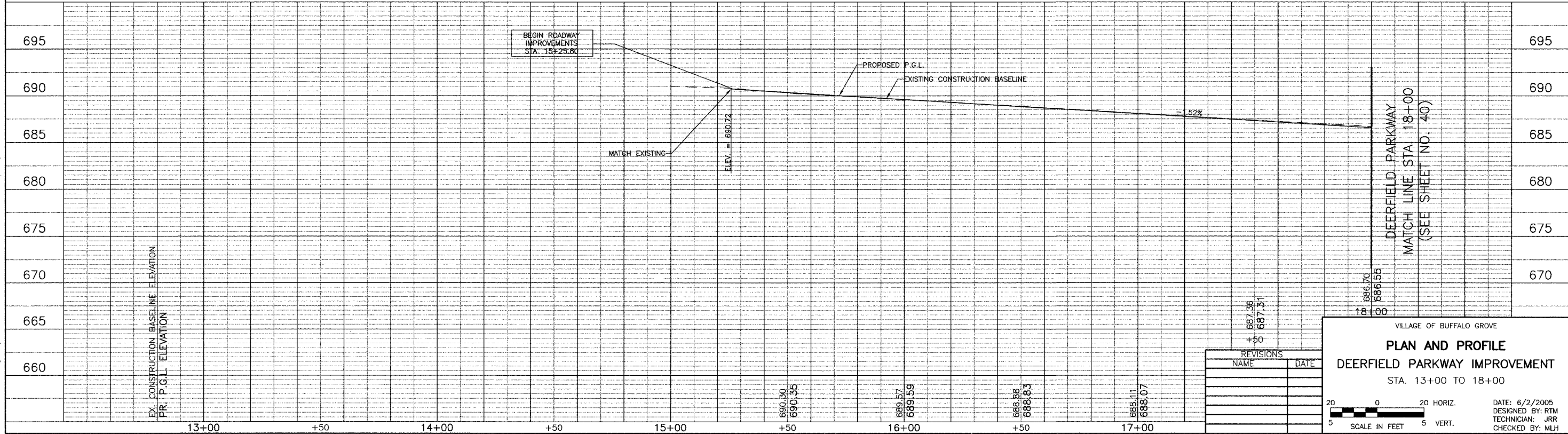

REVISIONS	
NAME	DATE

VILLAGE OF BUFFALO GROVE
PLAN AND PROFILE
DEERFIELD PARKWAY IMPROVEMENT
 STA. 13+00 TO 18+00

DATE: 6/2/2005
 DESIGNED BY: RTM
 TECHNICIAN: JRR
 CHECKED BY: MLH

BID SET