

REF.	SECTION	COUNTY	TOTAL SHEETS	SHEET NO.
CH	A47	LAKE	176	71
STA. 67+00		TO STA. 72+00		
03-00088-00-FP		SURFACE TRANSPORTATION FUNDING		
CONTRACT NUMBER 83807				

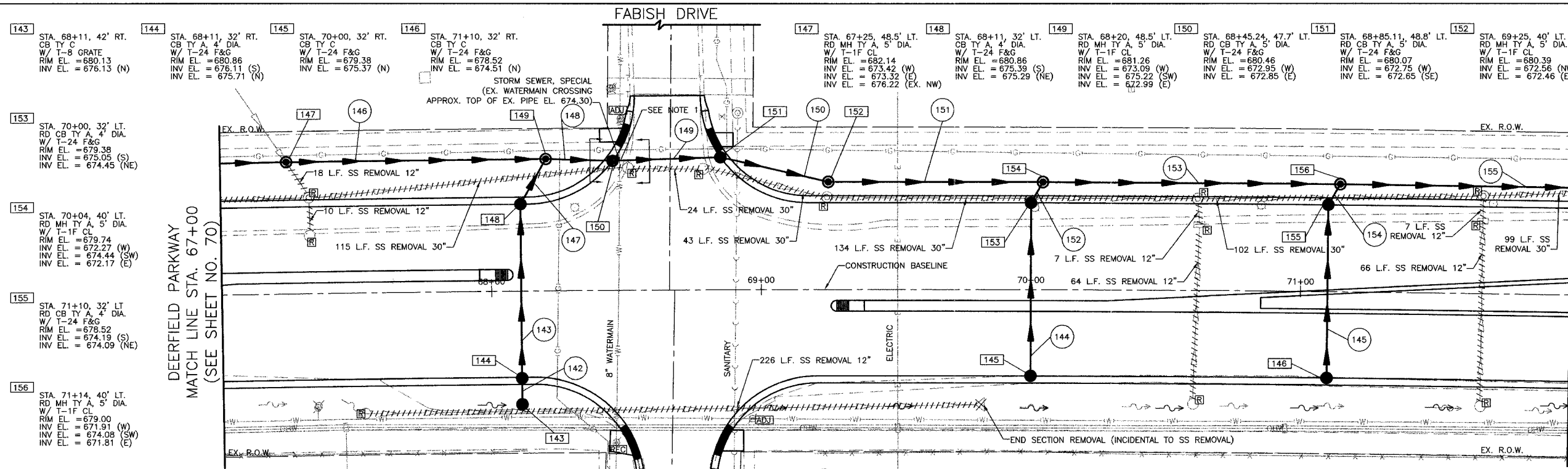

143 STA. 68+11, 42' RT. CB TY C W/T-8 GRATE RIM EL = 680.13 INV EL = 676.13 (N)

144 STA. 68+11, 32' RT. CB TY A, 4' DIA. W/T-24 F&G RIM EL = 680.86 INV EL = 676.11 (S) INV EL = 675.71 (N)

145 STA. 70+00, 32' RT. CB TY C W/T-24 F&G RIM EL = 679.38 INV EL = 675.37 (N)

146 STA. 71+10, 32' RT. CB TY C W/T-24 F&G RIM EL = 678.52 INV EL = 674.51 (N)

147 STA. 67+25, 48.5' LT. RD MH TY A, 5' DIA. W/T-1F CL RIM EL = 682.14 INV EL = 673.42 (W) INV EL = 673.32 (E) INV EL = 676.22 (EX. NW)

148 STA. 68+11, 32' LT. CB TY A, 4' DIA. W/T-24 F&G RIM EL = 680.86 INV EL = 675.39 (S) INV EL = 675.29 (NE)

149 STA. 68+20, 48.5' LT. RD MH TY A, 5' DIA. W/T-1F CL RIM EL = 681.26 INV EL = 673.09 (W) INV EL = 675.22 (SW) INV EL = 672.99 (E)

150 STA. 68+45.24, 47.7' LT. RD CB TY A, 5' DIA. W/T-24 F&G RIM EL = 680.46 INV EL = 672.95 (W) INV EL = 672.85 (E)

151 STA. 68+85.11, 48.8' LT. RD CB TY A, 5' DIA. W/T-24 F&G RIM EL = 680.07 INV EL = 672.75 (W) INV EL = 672.65 (SE)

152 STA. 69+25, 40' LT. RD MH TY A, 5' DIA. W/T-1F CL RIM EL = 680.39 INV EL = 672.56 (NW) INV EL = 672.46 (E)

153 STA. 70+00, 32' LT. RD CB TY A, 4' DIA. W/T-24 F&G RIM EL = 679.38 INV EL = 675.05 (S) INV EL = 674.45 (NE)

154 STA. 70+04, 40' LT. RD MH TY A, 5' DIA. W/T-1F CL RIM EL = 679.74 INV EL = 672.27 (W) INV EL = 674.44 (SW) INV EL = 672.17 (E)

155 STA. 71+10, 32' LT. RD CB TY A, 4' DIA. W/T-24 F&G RIM EL = 678.52 INV EL = 674.19 (S) INV EL = 674.09 (NE)

156 STA. 71+14, 40' LT. RD MH TY A, 5' DIA. W/T-1F CL RIM EL = 679.00 INV EL = 671.91 (W) INV EL = 674.08 (SW) INV EL = 671.81 (E)

- 142 5'-12" SS, CL. A, TY 2 @ 0.40% T.B.F. = 2 CU. YD.
- 143 64'-12" SS, CL. A, TY 2 @ 0.50% T.B.F. = 19 CU. YD.
- 144 64'-12" SS, CL. A, TY 2 @ 0.50% T.B.F. = 14 CU. YD.
- 145 64'-12" SS, CL. A, TY 1 @ 0.50% T.B.F. = 11 CU. YD.
- 146 91'-30" SS, CL. A, TY 2 @ 0.25%
- 147 14'-12" SS, CL. A, TY 2 @ 0.50% T.B.F. = 2 CU. YD.
- 148 12'-30" SS, CL. A, TY 2 @ 0.25% T.B.F. = 3 CU. YD.
- 149 28'-30" SS, CL. A, TY 2 @ 0.25% T.B.F. = 26 CU. YD.
- 150 34'-30" SS, CL. A, TY 2 @ 0.25% T.B.F. = 3 CU. YD.
- 151 75'-30" SS, CL. A, TY 2 @ 0.25%
- 152 2'-12" SS, CL. A, TY 2 @ 0.50% T.B.F. = 1 CU. YD.
- 153 105'-30" SS, CL. A, TY 2 @ 0.25%
- 154 2'-12" SS, CL. A, TY 2 @ 0.50% T.B.F. = 1 CU. YD.
- 155 105'-30" SS, CL. A, TY 2 @ 0.25%

NOTES:

1. THE 8" AND/OR 16" WATER MAINS SHALL BE RELOCATED IF A CONFLICT EXISTS WITH THE PROPOSED STORM SEWER.

*SEE FIRST DRAINAGE AND UTILITY SHEET FOR NOTES

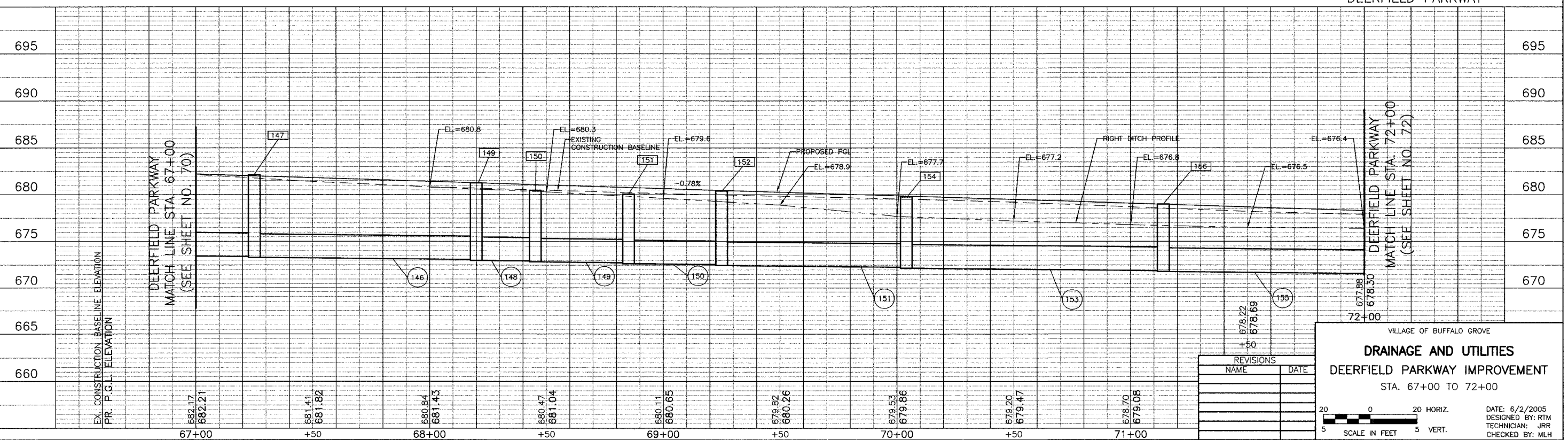

REVISIONS	
NAME	DATE

VILLAGE OF BUFFALO GROVE

DRAINAGE AND UTILITIES

DEERFIELD PARKWAY IMPROVEMENT

STA. 67+00 TO 72+00

DATE: 6/2/2005
 DESIGNED BY: RTM
 TECHNICIAN: JRR
 CHECKED BY: MLH

BID SET