

188	STA. 127+12.30, 28.3' RT. CB TY C W/T-24 F&G RIM EL. = 681.67 INV EL. = 677.45 (SE)	189	STA. 128+62.61, 25.4' RT. CB TY C W/T-24 F&G RIM EL. = 682.25 INV EL. = 678.89 (EX. W)	190	STA. 130+22.31, 21.8' RT. RD CB TY A, 4' DIA. W/T-24 F&G RIM EL. = 683.04 INV EL. = 679.53 (EX. W) INV EL. = 679.98 (N)	191	STA. 127+06.33, 28.8' LT. CB TY C W/T-24 F&G RIM EL. = 681.66 INV EL. = 678.42 (EX. SE)	192	STA. 128+61.88, 25.4' LT. CB TY C W/T-24 F&G RIM EL. = 682.20 INV EL. = 678.92 (W) INV EL. = 678.90 (EX. E)	193	STA. 130+22.54, 21.8' LT. RD CB TY A, 4' DIA. W/T-24 F&G RIM EL. = 682.94 INV EL. = 679.68 (W) INV EL. = 679.57 (EX. E) INV EL. = 679.98 (N)	193A	STA. 131+06, 32.0' LT. CB TY C W/T-8 GRATE RIM EL. = 683.00 INV EL. = 680.79	193B	STA. 131+66, 32.0' RT. CB TY C W/T-8 GRATE RIM EL. = 683.00 INV EL. = 680.79
-----	---	-----	--	-----	--	-----	---	-----	--	-----	--	------	--	------	--

FILE #	SECTION	COUNTY	TOTAL SHEETS	SHEET NO
CH	A47	LAKE	176	76
STA. 127+00		TO STA. 132+50		
03-00088-00-PP		ILLINOIS		SURFACE TRANSPORTATION FUNDING
CONTRACT NUMBER 83807				

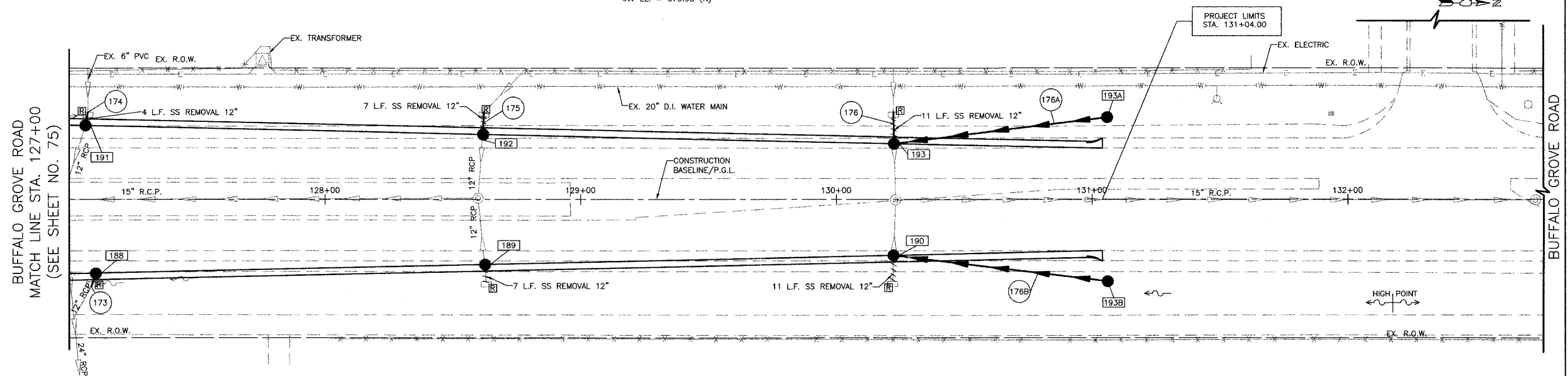

- 173 4'-12" SS, CL. A, TY 1 @ 4.10%
T.B.F. = 1 CU. YD.
- 174 4'-6" PVC SS, CL. B, TY 1 @ 0.20%
T.B.F. = 1 CU. YD.
- 175 7'-6" PVC SS, CL. B, TY 1 @ 0.50%
T.B.F. = 1 CU. YD.
- 176 10'-6" PVC SS, CL. B, TY 1 @ 0.50%
T.B.F. = 2 CU. YD.
- 176A 81'-12" SS, CL. A, TY 1 @ 1.00%
T.B.F. = 3 CU. YD.
- 176B 81'-12" SS, CL. A, TY 1 @ 1.00%
T.B.F. = 3 CU. YD.

*SEE FIRST DRAINAGE AND UTILITY SHEET FOR NOTES

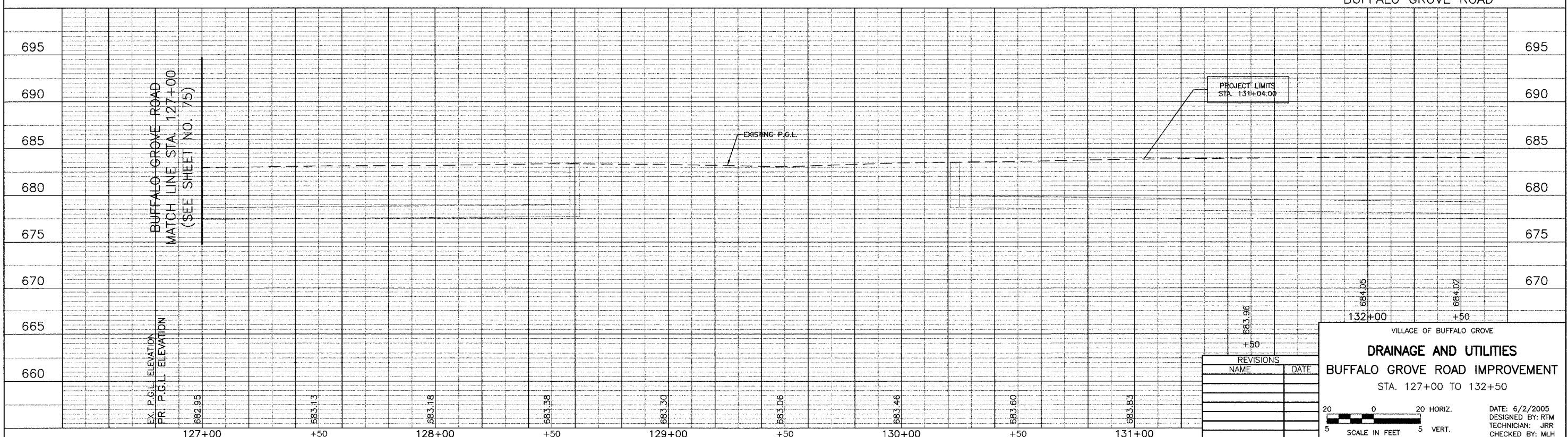

REVISIONS	
NAME	DATE

VILLAGE OF BUFFALO GROVE
DRAINAGE AND UTILITIES
 BUFFALO GROVE ROAD IMPROVEMENT
 STA. 127+00 TO 132+50

DATE: 6/2/2005
 DESIGNED BY: RTM
 TECHNICIAN: JRR
 CHECKED BY: MLH

20 0 20 HORIZ.
 5 SCALE IN FEET 5 VERT.

BID SET